

R. 33. E.W.M.

R. 34. E.W.M.

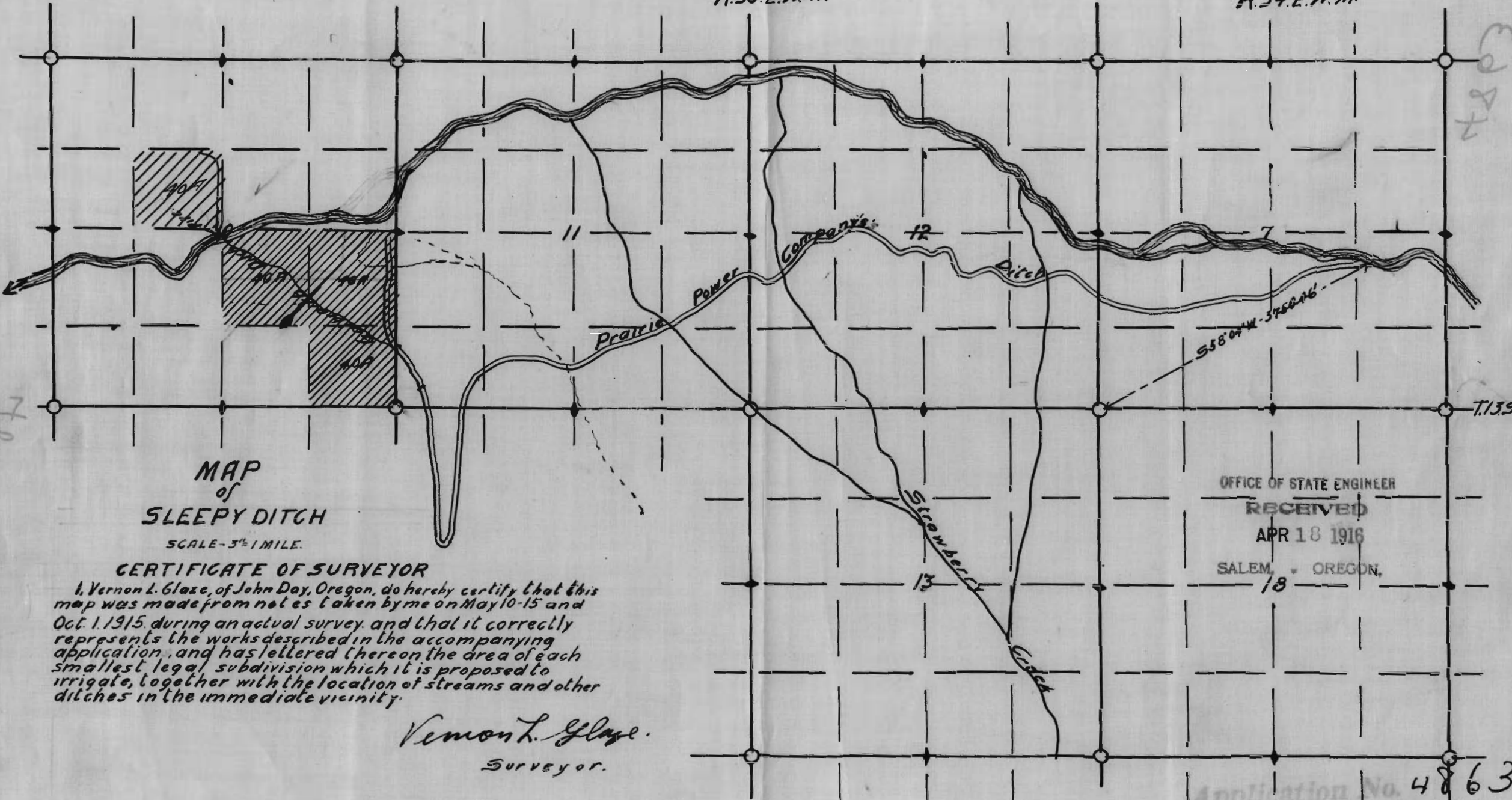

**MAP
of
SLEEPY DITCH**

SCALE - 3" = 1 MILE.

CERTIFICATE OF SURVEYOR

I, Vernon L. Glaze, of John Day, Oregon, do hereby certify that this map was made from notes taken by me on May 10-15 and Oct. 1, 1915, during an actual survey, and that it correctly represents the works described in the accompanying application, and has lettered thereon the area of each smallest legal subdivision which it is proposed to irrigate, together with the location of streams and other ditches in the immediate vicinity.

Vernon L. Glaze.
Surveyor.

OFFICE OF STATE ENGINEER

RECEIVED

APR 18 1916

SALEM, OREGON,

18

Application No. 4863
Permit No. 2892