

RECEIVED

APR 26 1916

SALEM, OREGON

Township 6 North of,

Range 35 E.W.M.

Application No. 4802
Permit No. 2898

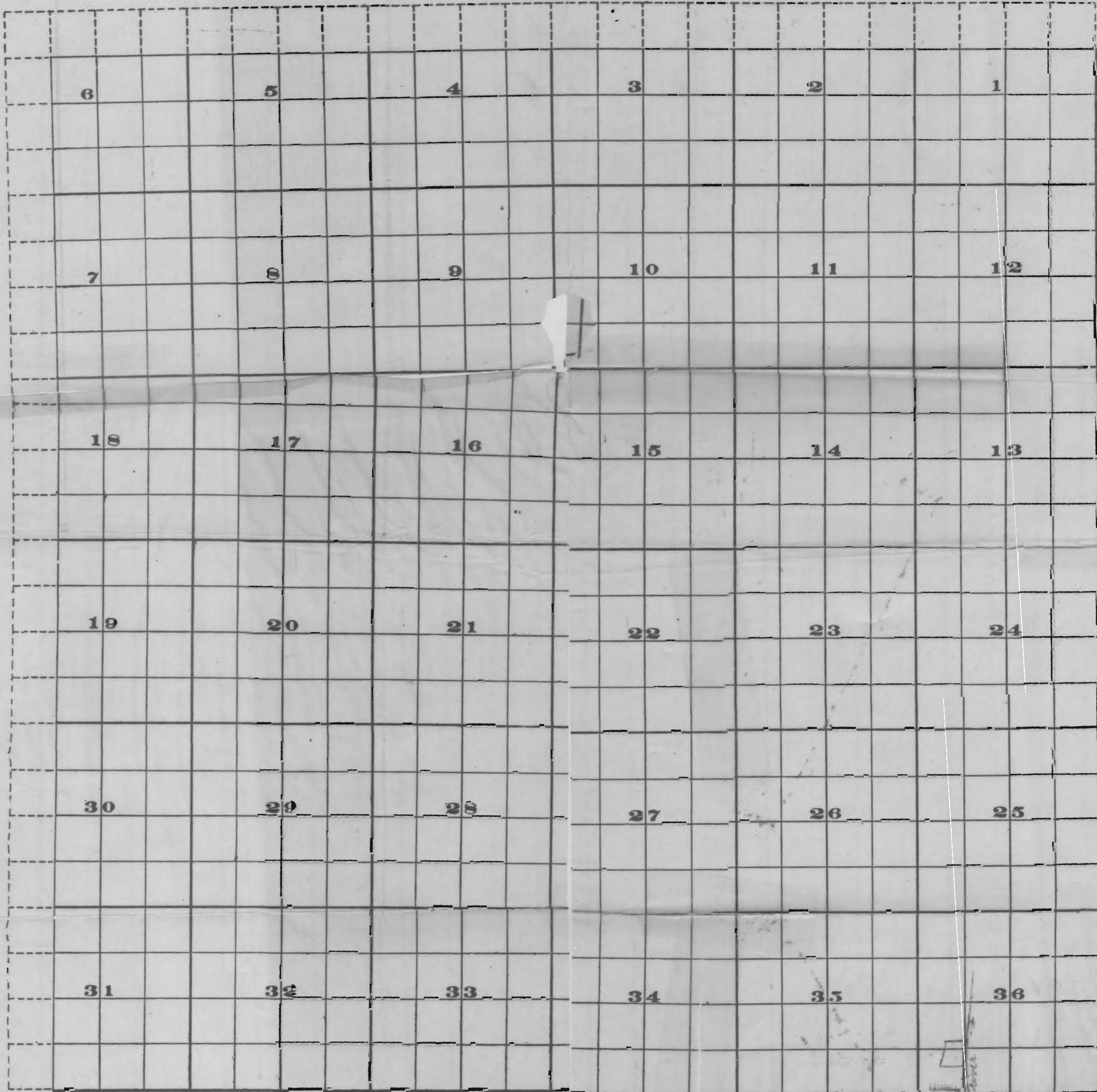

4802

App 4802
P. 2898

6 N. R 35 E

Sec 36



Scale of Feet.

FROM OFFICE OF THE STATE ENGINEER, SALEM, OREGON



4805