

ROSEBURG LUMBER CO.

SECTIONS 33 & 34, T.28S, R.6W., W.M.
DOUGLAS COUNTY, OREGON.
SCALE 1" = 500'

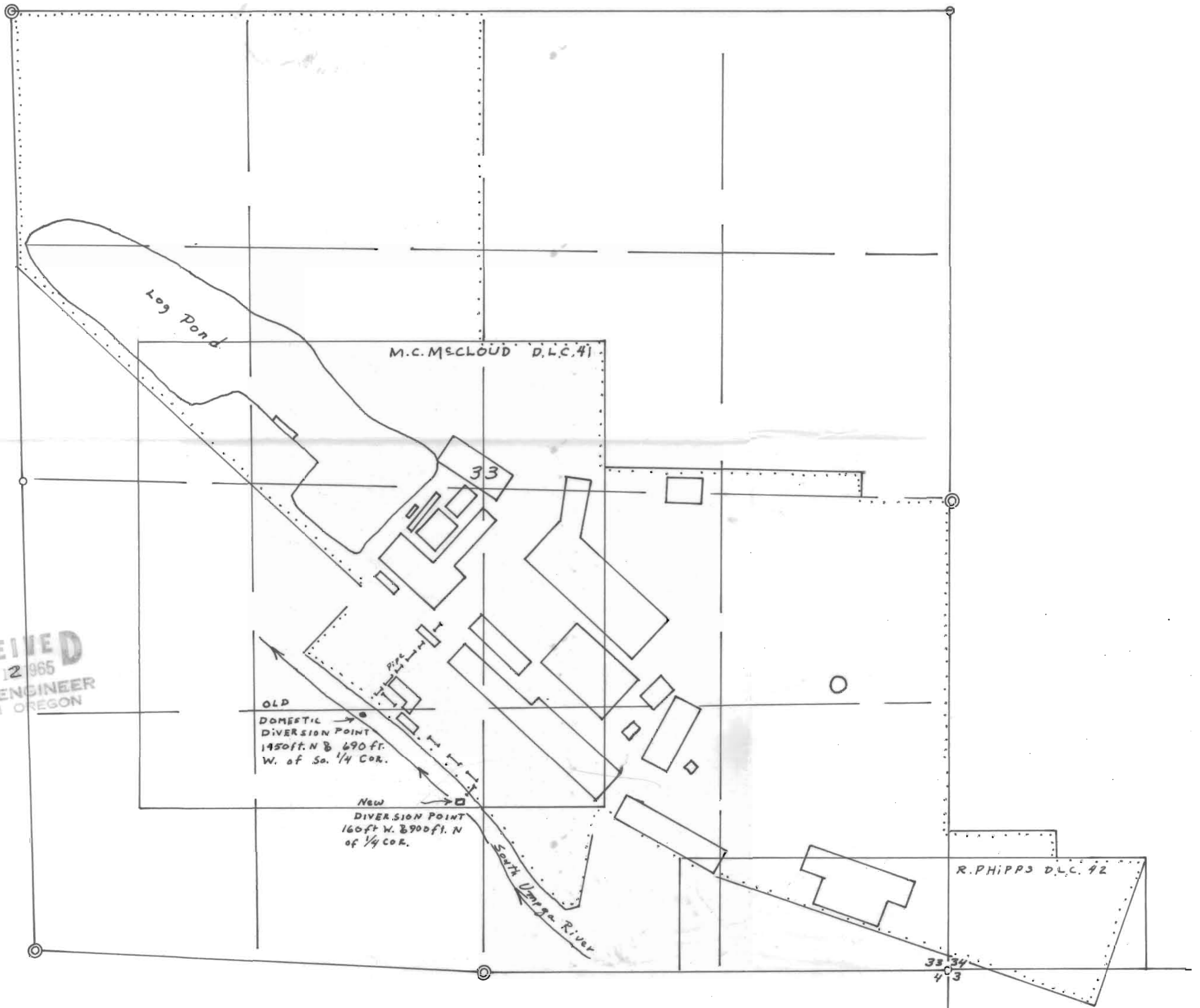

RECEIVED
NOV 12 1965
STATE ENGINEER
SALEM OREGON

33 34
4 3

ROSEBURG LUMBER CO.

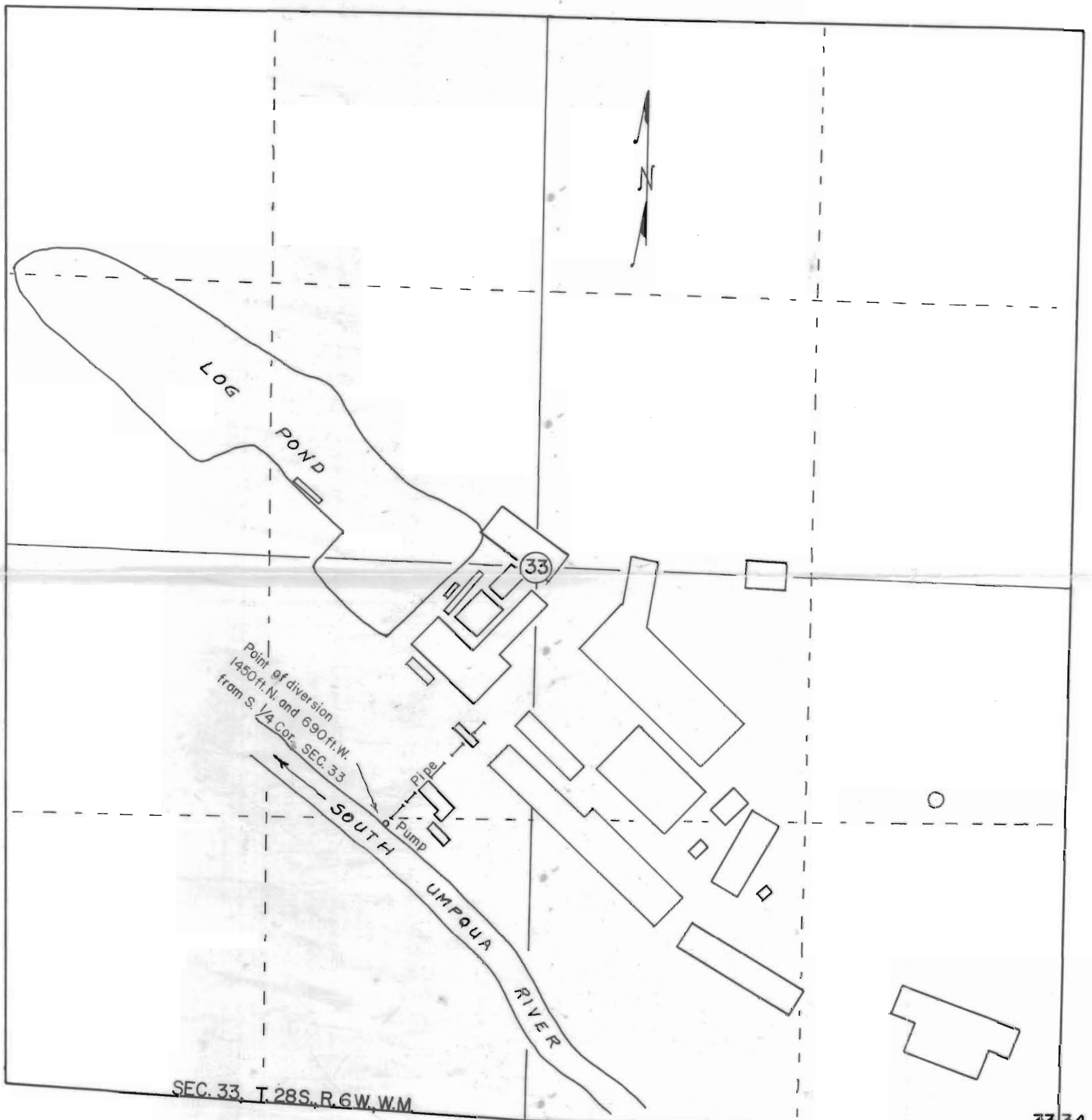

SEC. 33, T. 28S., R. 6W., W.M.

MAP

To accompany application for permit to appropriate water

Application No. 39241
Permit No. 29194

Scale: 1 in. = 500 ft.

3334
4 | 3