

25 p X

OFFICE OF STATE ENGINEER
RECEIVED
MAY 25 1916
SALEM, OREGON,

Township 38 South, Range 5 West W.M.

Application No. 4926
Permit No. 2938

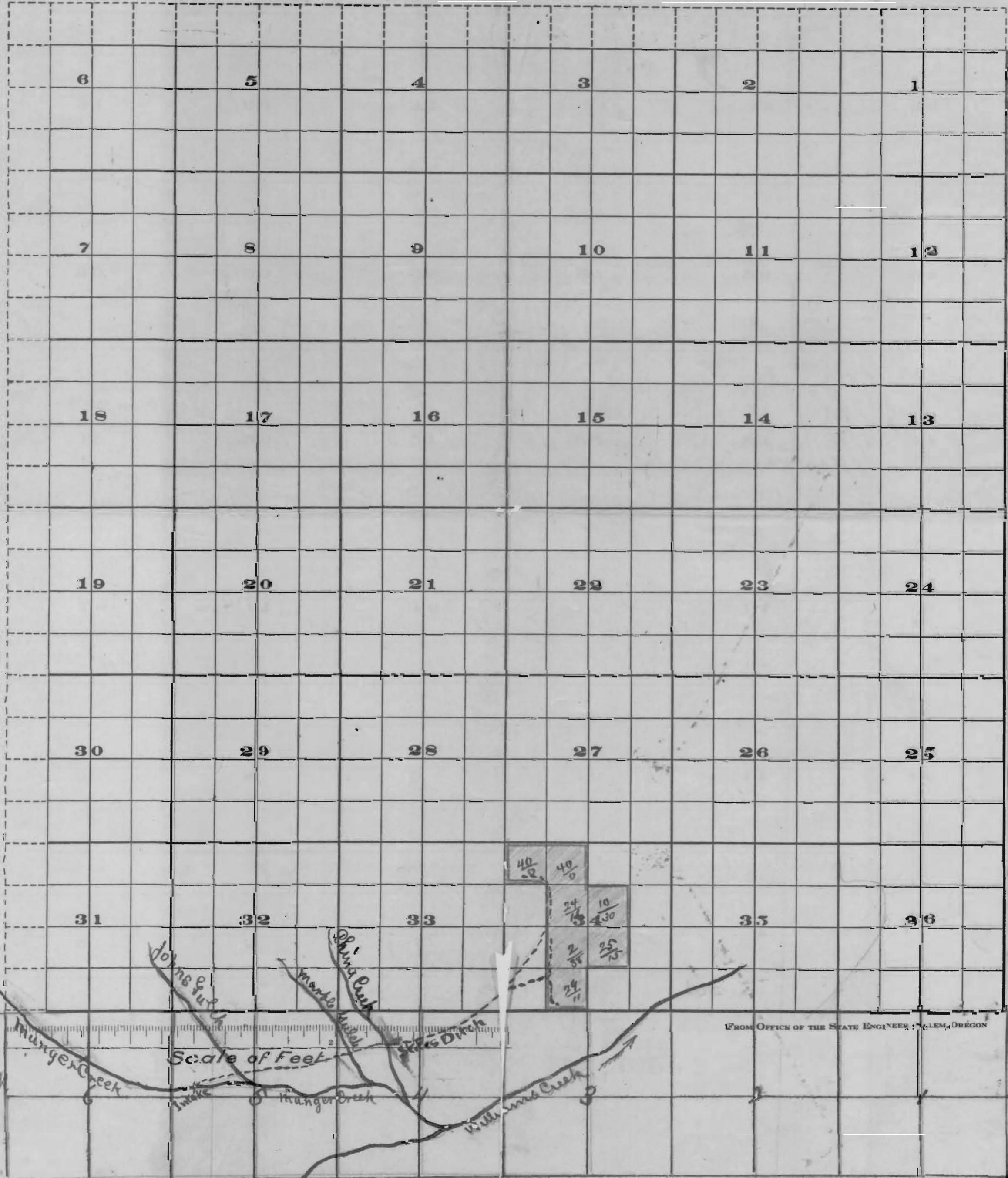

FROM OFFICE OF THE STATE ENGINEER, SALEM, OREGON

Sp. 39 South
Range 5 West W.M.

25 p X