

MAP

Accompanying application of L. N. STEVENS to appropriate the waters of Creek (unknown) tributary of Evans Creek, Jackson Co, Oregon.

May 20<sup>th</sup> 1916.

Fred. N. Cummings. C.E.

Tp 35.S.R.3.W.W.M.

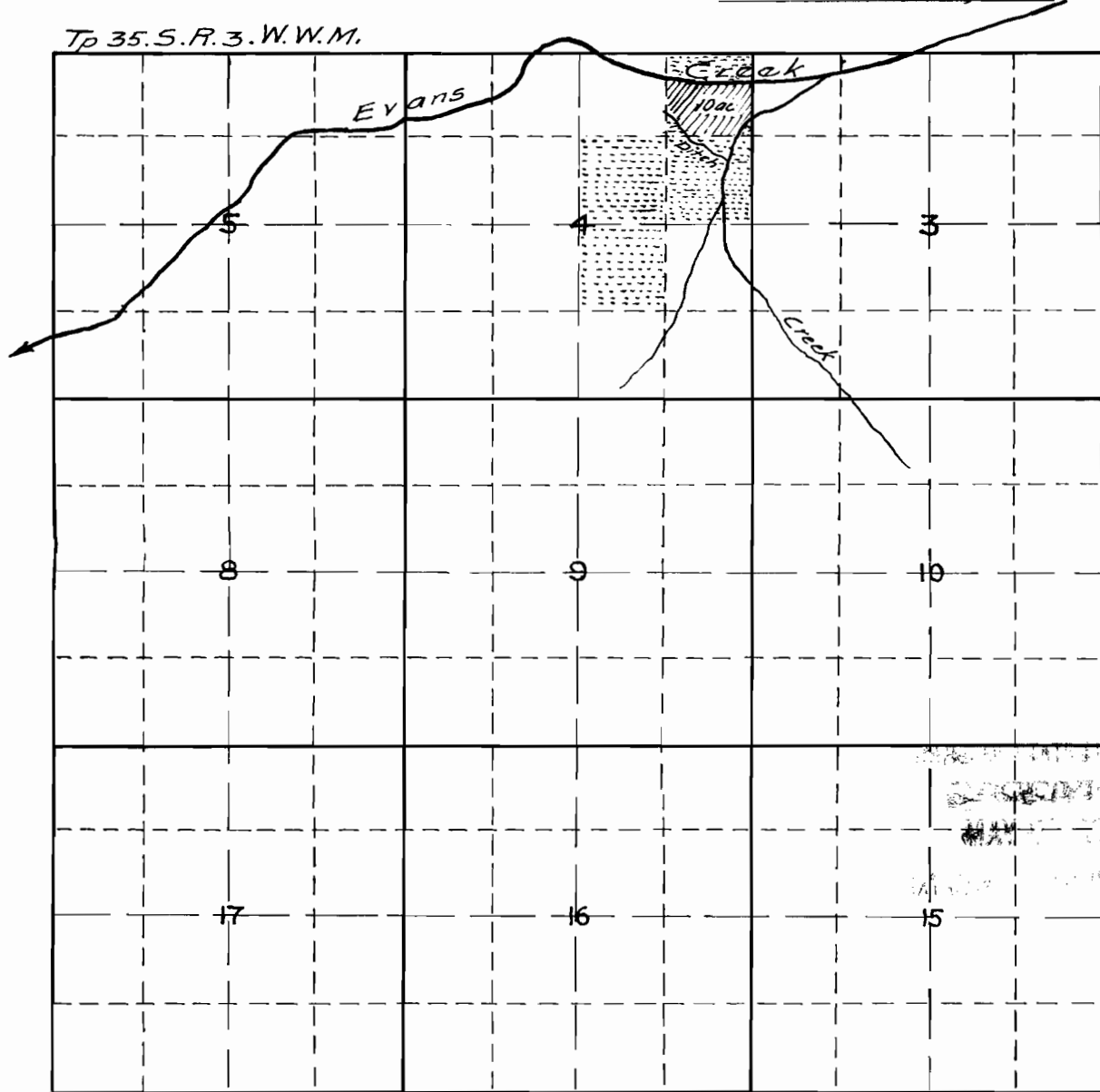

493  
2939

Map made from notes furnished by Mr L. N. Stevens of location of his ditch, and Creek through his lands.

- Land to be irrigated
- ███ Lands owned by Mr Stevens.

Fred. N. Cummings, C.E.  
Medford, Oregon.