

— MAP —

— Accompanying application of LOUIS A. SALADE for Permit
to appropriate the waters of Jackson Creek tributary
to Bear Creek tributary to Roque River, Jackson
County, Oregon.

May 30th 1916.

Fred. N. Cummings. C.E.

T.P. 36. S.R. 2.W.W.M

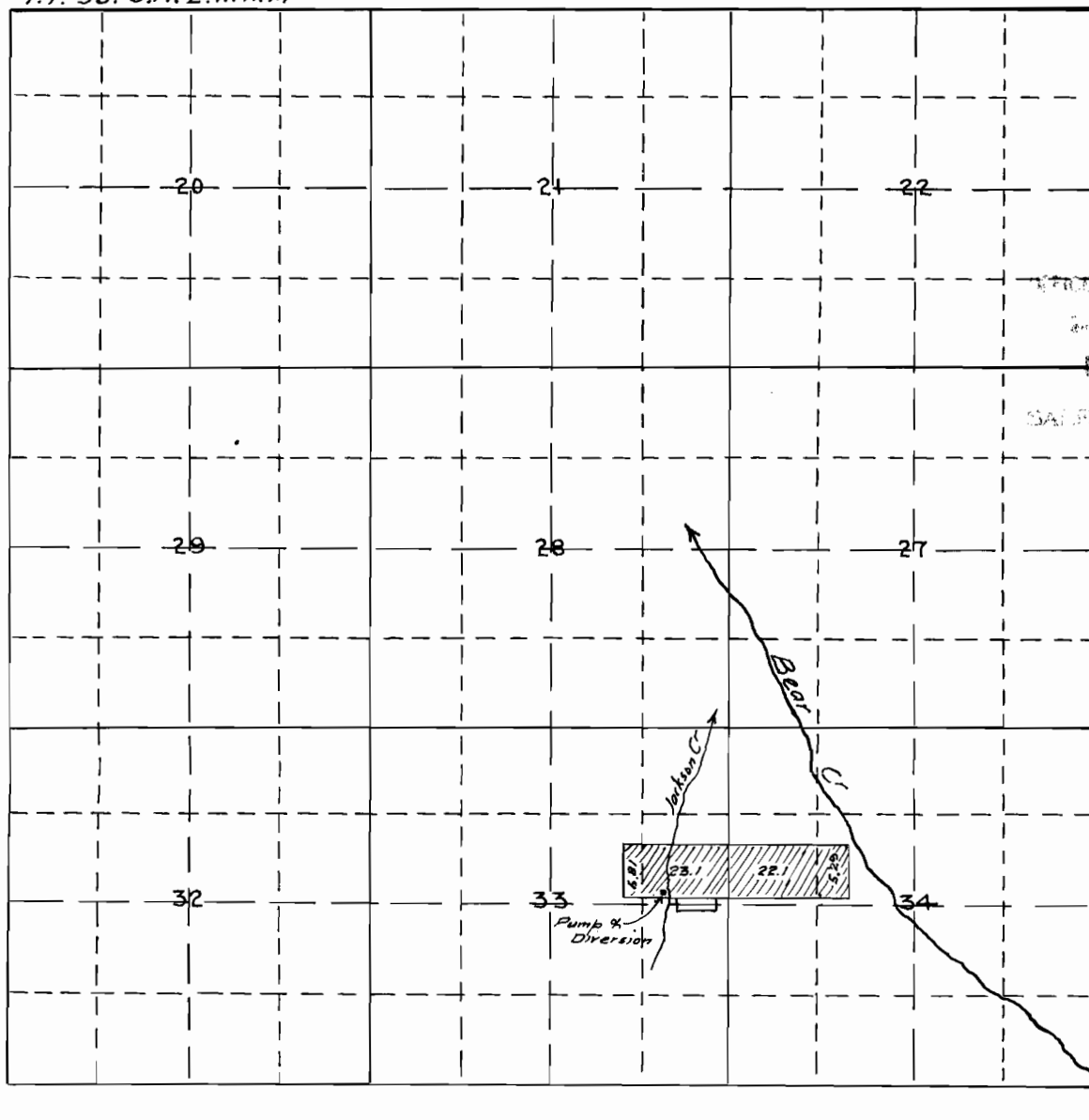

— Map made from plat of Lands owned by Louis. A. Salade —

Fred. N. Cummings

Medford, Oregon.

4888
2941