

— MAP —

— Accompanying application of R. HOLZGANG for permit to appropriate the waters of Bishop creek tributary to Rogue River. Jackson County, Oregon. —

— June 24<sup>th</sup> 1916. —

— Fred. N. Cummings. C.E. —

T38.S.R.3.W.W.M.

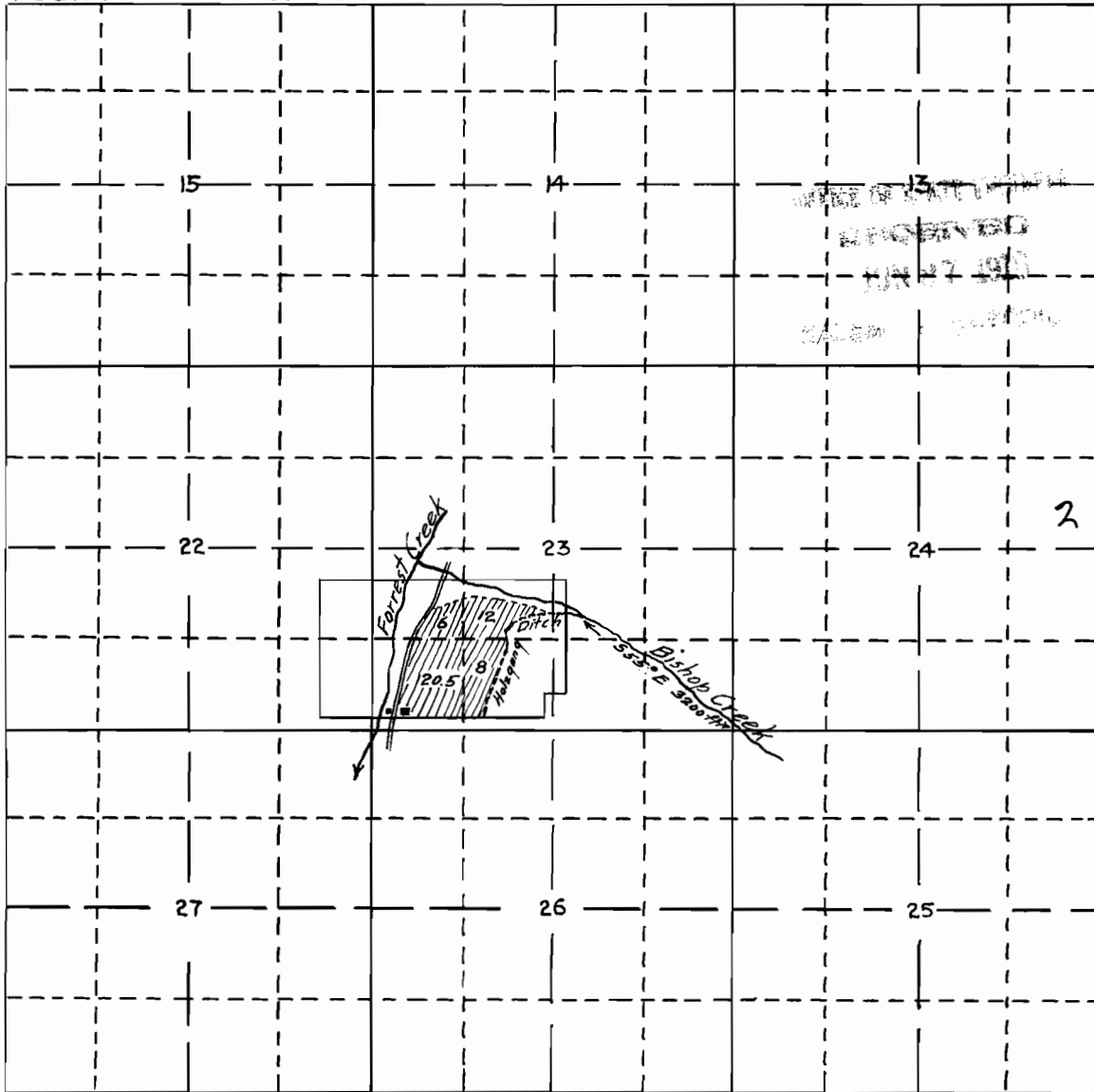

— Map made from plat of survey of Lands of Mr R. Holzgang and irrigable area furnished by Mr Holzgang —

— Fred. N. Cummings. C.E. —  
— Medford. Oregon. —