

OFFICE OF STATE ENGINEER
RECEIVED
MAY 6 1916
SALEM, OREGON

7222

Township 38 South,

Range range 4 west

with annex to Medicine

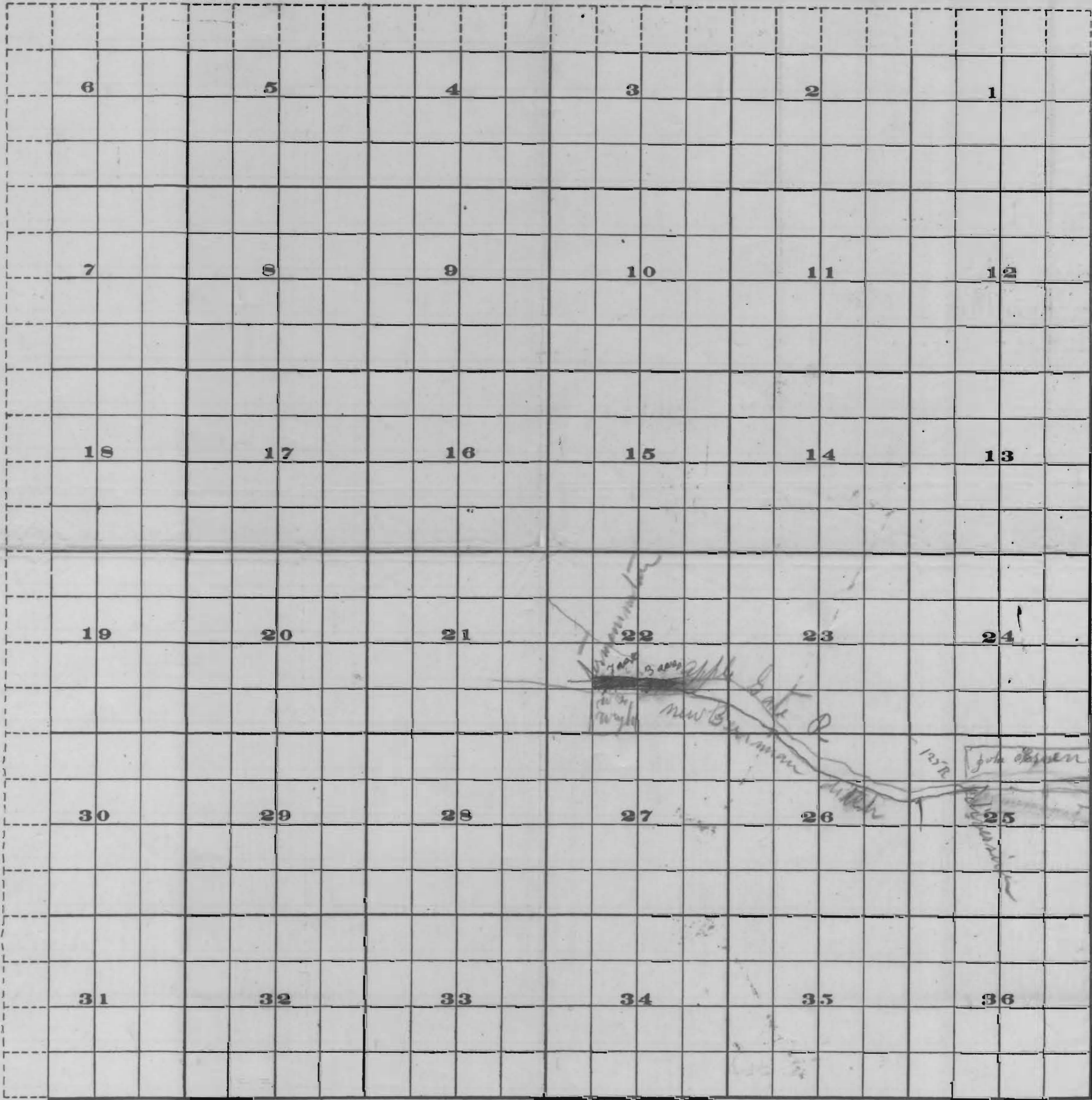

7222

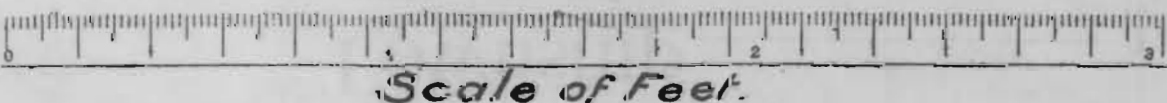

FROM OFFICE OF THE STATE ENGINEER, SALEM, OREGON

OFFICE OF STATE ENGINEER
RECEIVED
MAY 6 1916
SALEM, OREGON

4895
2984

7222