

Irrigation from River by means of stationary pumping plant and permanent pipe line.  
 Pump site  $70^{\circ} 20' W$ , 1180 ft. from NE cor of Sec. 10, T2N, R30EWM.  
 Acreage to be irrigated consists of 11.5 acres  $NE\frac{1}{4}NE\frac{1}{4}$  and 6.0 acres  $NW\frac{1}{4}NE\frac{1}{4}$  Sec. 10 and also 8.0 acres  $NW\frac{1}{4}NW\frac{1}{4}$  Sec. 11, All in T2N, R30EWM.

ALL IN T2N R30E. W.M.  
 1" = 1000'

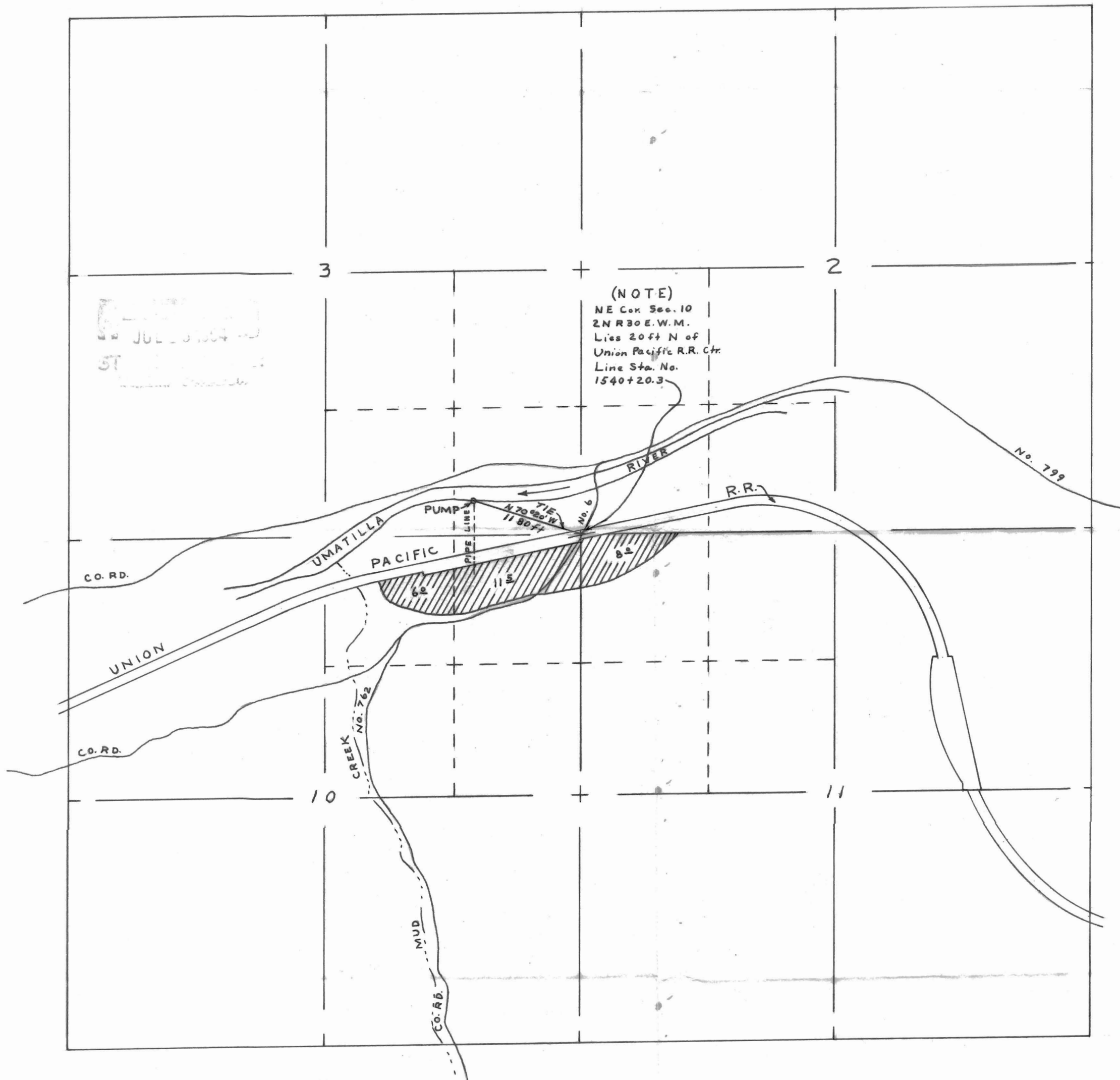

Application No. 40076  
 Permit No. 29867