

RECEIVED  
JUL 23 1964

STATE ENGINEER  
SALESMAN

# Amended Map of SOUTH FLORENCE ADDITION to GLENADA.

SCALE: 200ft to 1 inch.

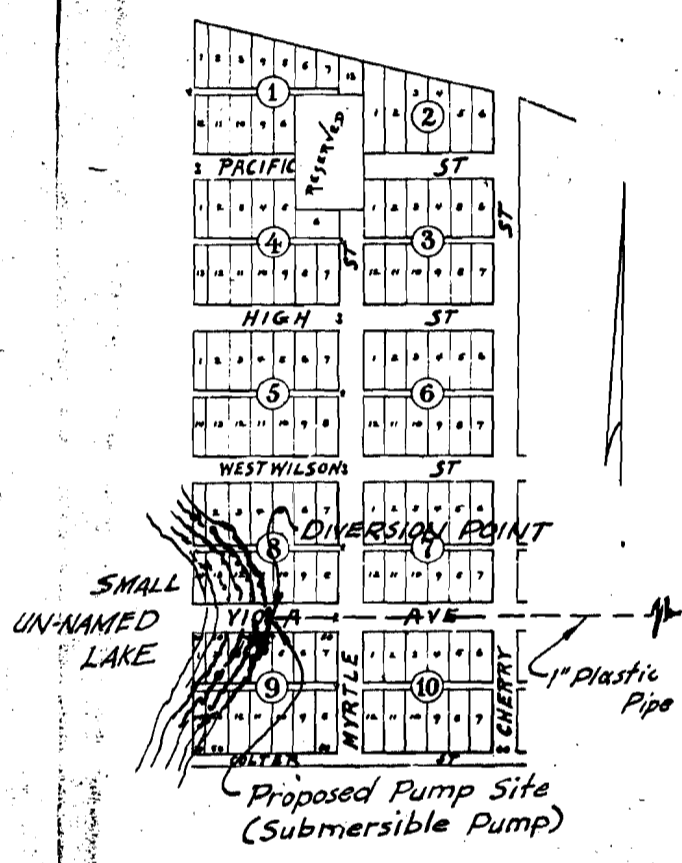

We George H. Barrett, H. H. Barrett and George H. Colter do hereby dedicate to the Public all the Streets and Alleys in the Amended Map of South Florence Addition to Glenada.

Witness: George H. Barrett (Seal)  
R. B. Mills H. H. Barrett (Seal)  
A. R. Buttalph. George H. Colter (Seal)  
State of Oregon }  
County of Lane } S.S.

On the 2<sup>nd</sup> day of May 1892 personally came before me a Notary Public in and for said County, George H. Barrett, H. H. Barrett and George H. Colter to me personally known to be the identical persons described in and who executed the within instrument and acknowledged to me that they executed the same freely and voluntarily for the uses and purposes therein named.

Witness my hand and seal this 2<sup>nd</sup> day of May 1892.  
A. R. Buttalph  
Notary Public.

(Seal)  
State of Oregon  
County of Lane } S.S.

I hereby certify that the within instrument was filed for record this 12 day of May 1892 and duly recorded in Book 2 page 18 Lane County Plat Records.

W. R. Walker  
County Clerk.

Application No. 40114  
Permit No. 29907

RECEIVED  
JUL 23 1964  
STATE ENGINEER  
WALTHAM, MASS.



The Town of Glen Ada a portion of which was  
formerly recorded under the name of South  
Bend, is situated in Town of 34 & 35 & 18  
& 12 N. from N.W. cor. of Block 7 the location  
Corner to Tract, Secs 34 & 35 on left Bank of the  
Siuslaw River about N. 82° E. 39' ft. dist  
starts on the border on each 60 ft wide  
Vida Avenue is 70 ft wide; all other  
streets are 60 ft wide; all alleys  
are 10 ft wide.  
Recorded July 25<sup>th</sup> 1889  
J. H. Davis Geo. L. L. C.

4 - Rider St. - Marker 155634 W  
4 - Lots Block 15 See 2897 Map 16-532

1 - Location of Alley - Maps  
See Book 374 Page 102  
Lone Groby Drive  
E - Vacation Court  
Book 374 - 435  
3 - 1/2" Pipe Line at 200 ft. (1/2")  
1 - 1/2" Pipe Line at 200 ft. (1/2")

N 0° 11' 54" W 35.00' ±  
5.89° 48' 06" W 137.2' ±  
from N.W. cor. Block 15  
DIVERSION POINT  
2.581 36' pin  
5.89° 48' 06" W 76.0' ±  
1" Plastic  
Pipe Line

Application No. 40114  
Permit No. 29907