

MAP



Accompanying application of Gold Crest Fruit Co for permit to appropriate the waters of Galls Creek tributary to Rogue River. Jackson County, Oregon.

May 26th 1916

Fred N. Cummings. C.E.

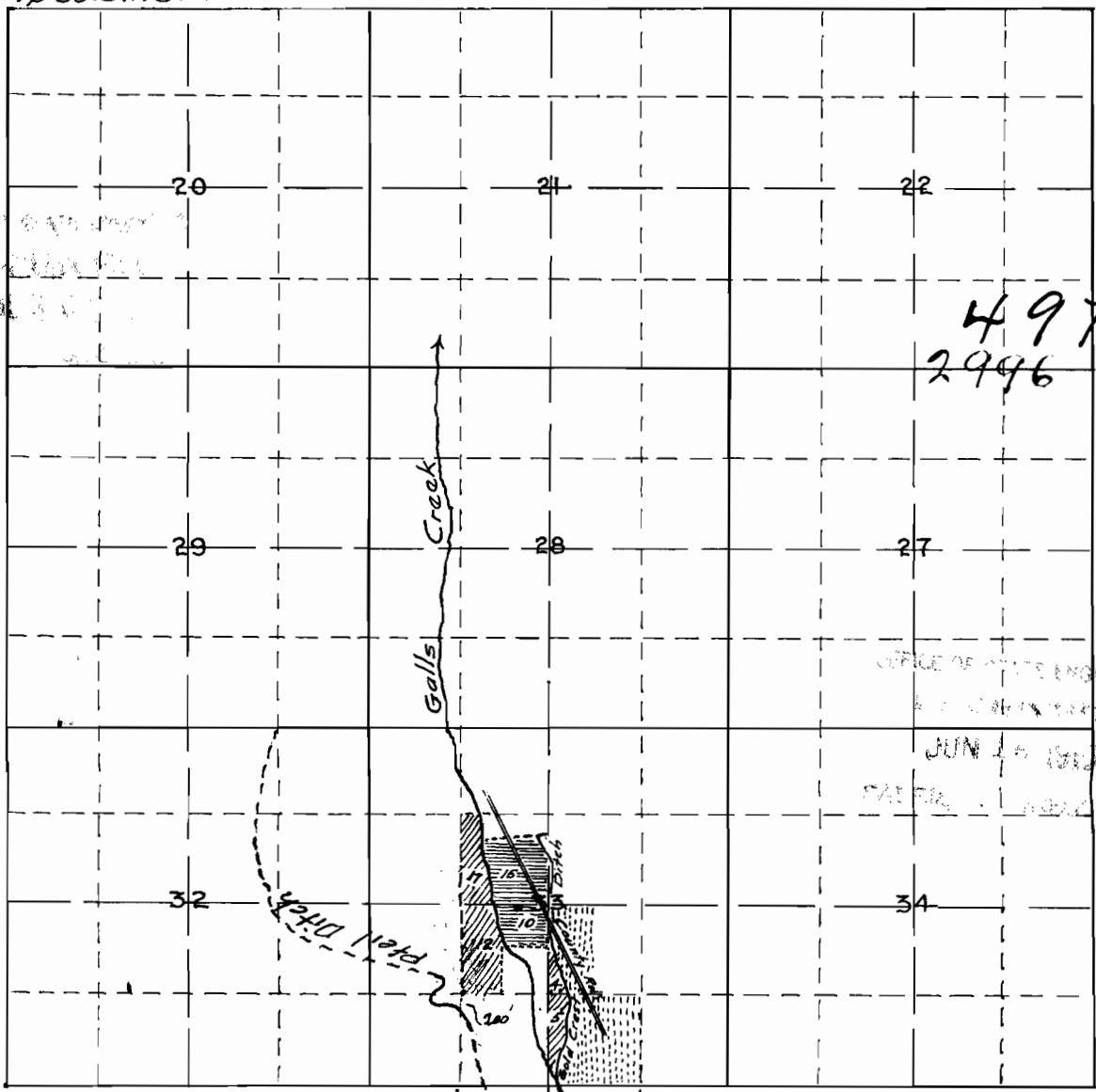
Tp 36. S. R3. W. W. M.



-  Lands irrigated under Decree
-  " owned by Gold Crest Fruit Co
-  " now applied for to irrigate Intake

Map made from plat of Gold Crest Fruit Co Lands

Fred N. Cummings C.E. Medford, Oregon.