

T. 11 S., R. 43 E.W.M.

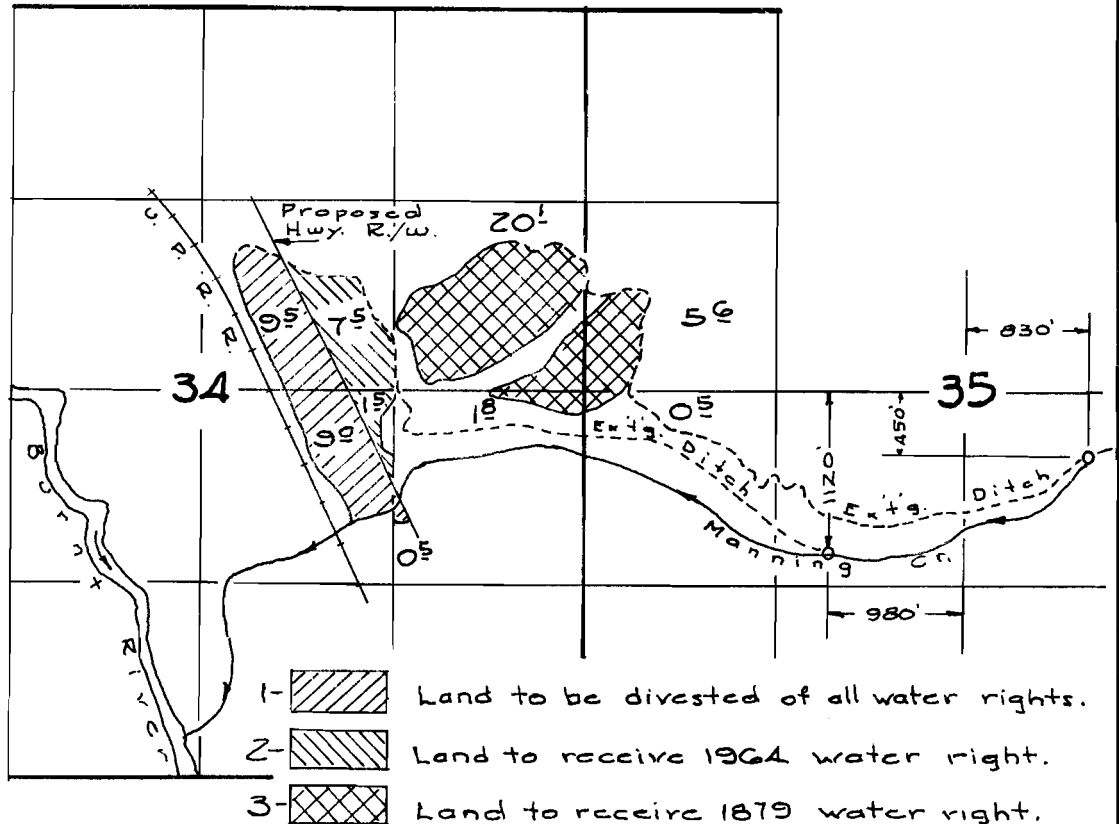

Note: The 1879 water is transferred from lands 1 & 2 to 3.

MAP TO ACCOMPANY APPLICATION
OF

FRED BUBB

DURKEE, ORE.
March, 1964

BAKER COUNTY
Scale 4" = 1 Mile

Note:

This map prepared from aerial
photographs

David B. Hall
Watermaster, Dist. 8

Application No. 40297
Permit No. 30056