

MAP

Accompanying application of JOHN GRIEVES for permit to appropriate the waters of Berrian Spring tributary to Rogue River, Jackson County, Oregon.

July 10<sup>th</sup> 1916.

Medford, Oregon.

Tp 33. S. R. 1. E. W. M.

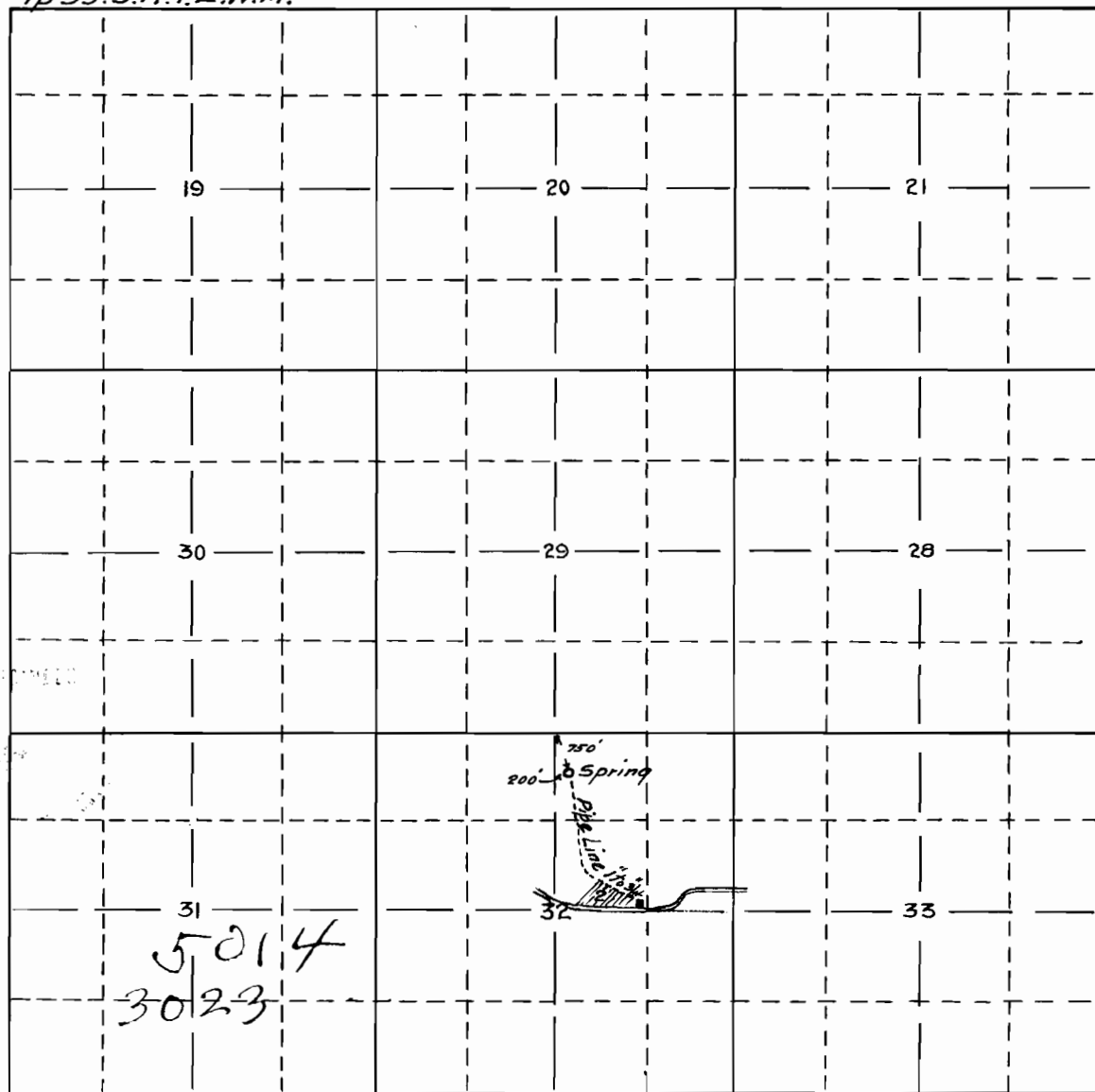

Map made from notes and measurements of an actual survey made by W. F. McLeod of Prospect, Oregon, and plat compiled by

Fred. N. Cummings C.E.

Medford, Oregon.