

Map of the
ARGO PLACER DITCH

Scale 2 in = 1 mile

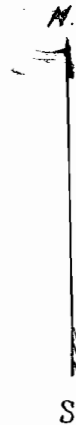

I, C.E. Noble, of Galice, Ore., do hereby certify that this map was made from notes taken during an actual survey made by me on June 22, 1916 and that it correctly represents the works described in the accompanying application together with the location of streams and other ditches in the immediate vicinity and has written thereon the area in each smallest legal subdivision which it is proposed to mine and irrigate

C.E. Noble, Surveyor

OFFICE OF STATE ENGINEER
RECEIVED
JUN 28 1916
OREGON

5001
3046

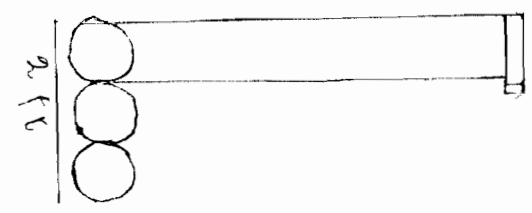
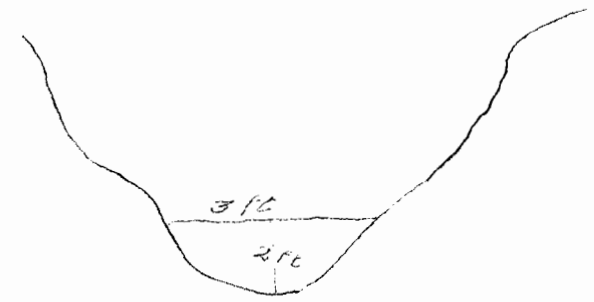
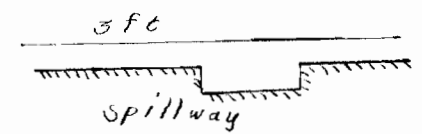
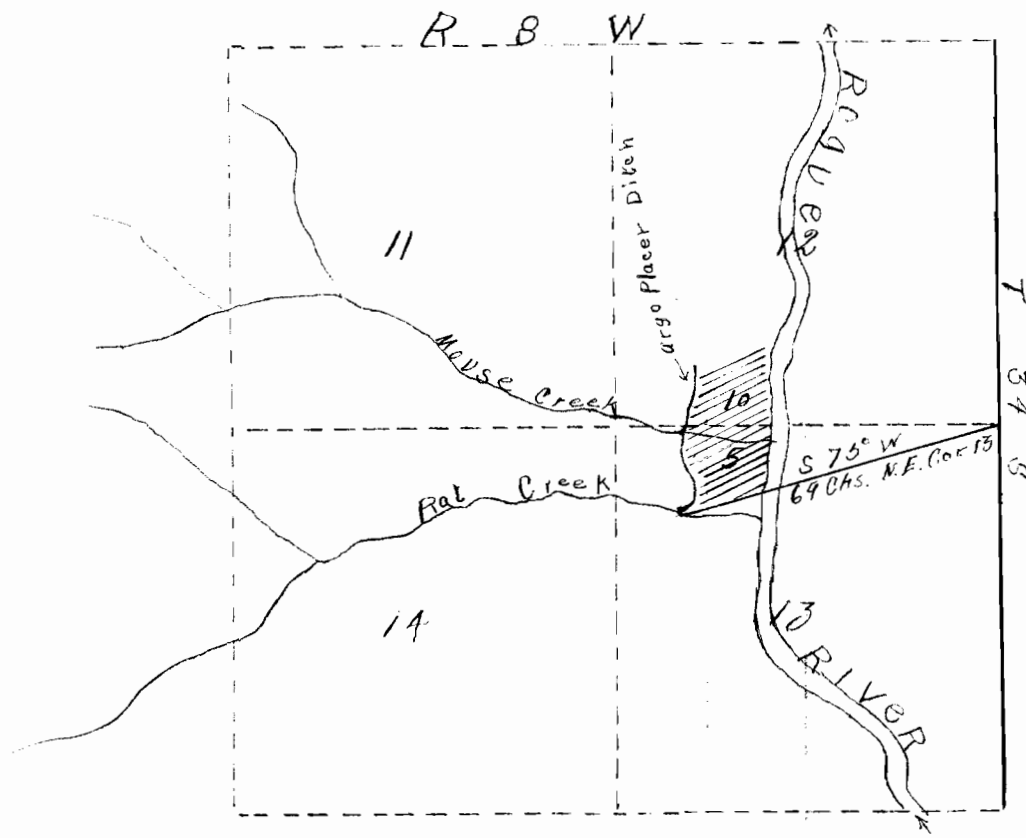

Cross-section dam