

MAP

Accompanying application of C. M. Parker for permit to appropriate the waters of Bear Creek tributary to Rogue River Jackson County, Oregon.

July 15<sup>th</sup> 1916

Medford, Oregon.

Tp 37.S.R. 2.W.W.M

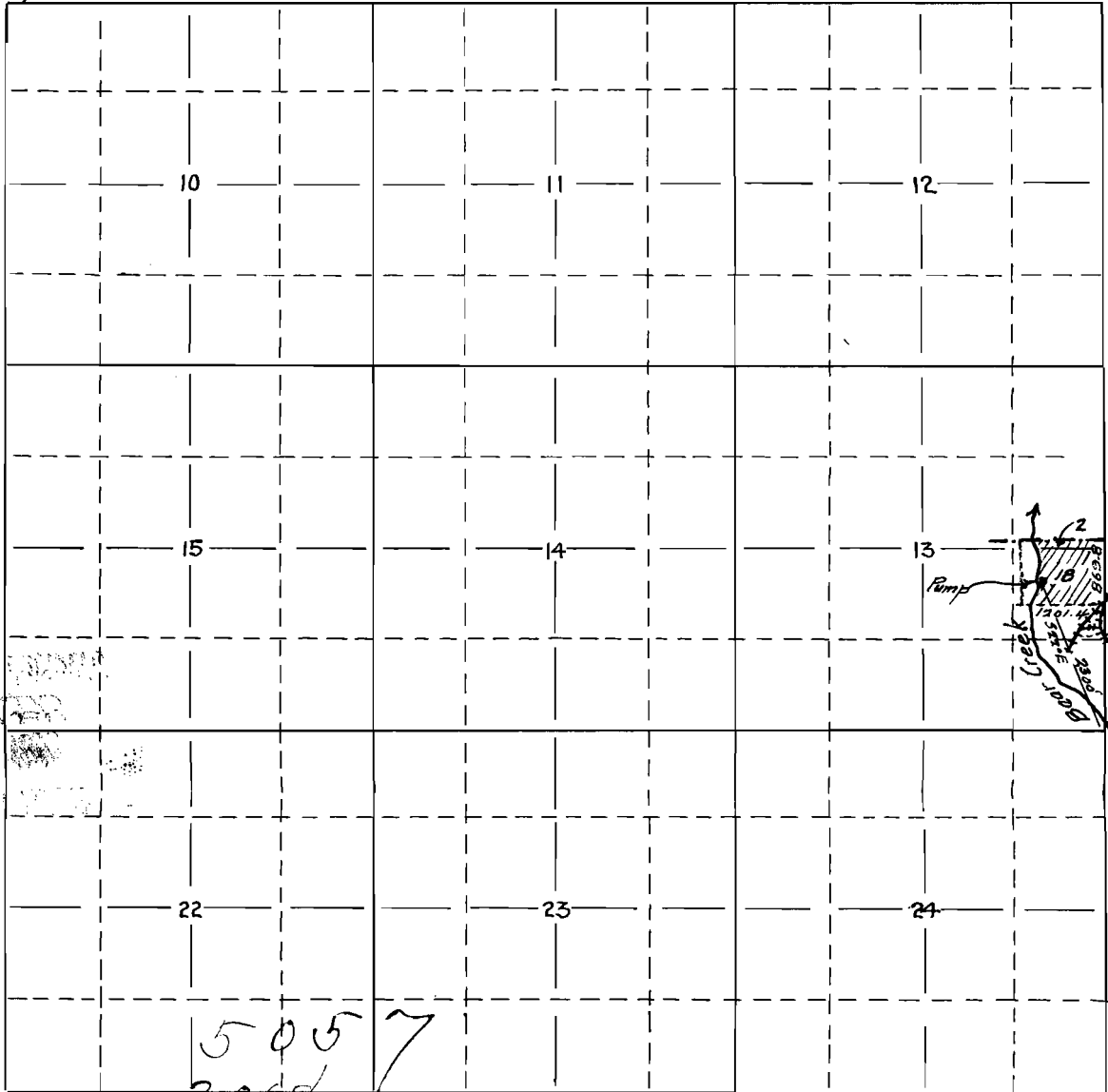

Map made from notes of an actual survey made by me July 15<sup>th</sup> 1916 and that it correctly represents the acreage to be irrigated and works, ditches, streams in immediate vicinity

Fred. N. Cummings C.E.

Medford, Oregon.