

# PACIFIC CITY WATERSHED HORN CREEK

**RECEIVED**  
JUL 8 1964  
STATE ENGINEER  
SALEM, OREGON

T4S R10W W.M.  
SEC. 8, 9, 16 & 17  
TILLAMOOK COUNTY  
OREGON

SCALE: 4" = 1 MILE

2

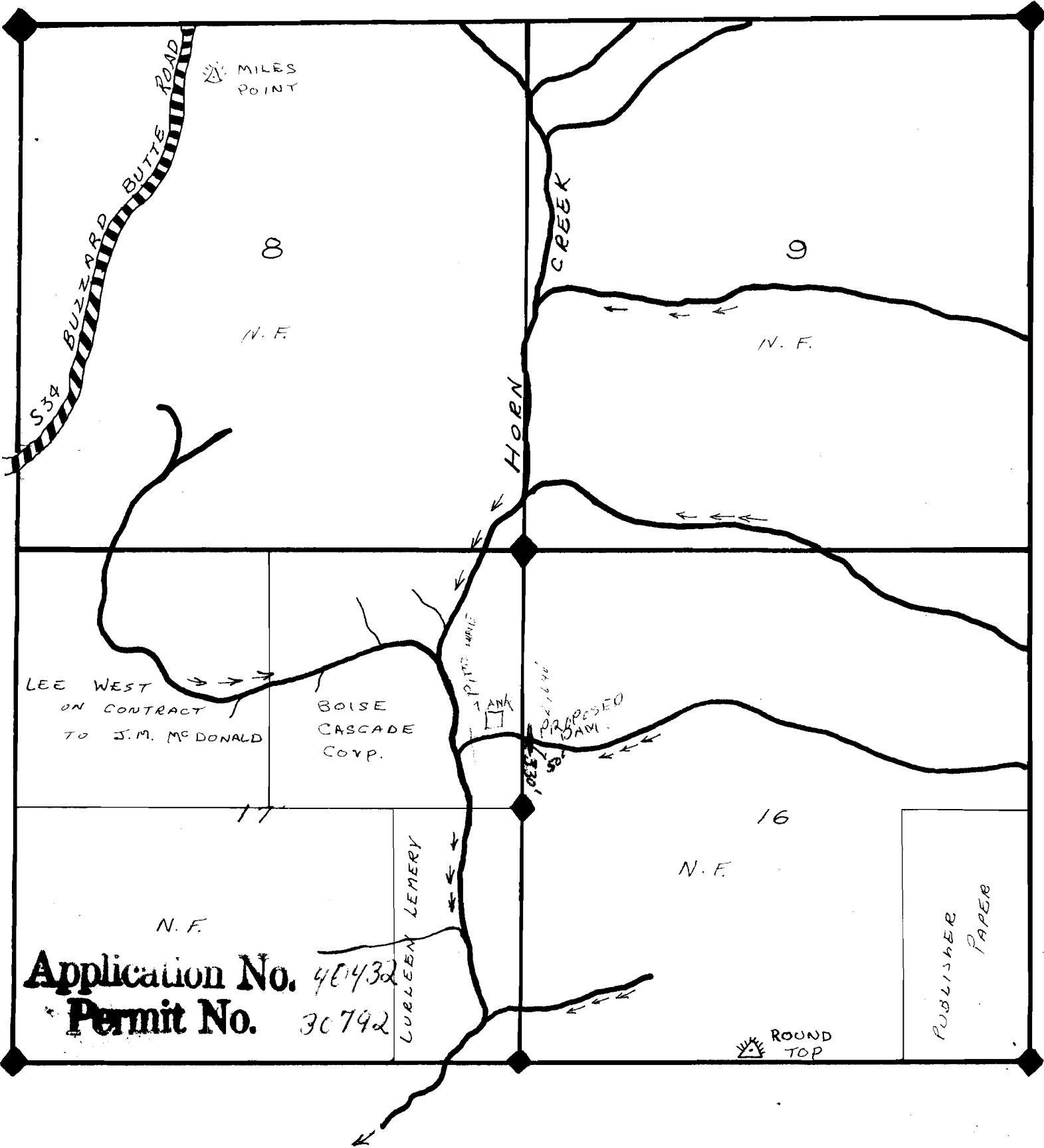

Application No. 40432  
Permit No. 30792

PUBLISHER  
PAPER

ROUND  
TOP