

R-4677
30997
26-5-31

T.36 & 37 S. R.5 & 6 W. W.M.

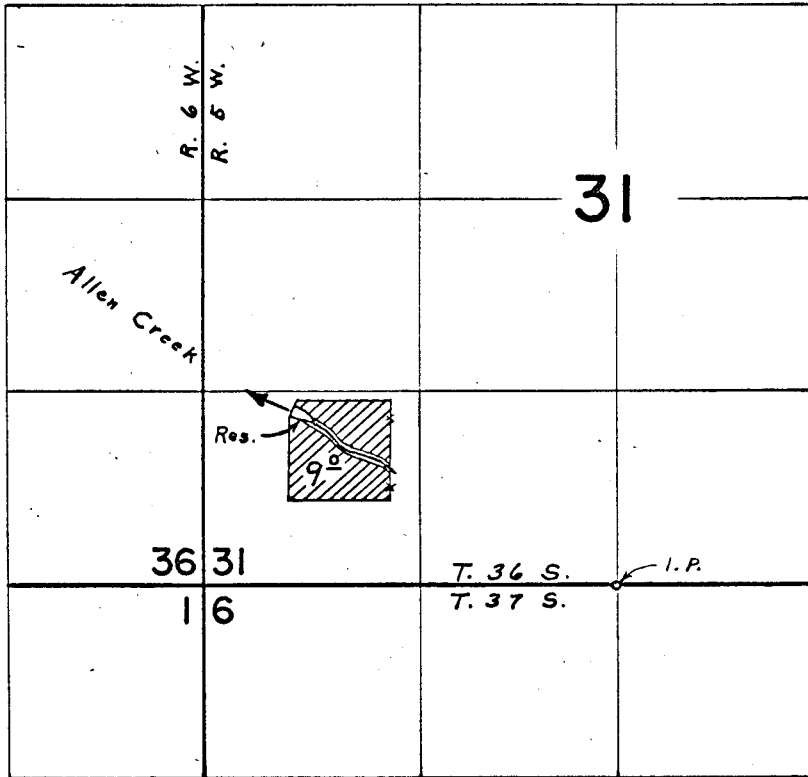

Div. Pt. located 1180 N. & 2180 W. from the S. $\frac{1}{4}$ Cor. Sec. 31

FINAL PROOF SURVEY UNDER

R-41554 R-4679
Application No. 41555 Permit No. 30997
IN NAME OF

NEWELL B. WRIGHT

Surveyed Aug. 28, 1967, by L. E. Gould