

**PLAN ACCOMPANYING APPLICATION OF
GREEN FOREST ACRES INC.**

**FOR RIGHT TO APPROPRIATE WATER FROM
AN UN-NAMED SPRING IN LOT 6, SEC. 18,
T 25S, R 11 W.**

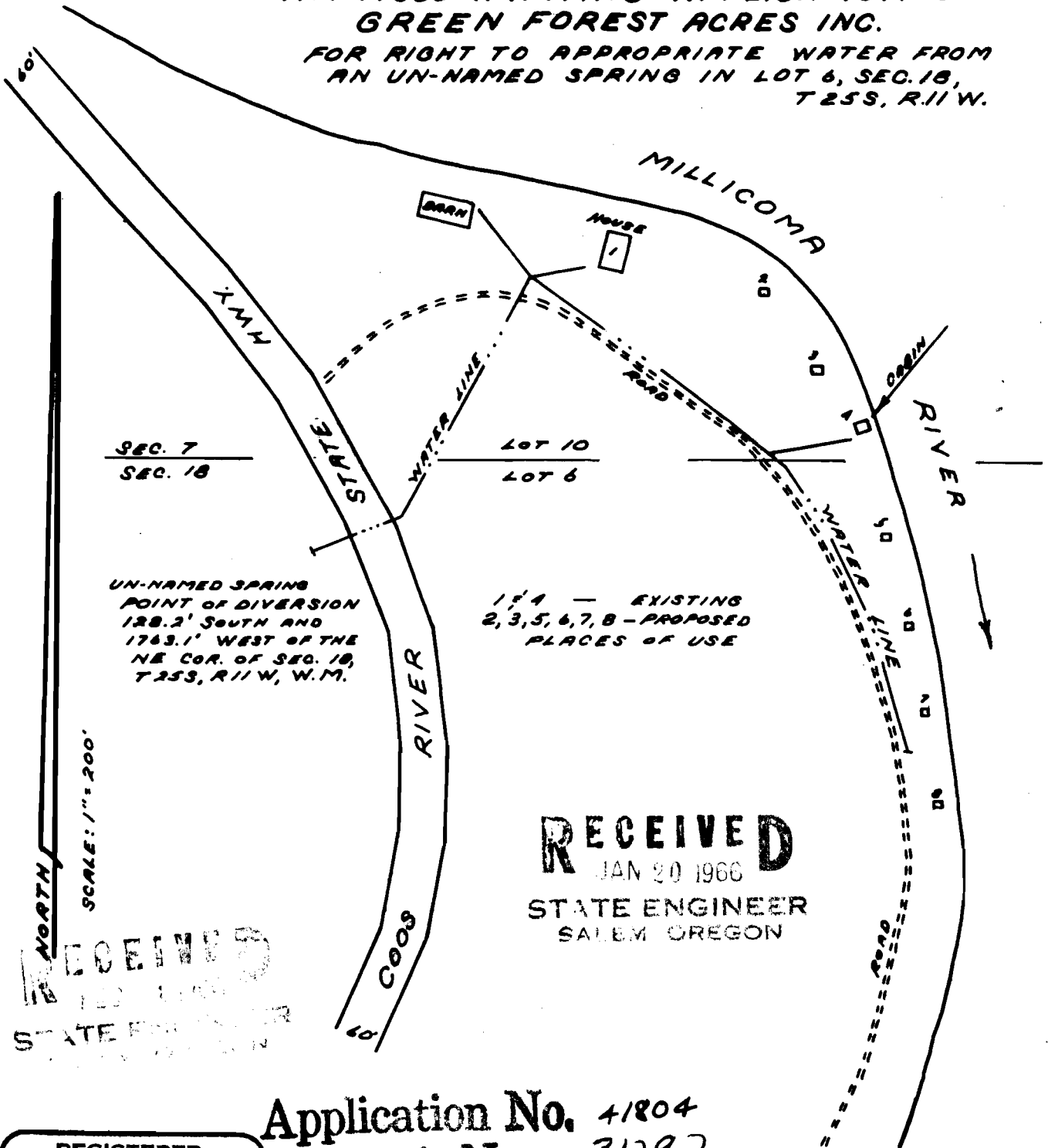

UN-NAMED SPRING
POINT OF DIVERSION
128.2' SOUTH AND
1763.1' WEST OF THE
NE COR. OF SEC. 18,
T 25S, R 11 W, W.M.

1, 4 — EXISTING
2, 3, 5, 6, 7, 8 — PROPOSED
PLACES OF USE

RECEIVED
JAN 20 1966

STATE ENGINEER
SALEM OREGON

RECEIVED
STATE ENGINEER
SALEM OREGON

Application No. 41804
Permit No. 31292

I, Richard J. Hintz, of Coos Bay, Oregon, do hereby say that this map was made from notes taken during an actual survey made by me on the 17th day of January, 1966, and that it correctly represents the location of the point of diversion and the places of use, and the approximate location of the pipe lines.

**REGISTERED
OREGON
LAND SURVEYOR**

Richard J. Hintz

MAY 13, 1960
RICHARD J. HINTZ
497