

R29E

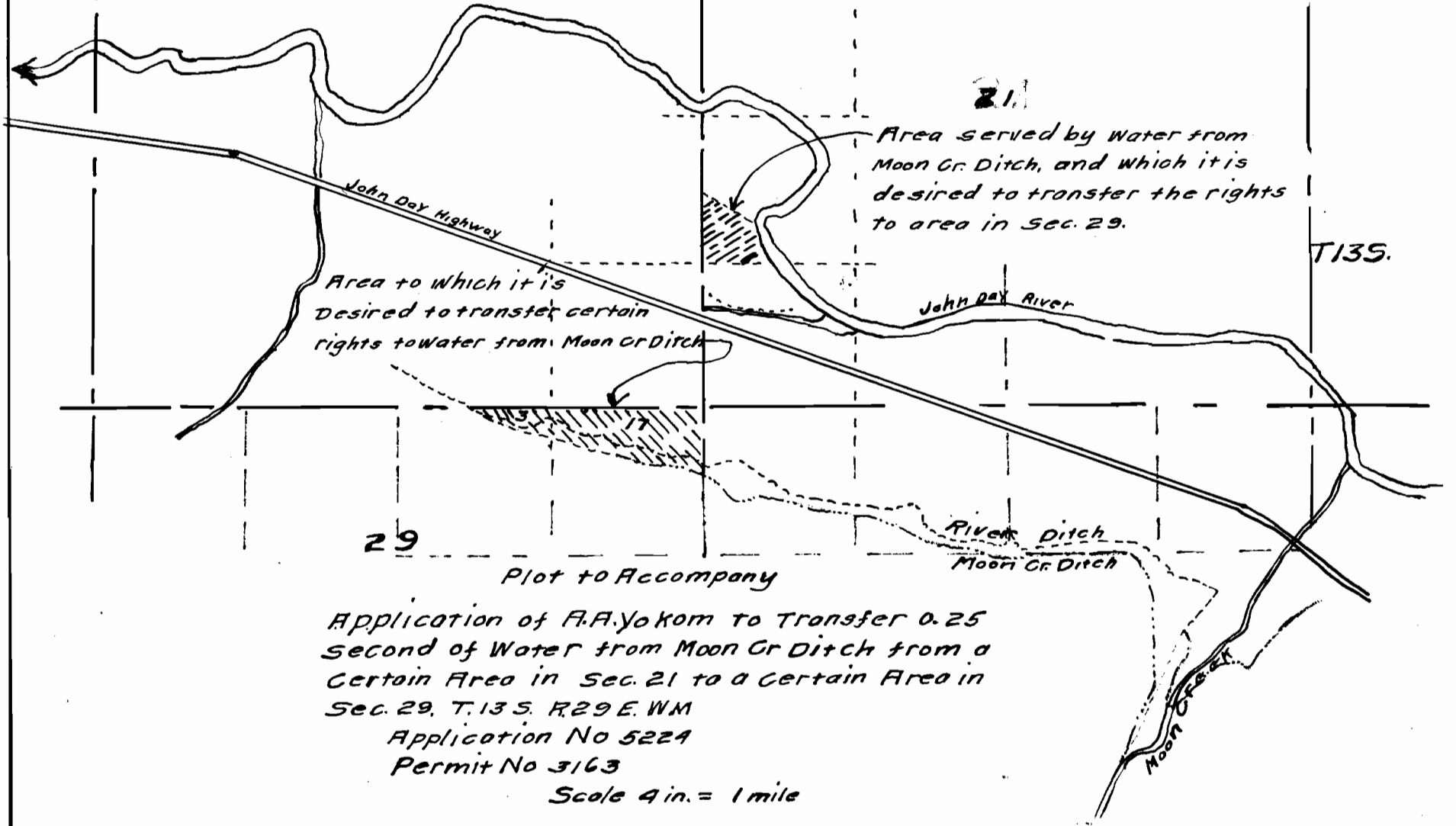

21
Area served by water from Moon Cr. Ditch, and which it is desired to transfer the rights to area in Sec. 29.

Area to which it is desired to transfer certain rights to water from Moon Cr. Ditch

29
Plot to Accompany

Application of R.A. Yokom to Transfer 0.25 Second of Water from Moon Cr Ditch from a Certain Area in Sec. 21 to a Certain Area in Sec. 29, T.135, R.29 E. WM
Application No 5224
Permit No 3163
Scale 4 in. = 1 mile

FINAL PROOF SURVEY

Under
Application No. 5224 Permit No. 3163

In Name of

BLUE MOUNTAIN DITCH CO.

Inspected 25626 June 1957

By R.H. Whitby

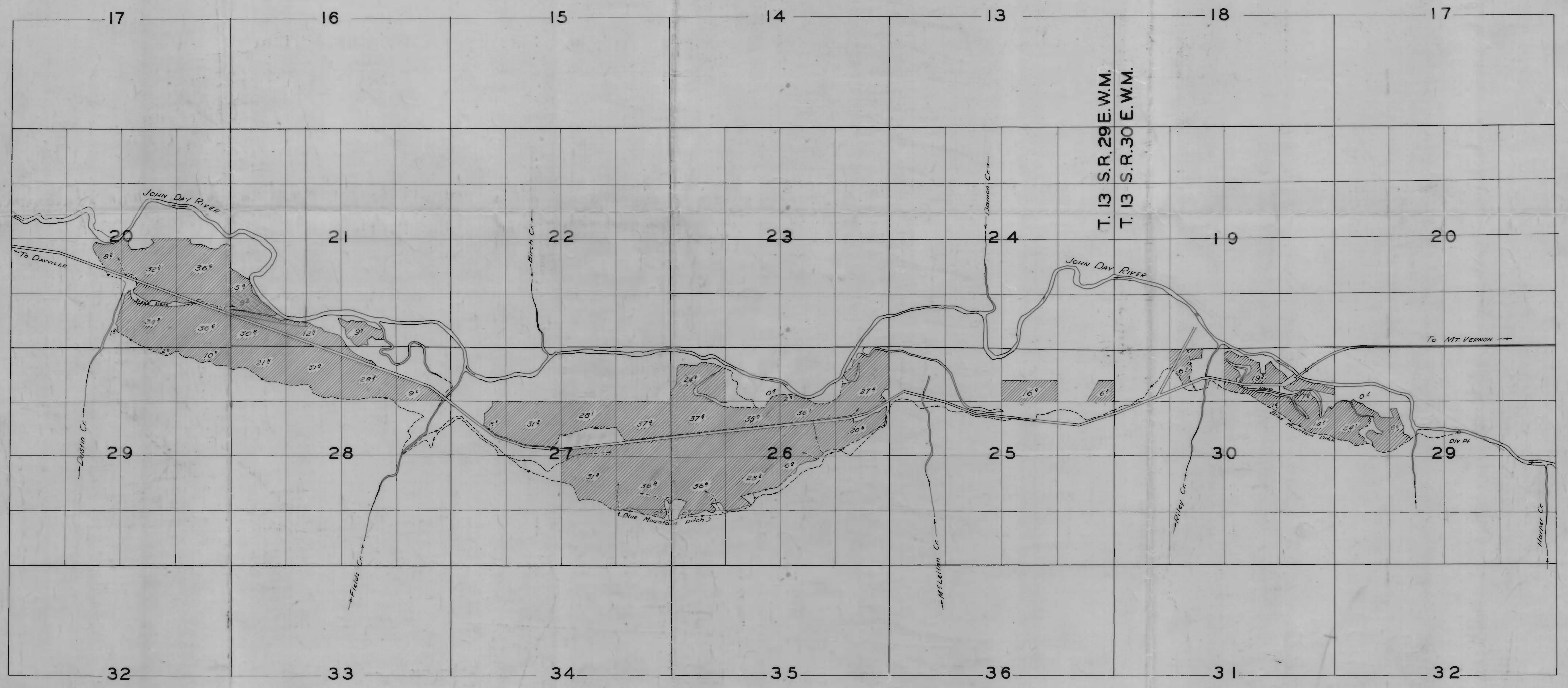
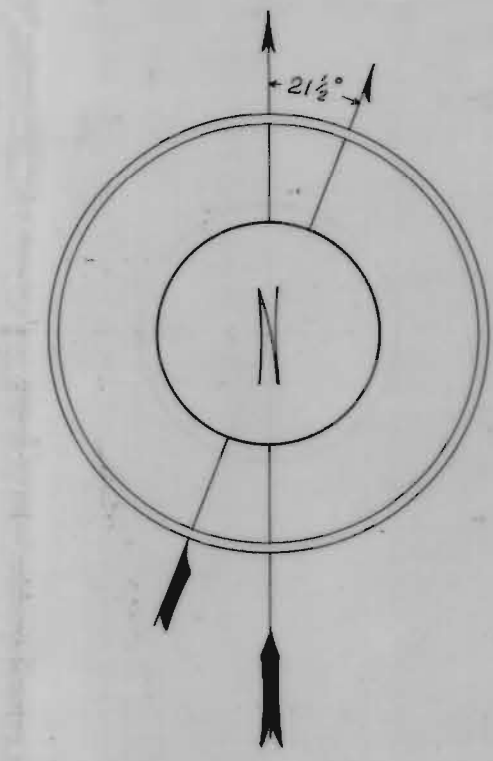

252

BLUE MOUNTAIN DITCH

Blu Mountain Ditch Co. (Incorporated)
Appropriator

Scale 2 inches = 1 mile

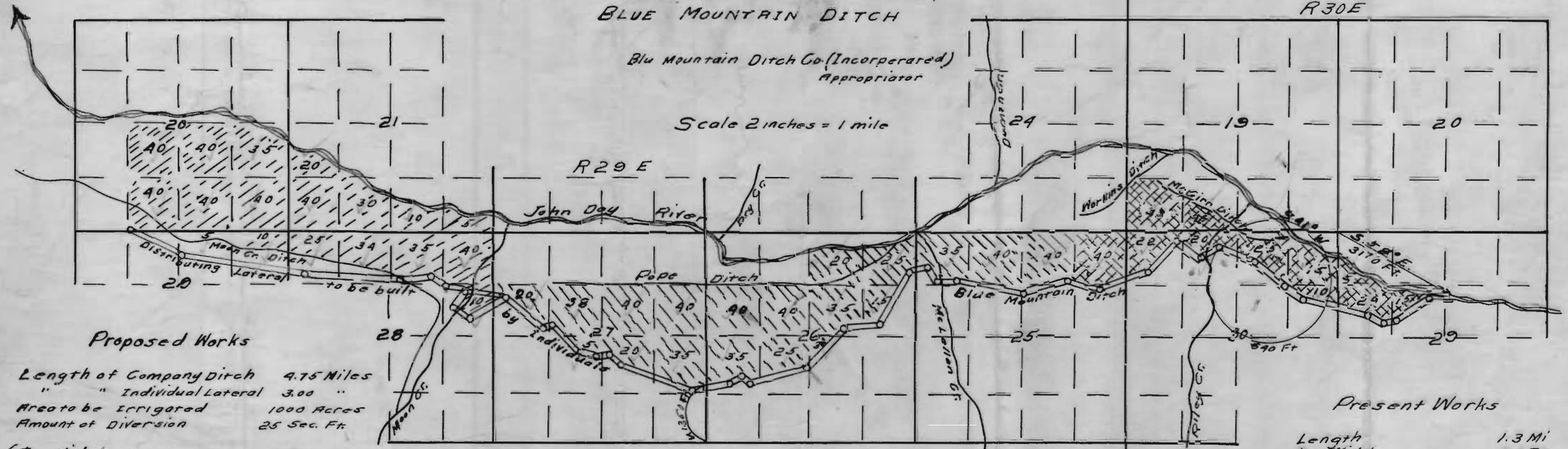

T.13 S.

Proposed Works

Length of Company Ditch 4.75 Miles
 " " Individual Lateral 3.00 "
 Area to be Irrigated 1000 Acres
 Amount of Diversion 25 Sec. Ft.

1 to 6 Miles { Top Width 7 Ft.
 Bottom Width 5 "
 Depth of Water 1.5 "
 Grade 0.85 Ft. to 1000 Ft.

6 to 7.75 Miles { Width on top 4 "
 " " Bottom 2 "
 Depth of Water 1 "
 Grade 1.25 Ft. to 1000 Ft.

Present Works

Length 1.3 Mi
 Top Width 3.0 Ft
 Bottom Width 1.5 "
 Grade 0.85 Ft. to 1000 Ft.
 Carrying Capacity 4 Sec. Ft.
 Area Irrigated 220 Acres.

Certificate of Surveyor

I, L. ELUCAS, of John Day, Oregon, do hereby certify that this map was made from notes taken during an actual survey made by me March 18-23, 1911, and that it correctly represents the works described in the accompanying application, together with the location of streams and other ditches in the immediate vicinity, and has written thereon the area in each smallest legal subdivision which it is proposed to irrigate

L. Lucas
SURVEYOR

Application No. 5224
 3163 OFFICE OF STATE ENGINEER
 RECEIVED
 OCT 23 1911