

0 P 4 2

Township 27 South Range 29 East W. M.

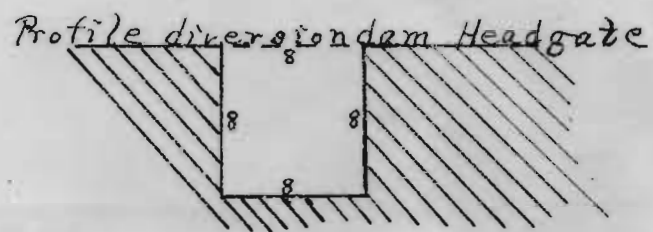
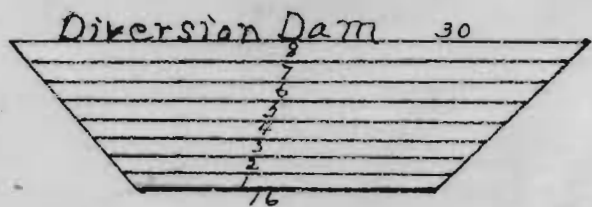

Legend Sec 3.
 Diversion Dam & main Canal therefrom
 Lands to be irrigated by these
 proposed works, consisting of 80 acres.

This map is made to accompany Application for permit to appropriate Public Waters of Oregon By James E Sizemore of Harrows Oregon.
 This map is made from notes and data furnished myself by Charles E Beery of Burns Oregon, who obtained the data from an actual survey, and that it correctly represents the works described in accompanying Application together with the location of streams and other ditches in the immediate vicinity, and have written thereon the number of acres in each legal subdivision proposed to be irrigated.

W. J. Lester
 Draftsman

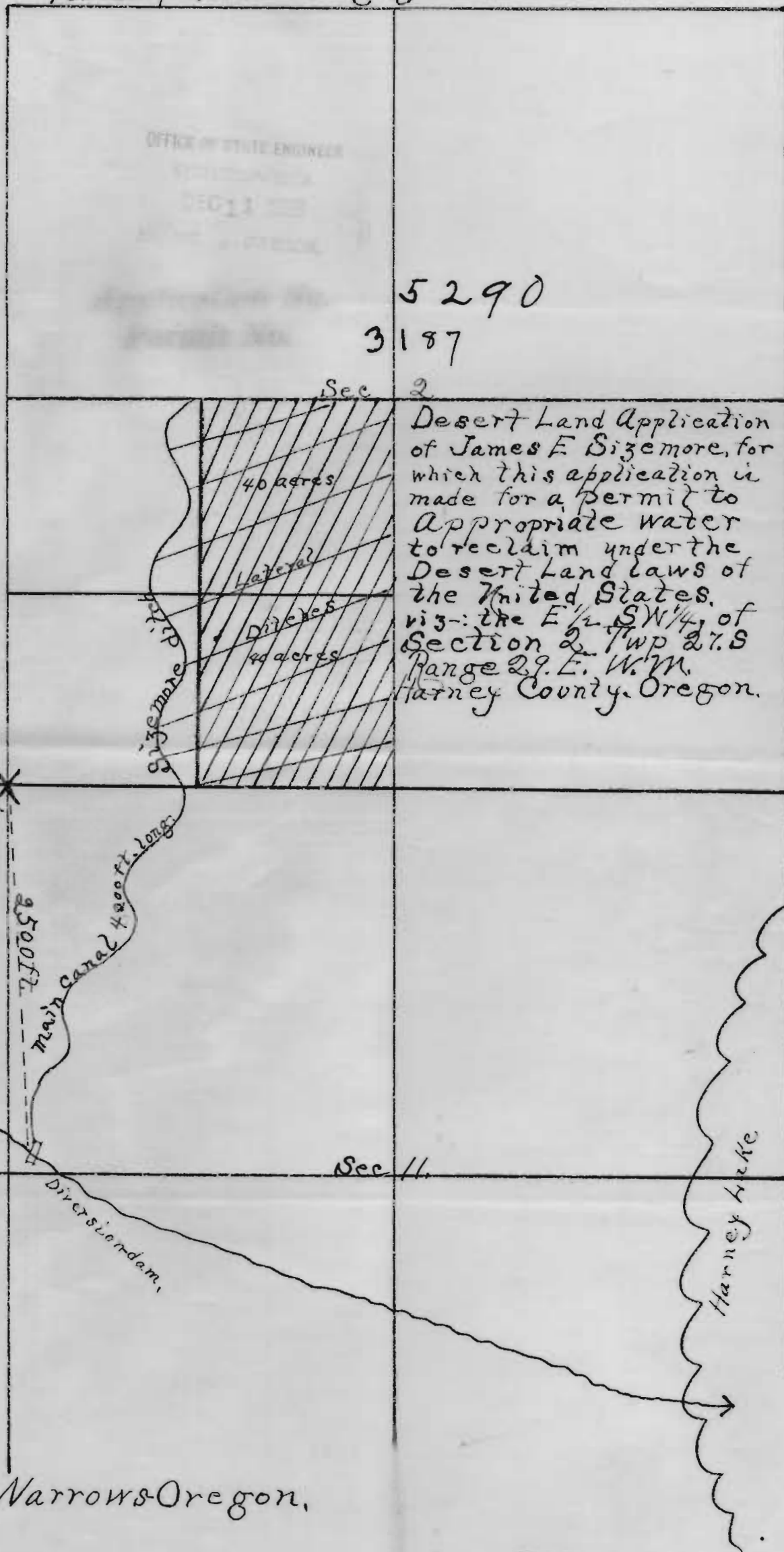

5290
 3187

Desert Land Application of James E Sizemore, for which this application is made for a permit to appropriate water to reclaim under the Desert Land laws of the United States, viz: the E 1/2 SW 1/4 of Section 2, Twp 27 S Range 29 E. W. M. Harney County, Oregon.

2590

Map James E Sizemore Works, Harrows Oregon.

2590