

T.3 S. R.40 E. W.M.

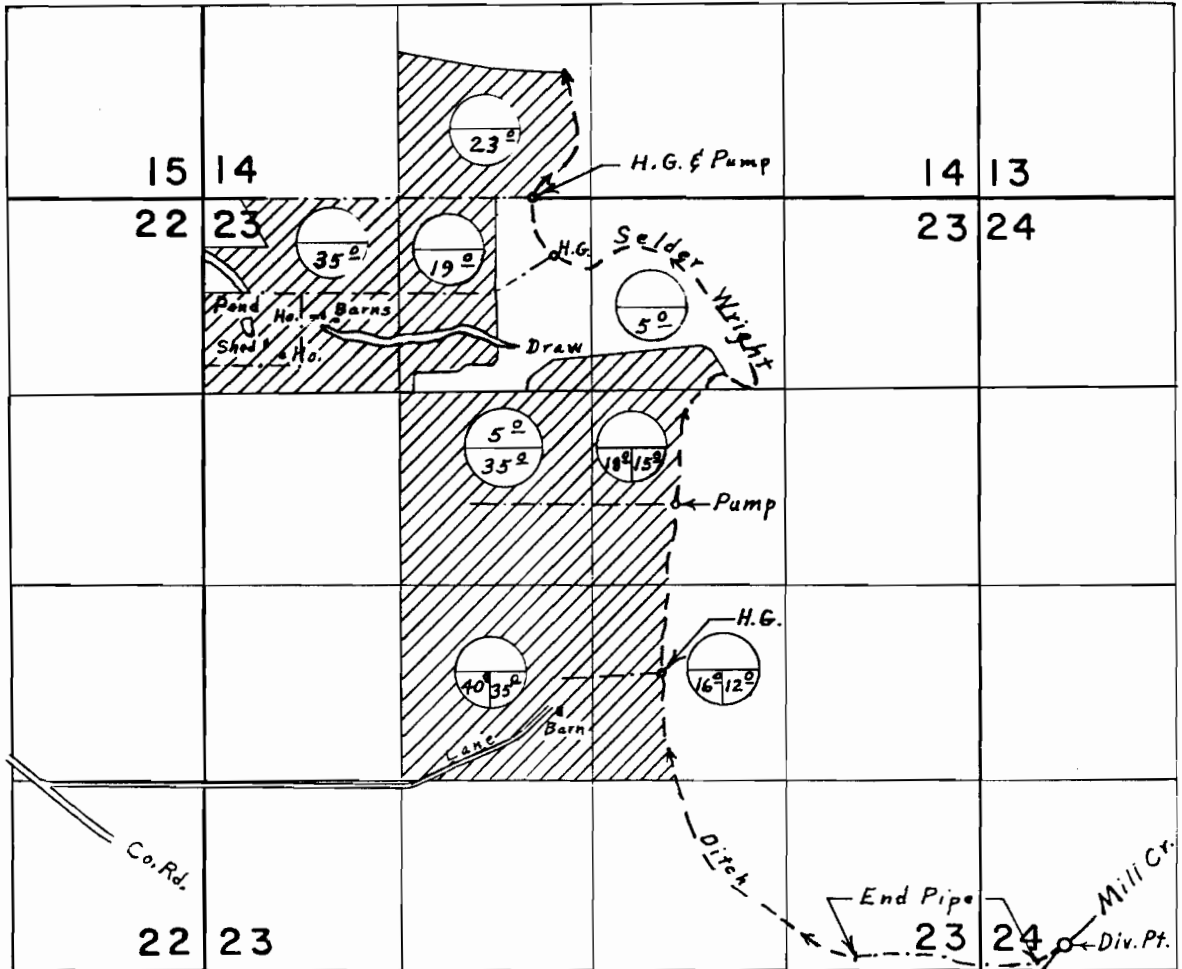

Div. Pt. located 180' N. & 560' E. from S.W. Corner Section 24

Primary
Supplemental-Found  Allowed

FINAL PROOF SURVEY UNDER

Application No. ~~42743~~ Permit No. ~~31925~~
IN NAME OF

J. EUGENE SCOTT

Surveyed Sept. 17, 1974, by L. E. Gould