

T.39S., R.5W., W.M.

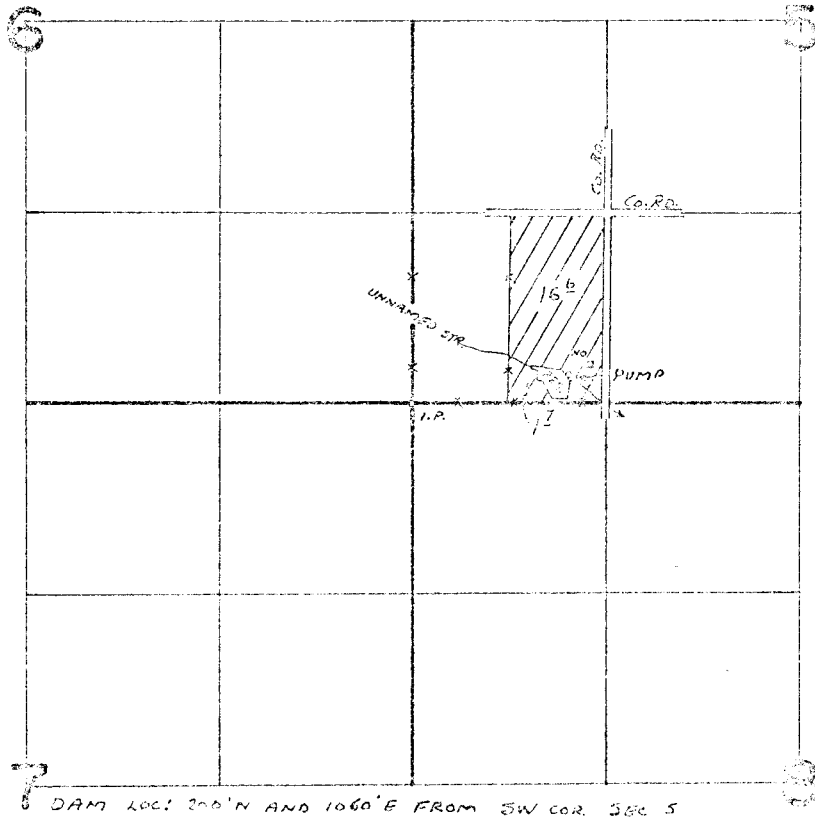

RECEIVED

MAY 19 1980

WM. DIST. 14  
GRANTS PASS, ORE

FINAL PROOF SURVEY

UNITED

R-42885

R-4895

Application No. 43124

32191

LEO DUNTLEY

Surveyed SEPT. 11, 1974, by L. Tall

1975 10 14 20