

OFFICE OF STATE ENGINEER

RECEIVED

JAN 22 1913

SALEM, - OREGON.

Application No.

5358

Permit No.

3240

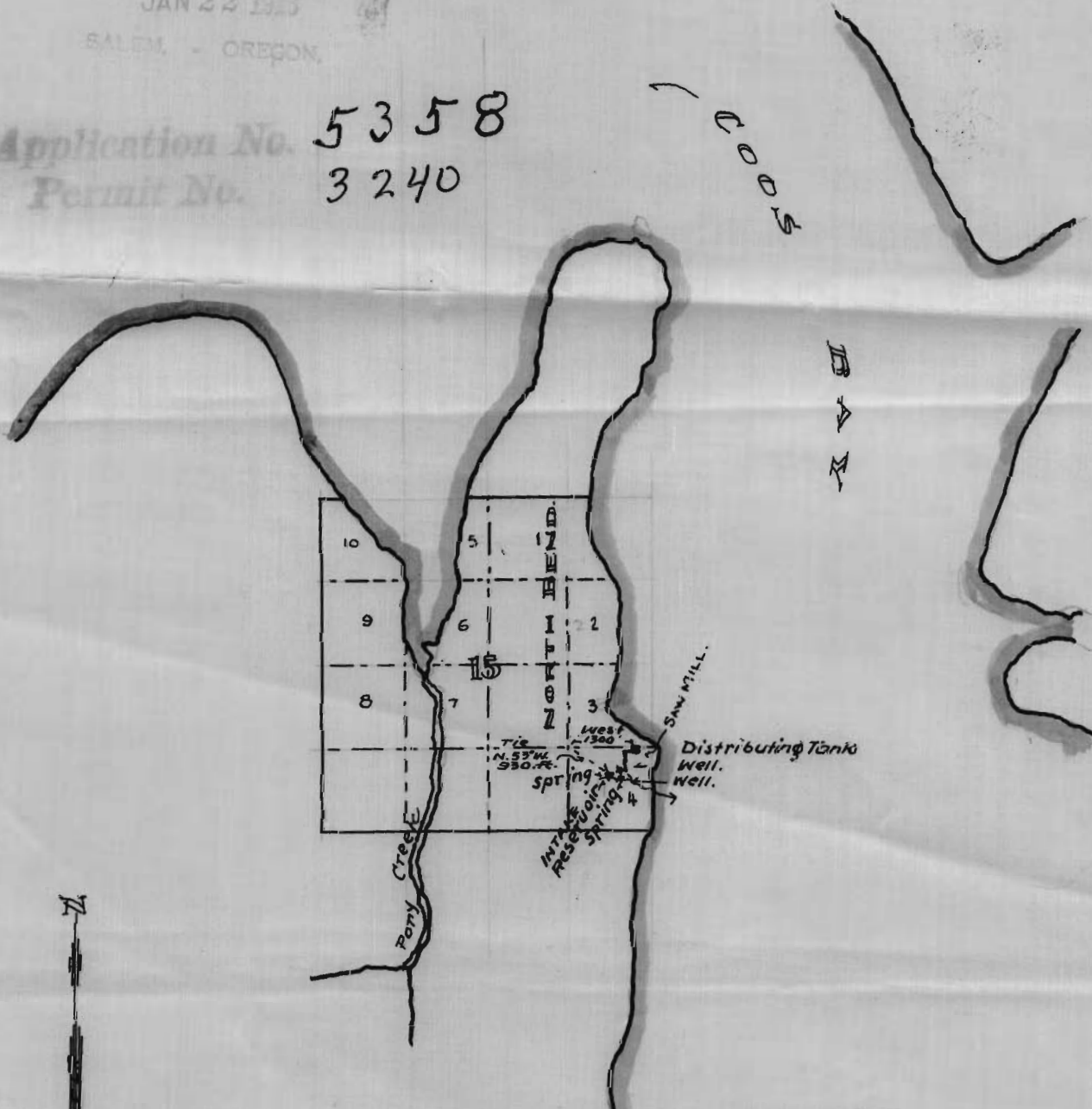

Scale 2" = 1 mile.

Map showing
**PORTER MILL
WATER SUPPLY.**
1/6 cu. ft. per second.

Certificate of Surveyor.

I, E. L. Robinson, of Marshfield, Ore., do hereby certify that this map is made from notes taken in an actual survey made by me Oct. 26, 1916 and that it correctly represents the works and territory described in the application.

E. L. Robinson
Surveyor.

Situated in Lot 4, Section 15.
Twp. 25 S., Range 13 N.,
W. 1/4 M. 2,
Coos County, Oregon.

Buehner Lumber Company,
Applicant.

Application No.
Permit No.

To accompany Application for Permit
To the STATE ENGINEER, Salem, Oregon.

2938

3898