

T.4S.R.IE.W.M.

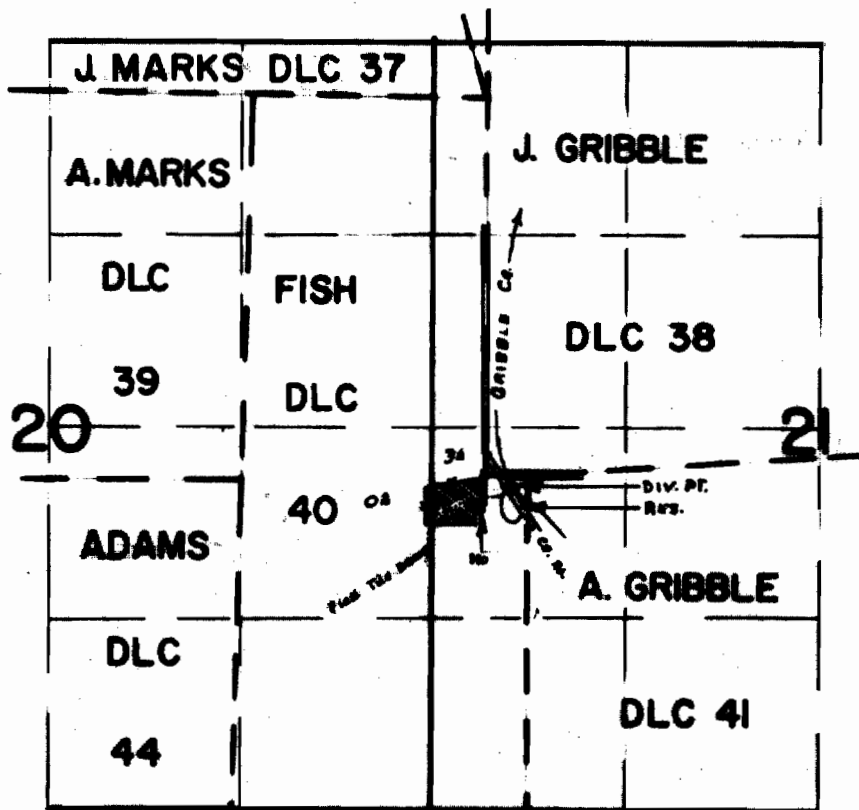

DN. PTS. LOC.: CR.-70' S. & 180' E.; RES. DRAIN-130' S. & 170' E.; BOTH FROM SW COR. J. GRIBBLE DLC 38

FINAL PROOF SURVEY UNDER

G-3870
R-43435

G-3643
R-4987

Application No. 43435 Permit No. 32474

IN NAME OF

JOHN H. PETERS

Surveyed APR. 28, 1971, by B. MUCKEN