

ROSEBURG LUMBER CO.
 SECTIONS 33 & 34, T.28S, R.6W. W.M.
 DOUGLAS COUNTY, OREGON
 SCALE - 1" = 500'

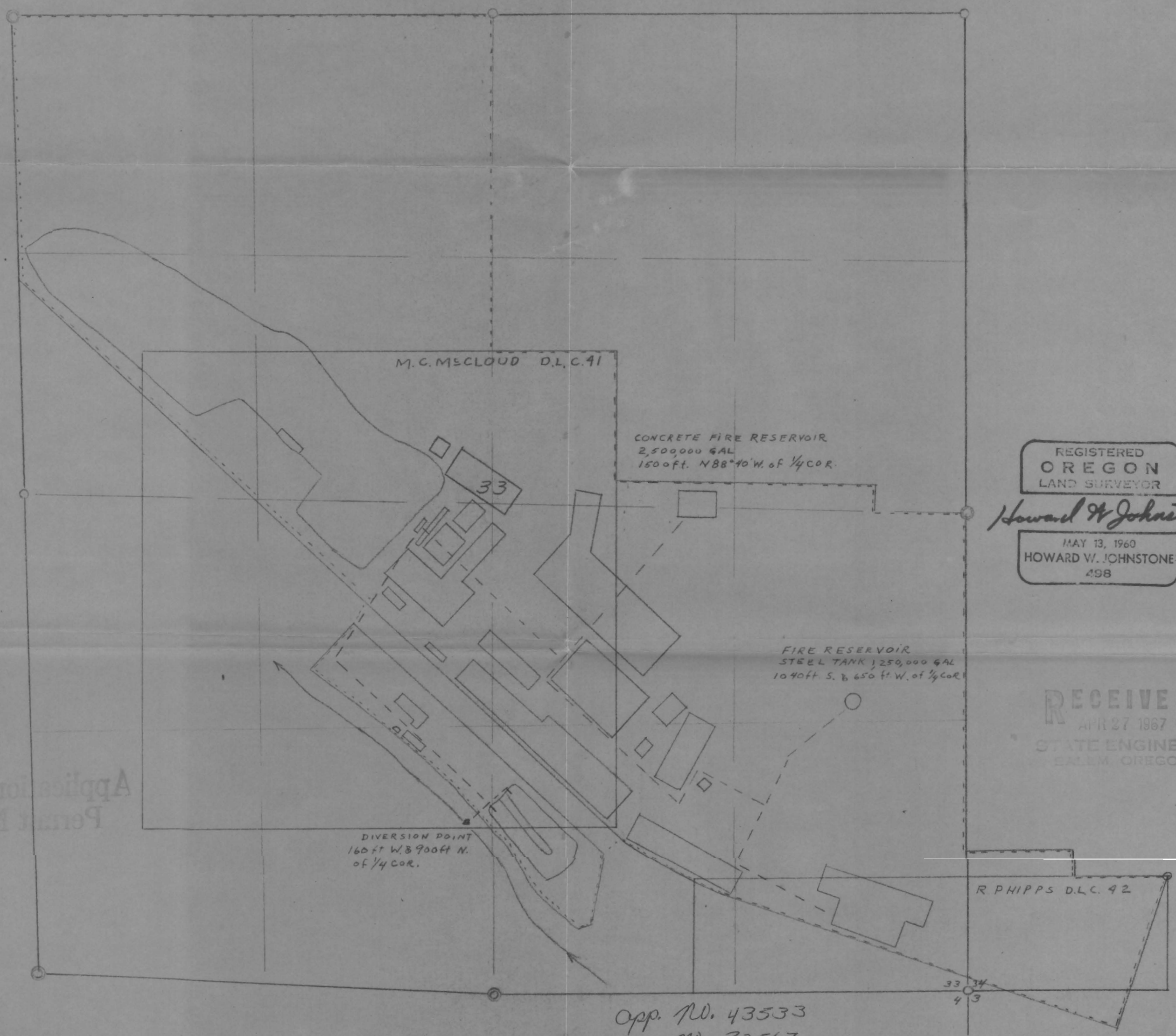
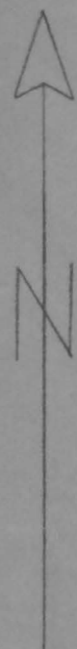

M.C. McCLOUD D.L.C. 41

CONCRETE FIRE RESERVOIR
 2,500,000 GAL
 150 ft. N 88° 40' W. of 1/4 COR.

FIRE RESERVOIR
 STEEL TANK 1,250,000 GAL
 104 ft. S. & 650 ft. W. of 1/4 COR.

DIVERSION POINT
 160 ft. W. & 900 ft. N.
 of 1/4 COR.

R. PHIPPS D.L.C. 42

REGISTERED
 OREGON
 LAND SURVEYOR

Howard W. Johnstone

MAY 13, 1960
 HOWARD W. JOHNSTONE
 498

RECEIVED
 APR 27 1967
 STATE ENGINEER
 ELLIEM OREGON

App. No. 43533
 Per. No. 30567

HWT
 4-67

Application No. 43533
 Permit No. 30567