

Application No. 751
Permit No. 327

ST. ANDREW'S MISSION WATER WORKS

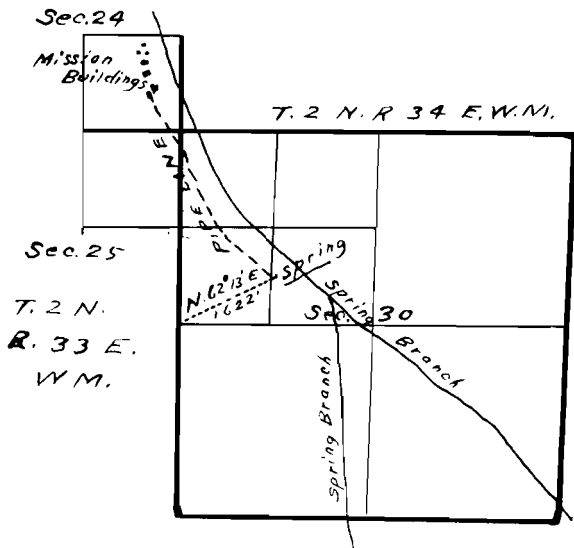

scale 40 chs = 1 in.

STATE OF OREGON } ss.
COUNTY OF UMATILLA }

I Geary Kimbrell of Pendleton
Or. do hereby certify that this
map was made from notes taken
during an actual survey made
by me on Nov. 20 1909 and that
it correctly represents the works
described in the accompanying
application, together with the
location of streams in the immediate
vicinity.

Geary Kimbrell
Surveyor