

5423

3287

APPROPRIATION  
of  
WATER  
by.

Mattie E. Camp  
Harper, Oregon.

SE 1/4 SW 1/4 Sec 23, Twp. 20 S. R 41 E, WM.

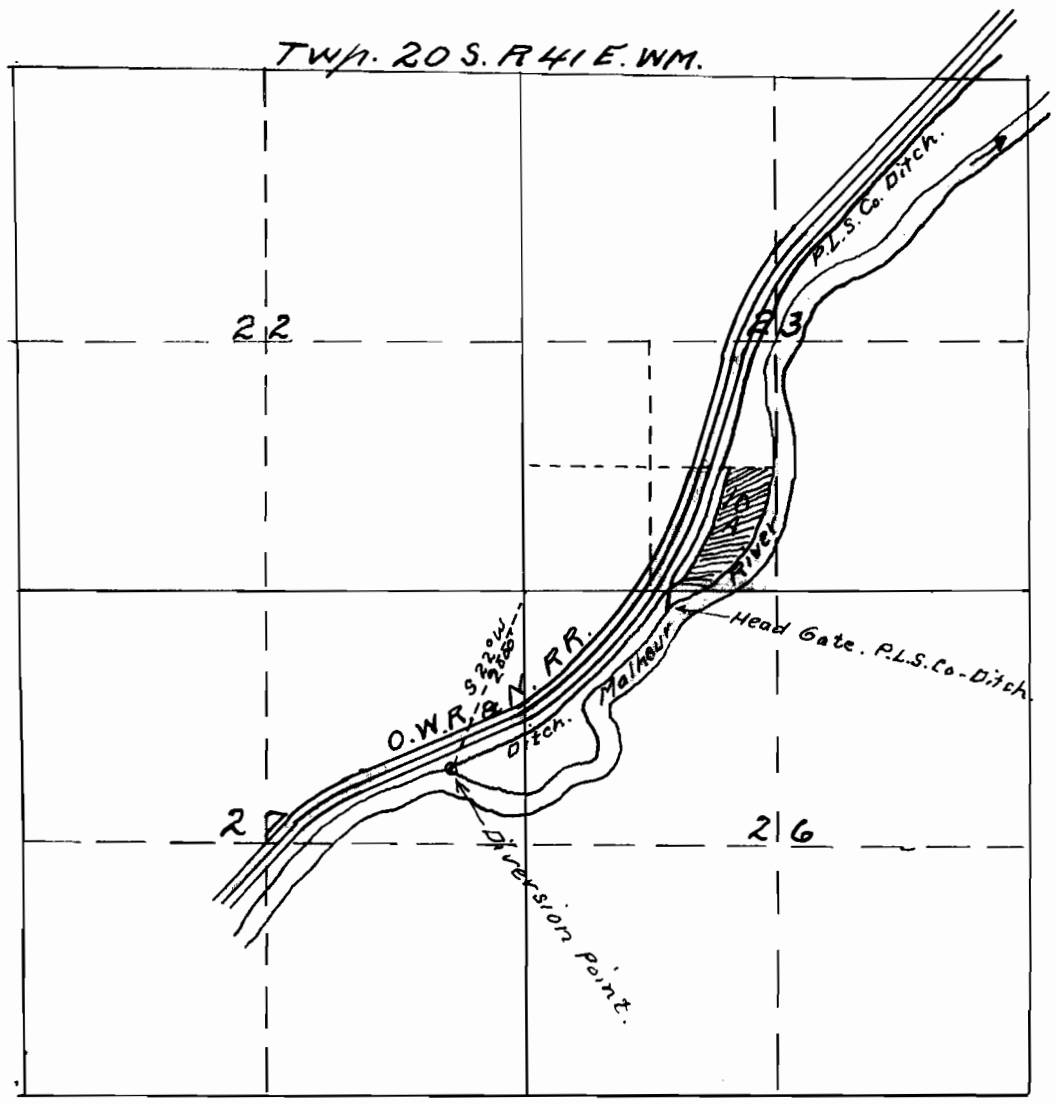

"Note," This map is made from notes partly furnished by Applicant and partly from previous surveys made by J.F. Miller C. E., Vale, Or.