

14 13
23 24

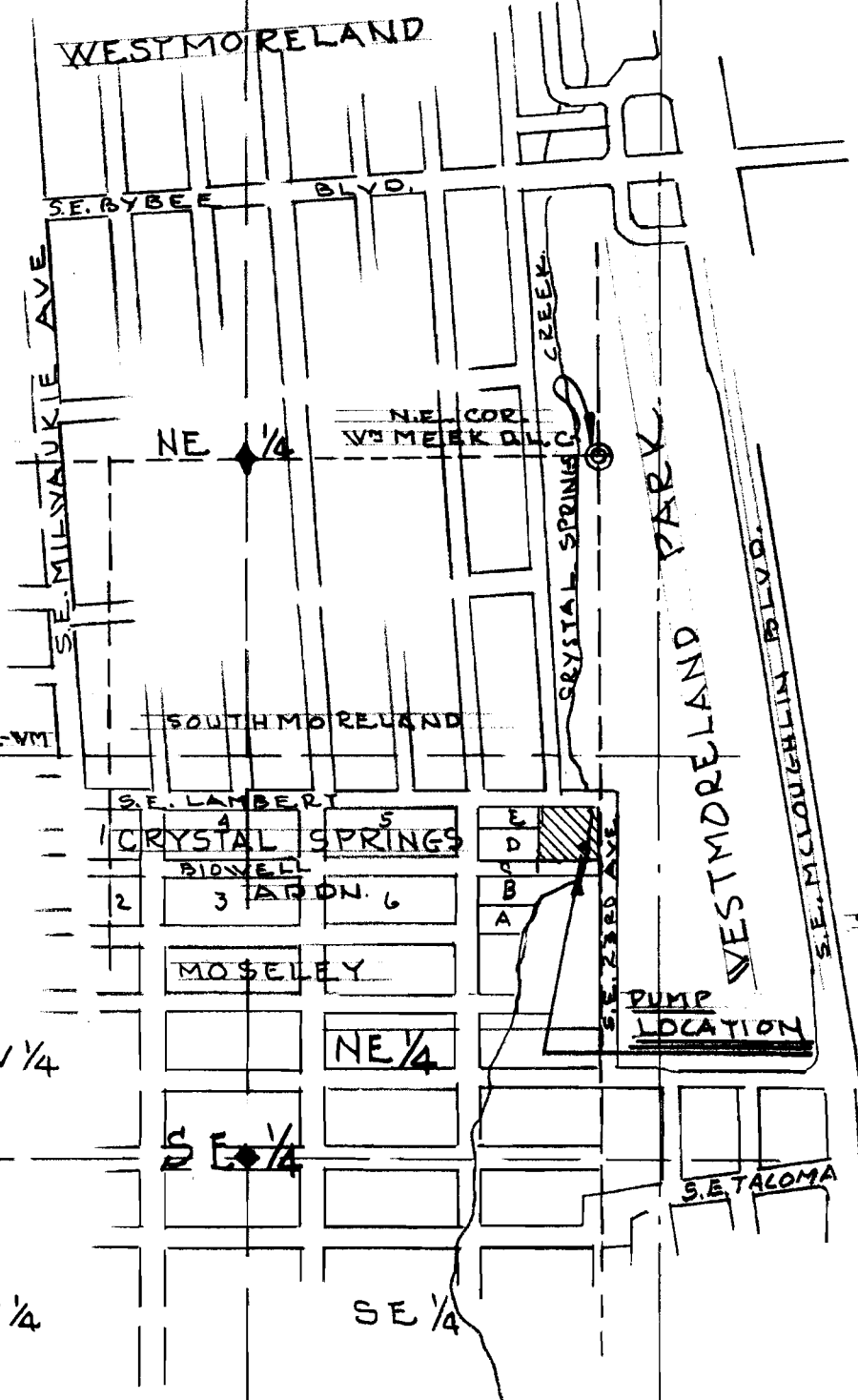

SCALE
1" = 600'

23 TIS-RIZ-VM

RECEIVED
SEP 4 1968
STATE ENGINEER
SALEM OREGON

Application No. 43942
Permit No. 33292
23 24
30 29

MAP PREPARED FOR CLYDE V. & MARGARET BRUMMELL
SHOWING PUMP LOCATION IN CRYSTAL
SPRINGS CREEK - IN SUPPORT OF A
REQUEST TO THE STATE ENGINEER FOR
WATER RIGHTS. 7-11-68

DAVID E. THOMPSON
LANDSCAPE ARCHITECT
ROOM 414 - CA 8-2665
429 S. W. FOURTH AVENUE
PORTLAND, OREGON 97204