

33668

T.37S. R.6W. W.M.

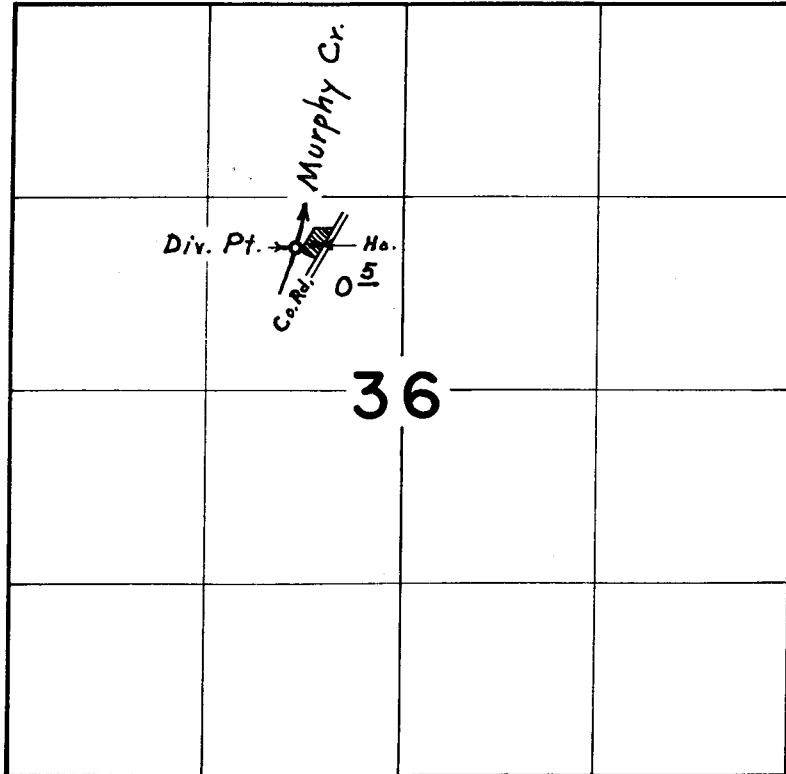

*Div. Pt. located 340' S. & 730' W. from N.E. Cor. S.E. & N.W. 1/4 Sec. 36*

**FINAL PROOF SURVEY**  
UNDER

Application No. 45053 Permit No. 33668  
IN NAME OF

ARTHUR L. & JUNE E. SHARP

Surveyed Sept. 17, 1975, by L. E. Gould