

RECEIVED
 JUL 9 1968
 STATE ENGINEER
 SALEM, OREGON

T.4N., R.37E.W.M.
 Sec. 26

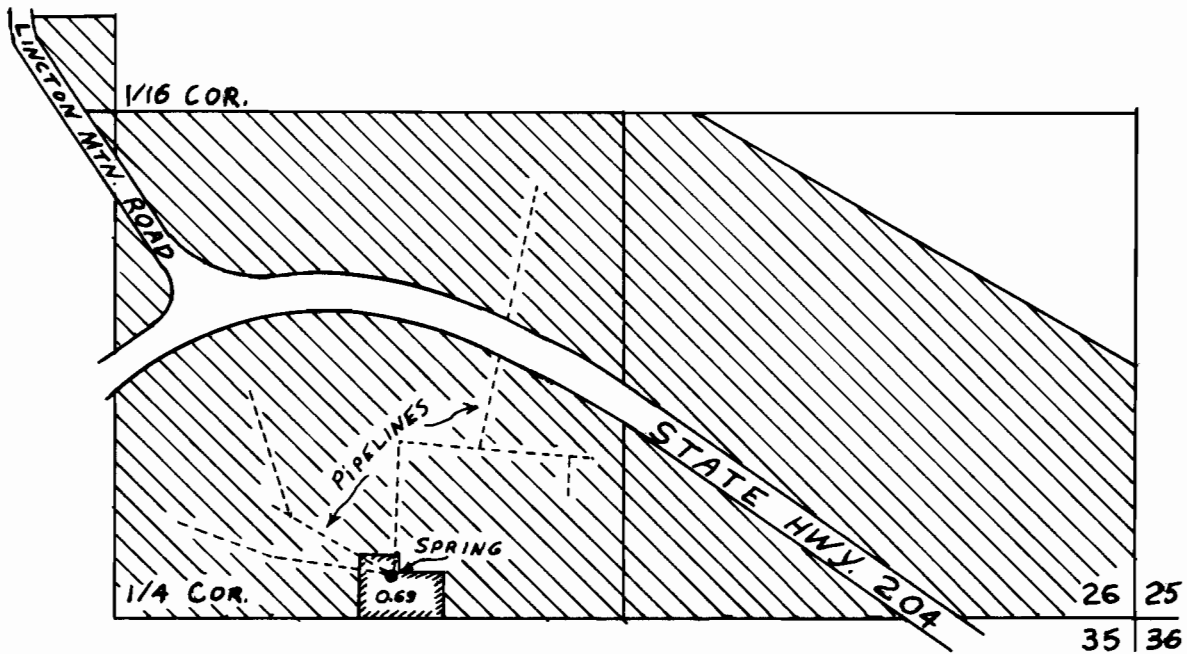

SPRING LOCATION:
 105' N. & 710' E. OF S. 1/4 COR.
 Sec. 26, T.4N., R.37E.W.M.

1" = 500'
 ▨ CABIN AREA
 ▩ CORP. PROPERTY

MAP TO ACCOMPANY APPLICATION
 TO APPROPRIATE WATER
 SOURCE - A SPRING
 TRIANGLE CAMP SPRING INC.

Application No. 45151
 Permit No. 33933