



Shaded Area being IRR. w/out wright and
 is included in application.
 Class A+B has original wright + should not
 be included in present application.
 Dotted lines are land class. divisions +
 usually are land contours
 The 19.4 Acres outlined in Red is C1. A+B +
 does have the original right. It should be
 deleted from this application.
 Roger N.

RECEIVED
 MAR 10 1969
 STATE ENGINEER
 SALEM, OREGON

Section 15
 T.11S, R.13E W.M.
 0 400 800
 SCALE IN FEET

T. 11 S. R. 13 E. W.M.

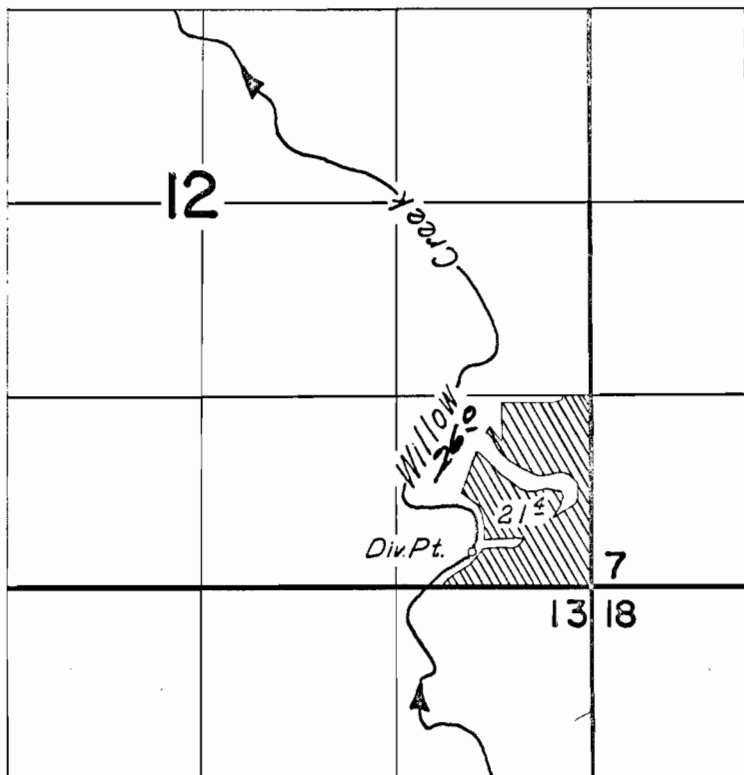

FINAL PROOF SURVEY UNDER

Application No. 33032... Permit No. 26182...
IN NAME OF

LARRY & PEGGY LANDGRAVER.

Surveyed Oct. 22 1962, by T.R. Lauer.....

T. 11 S. R. 13 & 14 E. W. W.

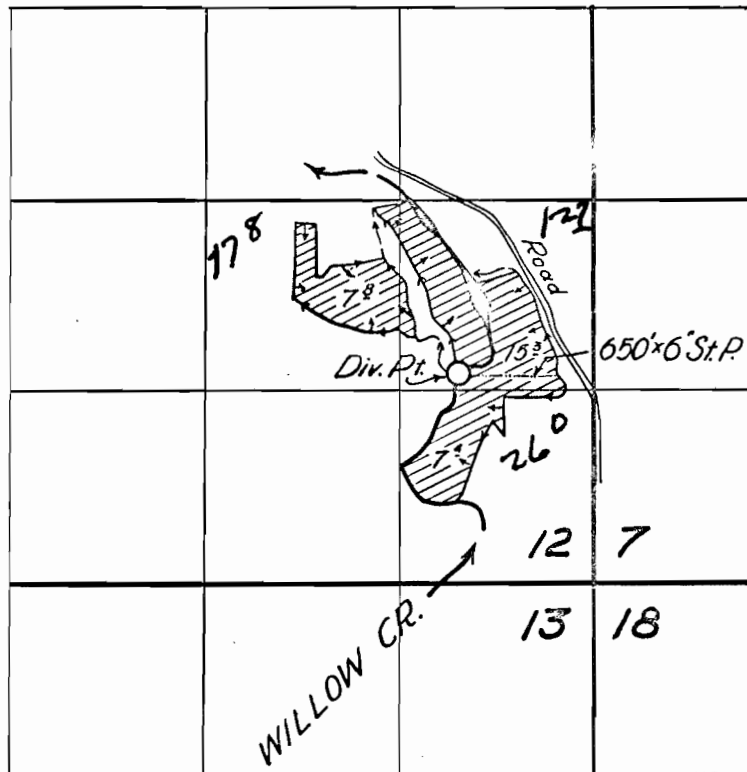

FINAL PROOF SURVEY

UNDER

Application No. 26247 Permit No. 20607

IN NAME OF

JOE & DOROTHY SLAVENS

Surveyed 3 Oct. 1955, by

DOU-4H-192

