

5647

3481

Map to accompany Application # 5647 Permit #
to appropriate the public waters of the State of Oregon in
Section 21 Tp. 2. S. R. 3. W. of the Will. Mar. Ore. creek known as
Ayres branch dam across same at point 1799.1 ft. East and 6.0 ft.
North of stone of N.W. Cor. of John Brisbine D.L.C. Not. # 5885 Claim
53 and computed as $N42^{\circ}12'W$ 2419.0 ft. from the S.E. corner of
said Section 21 in said Township and Range

Branch flowed $\frac{3}{10}$ of 1 cu. ft. per Second on Aug. 10 1917.
Application for $\frac{2}{10}$ of 1 cu. ft. for domestic use and irrigation
of approximately 15 acres lying in the S.E. $\frac{1}{4}$ of S.E. $\frac{1}{4}$ and the
S.W. $\frac{1}{4}$ of the S.E. $\frac{1}{4}$ of Section 21 Tp. 2. S. R. 3. W.

Service pipe 2" reduced to 1 $\frac{1}{4}$ " at residence and barn
Overflow over dam. Head gate to be on south side of dam
and flow into open ditch

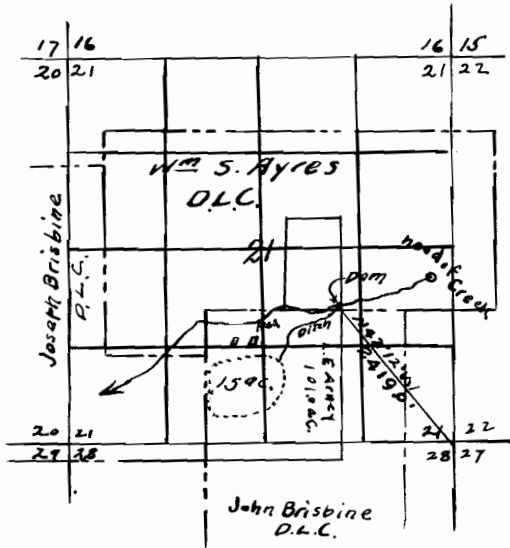

Surveyors Certificate

I, H.W. Herring of Mc Minnville, Oregon,
do hereby certify that this Map was made from
notes taken during an actual survey made by me
on the 10th day of August 1917 that it
correctly represents the works described in the
accompanying application

H. Herring
Surveyor

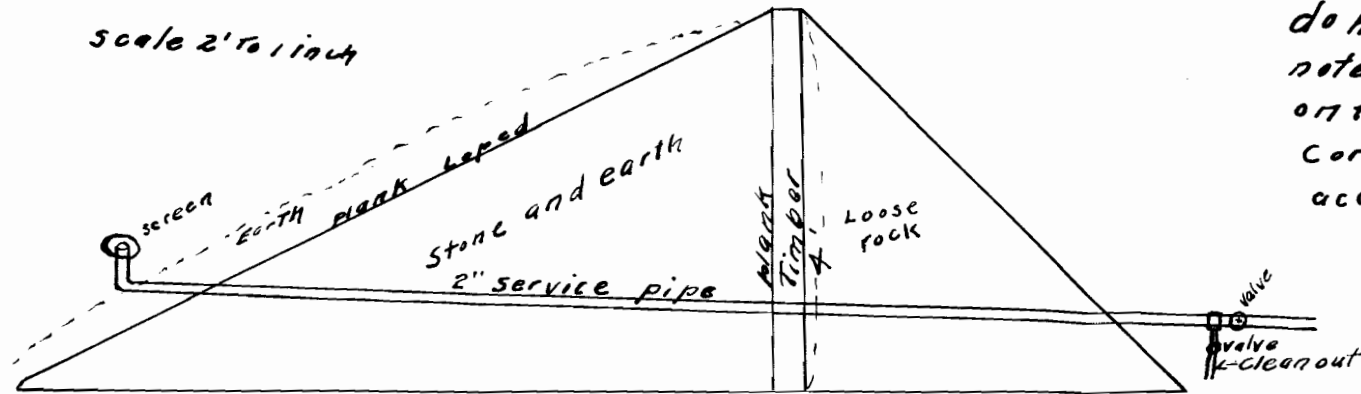

Scale 2" to 1 inch