

APPLICATION NO. 5485,
ADDIE A. CARNES,
NORTH POWDER, OREGON.

Township 6 South,

Range 39 E.M.

272

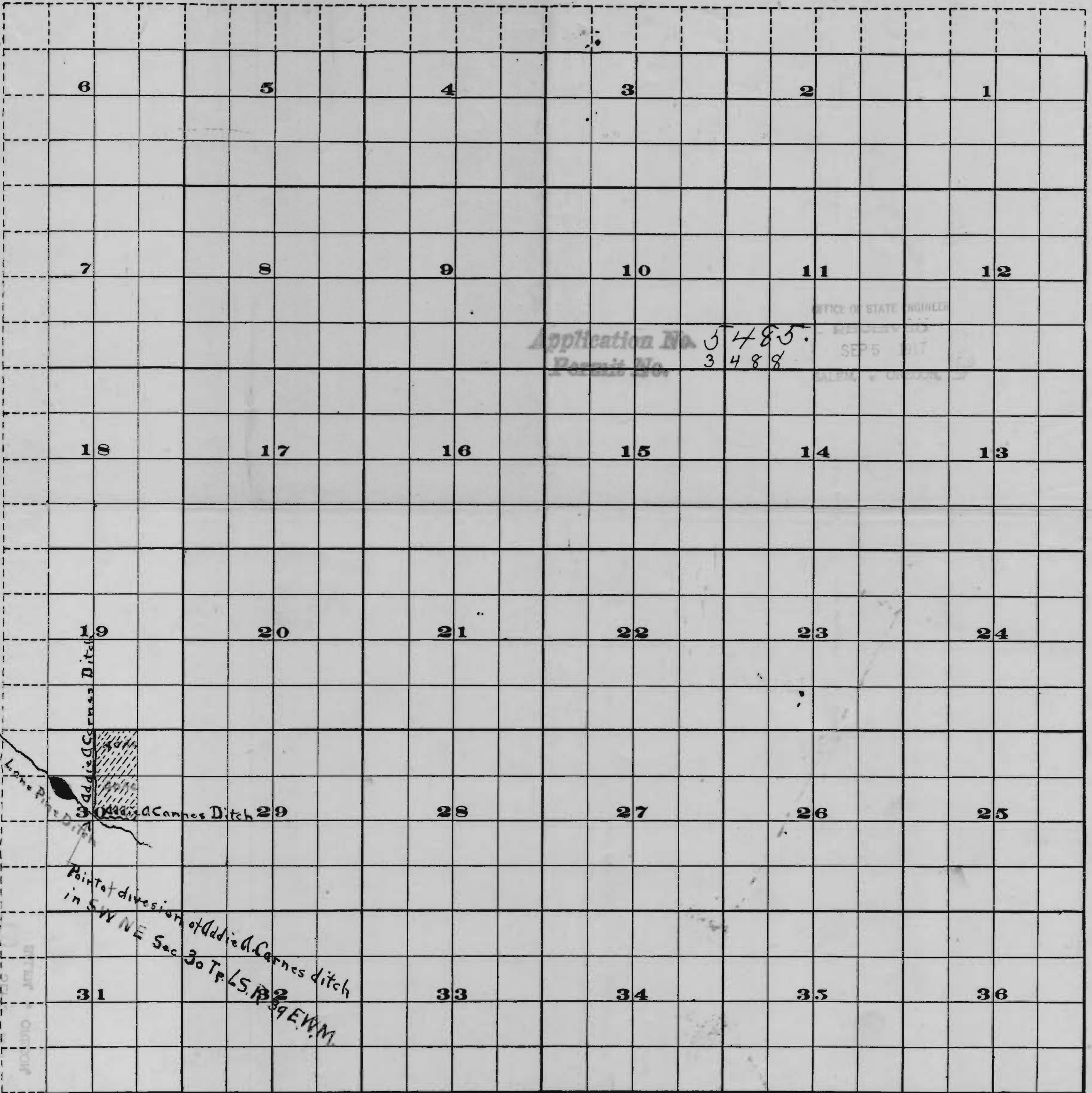

Application No. 5485.
Permit No. 3488

OFFICE OF STATE ENGINEER
SEP 5 1917

RECEIVED
OFFICE OF STATE ENGINEER
SEPT 10 1917



Scale of Feet.

FROM OFFICE OF THE STATE ENGINEER, SALEM, OREGON

272

APPLICATION NO. 5485.
ADDIE A. CARNES,
NORTH POWDER, OREGON.

Township 6 South, Range 38 E. W.M.

2722

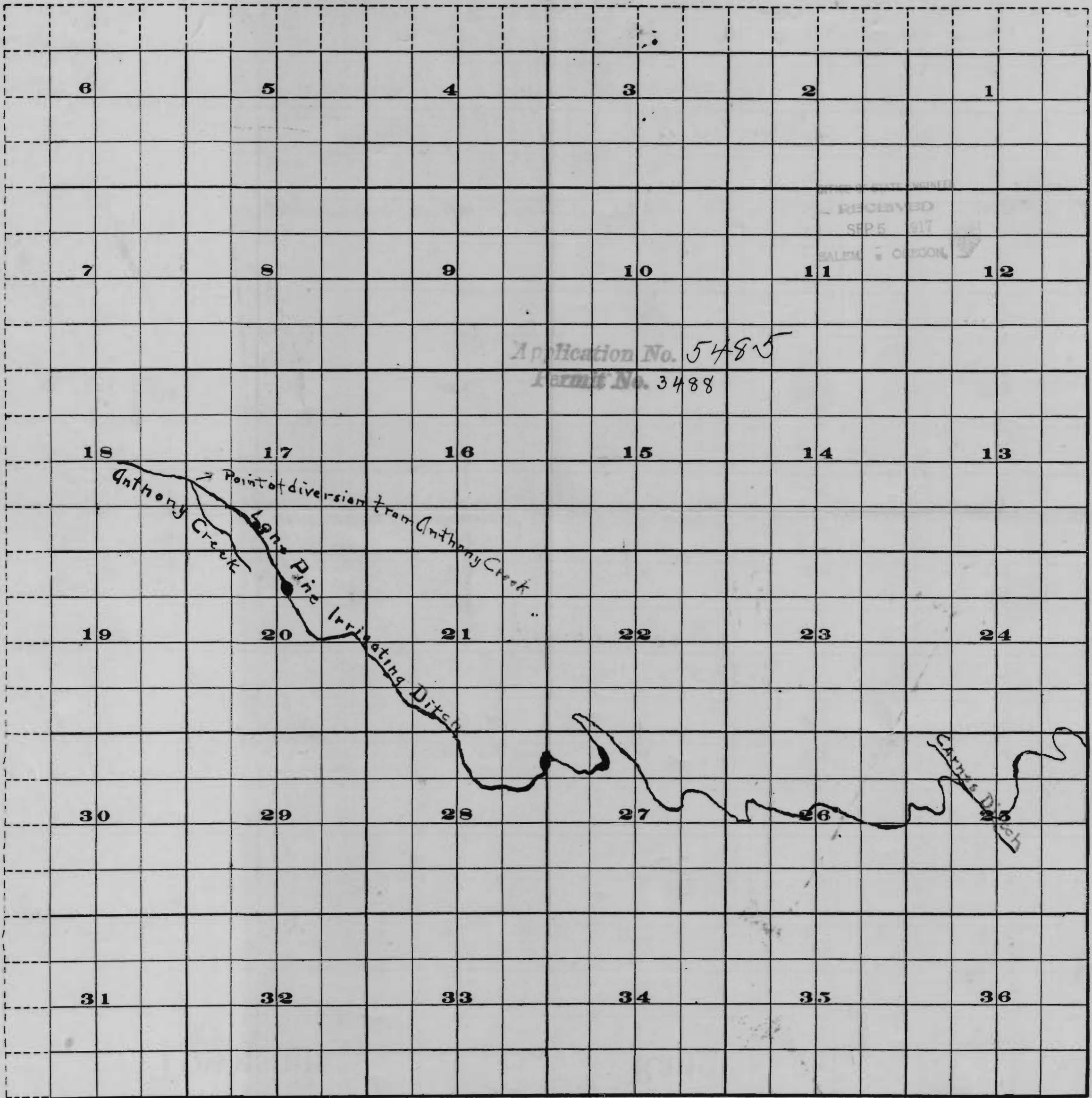

Application No. 5485
Permit No. 3488

RECEIVED
SEP 5 1917
SALEM, OREGON

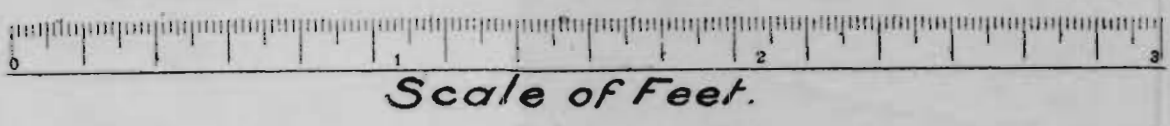

2722