

Parts of Townships 2<sup>nd</sup> and 3<sup>rd</sup> N., Range 39 E. W. M.

2250

2250

RECEIVED  
SEP 13 1911  
OFFICE OF STATE ENGINEER

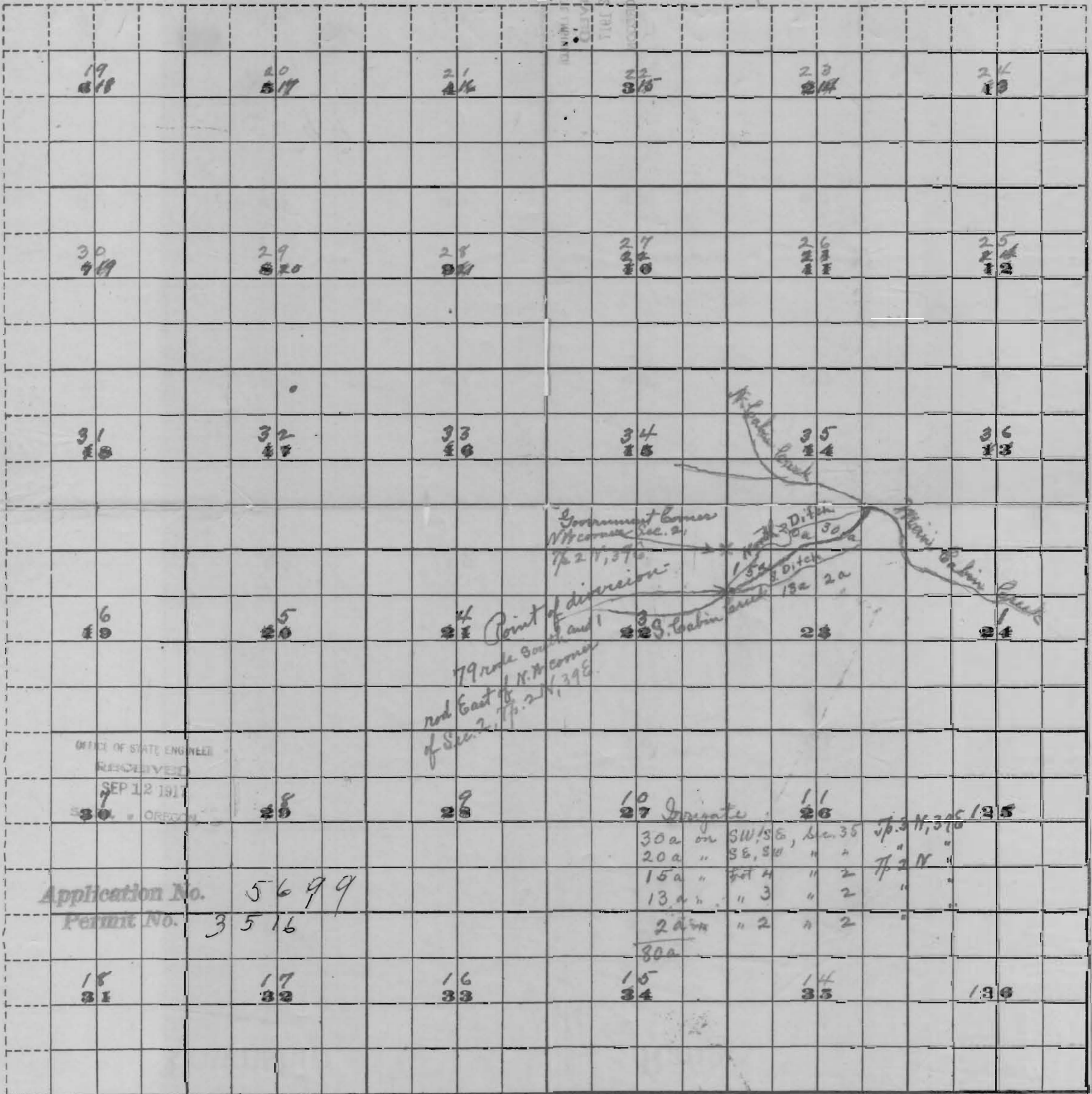

OFFICE OF STATE ENGINEER  
RECEIVED  
SEP 12 1911  
30 OREGON

Government Corner  
N.W. corner Sec. 2,  
T. 2 N., R. 39 E.  
Point of diversion  
79 rods South and  
rod East of N.W. corner  
of Sec. 2, T. 2 N., R. 39 E.



2250

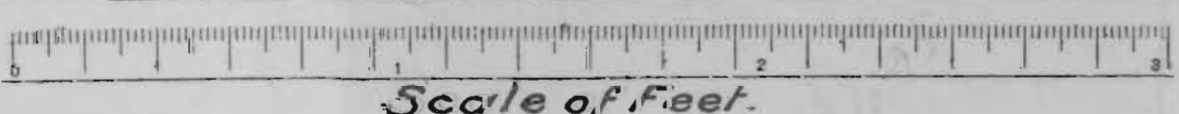

2250