

MAP

Accompanying Application of W.S. Noyes of Tolo Oregon
for permit to appropriate the waters of Bear Creek
tributary to Rogue River Jackson County Oregon.

June 1917

Tp 36. S. R. 2 W. W. M.

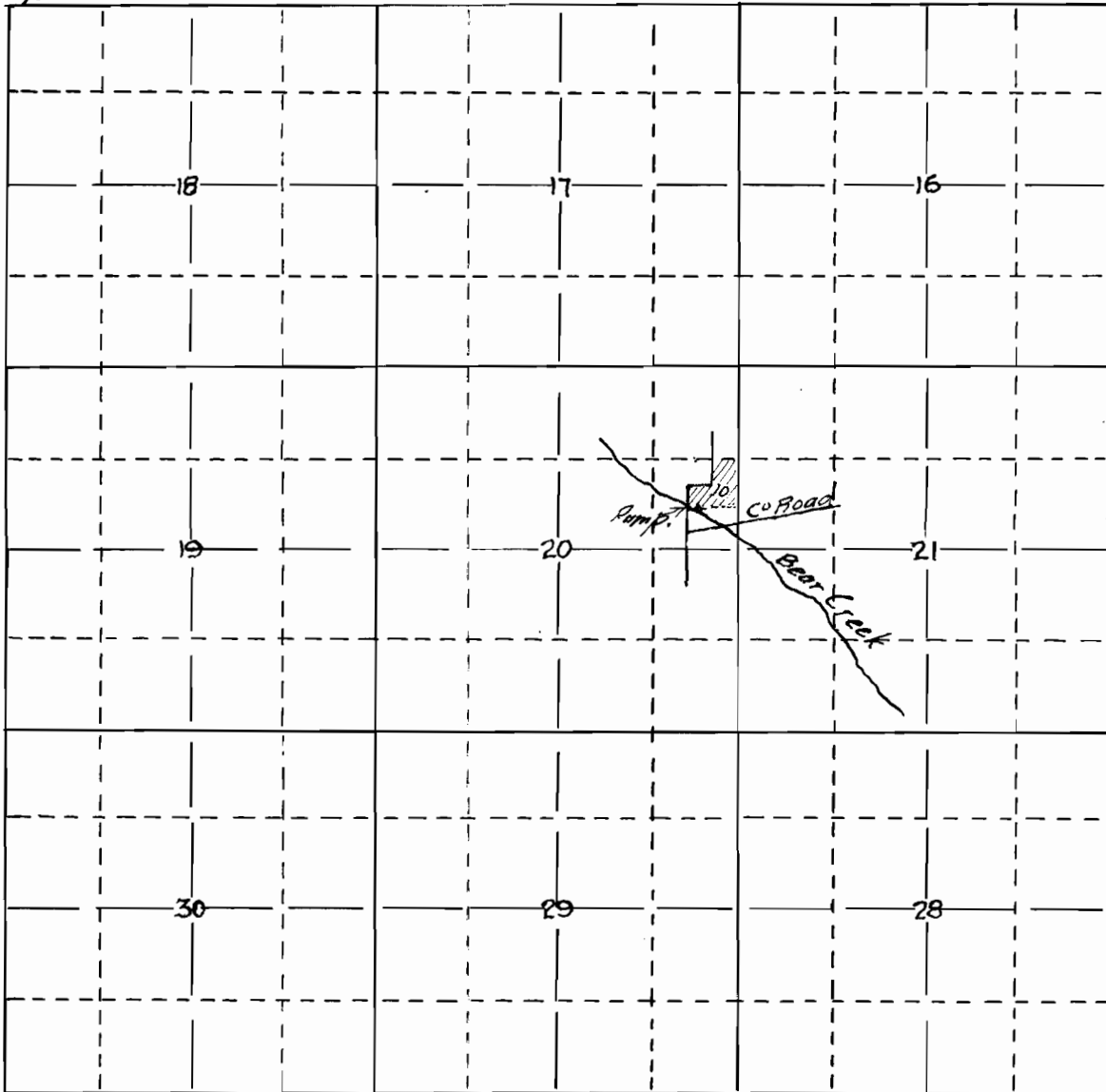

Map made from notes furnished with plat by M. E. L. March
of Tolo, Oregon, correctly showing lands to be irrigated
and location of pumping plant.

Fred. N. Cummings.
Medford, Oregon.

5601
3526