

App 5702  
Per 3541

Township No 29 South  
R 4 W

Range No 4 West

2505

2505

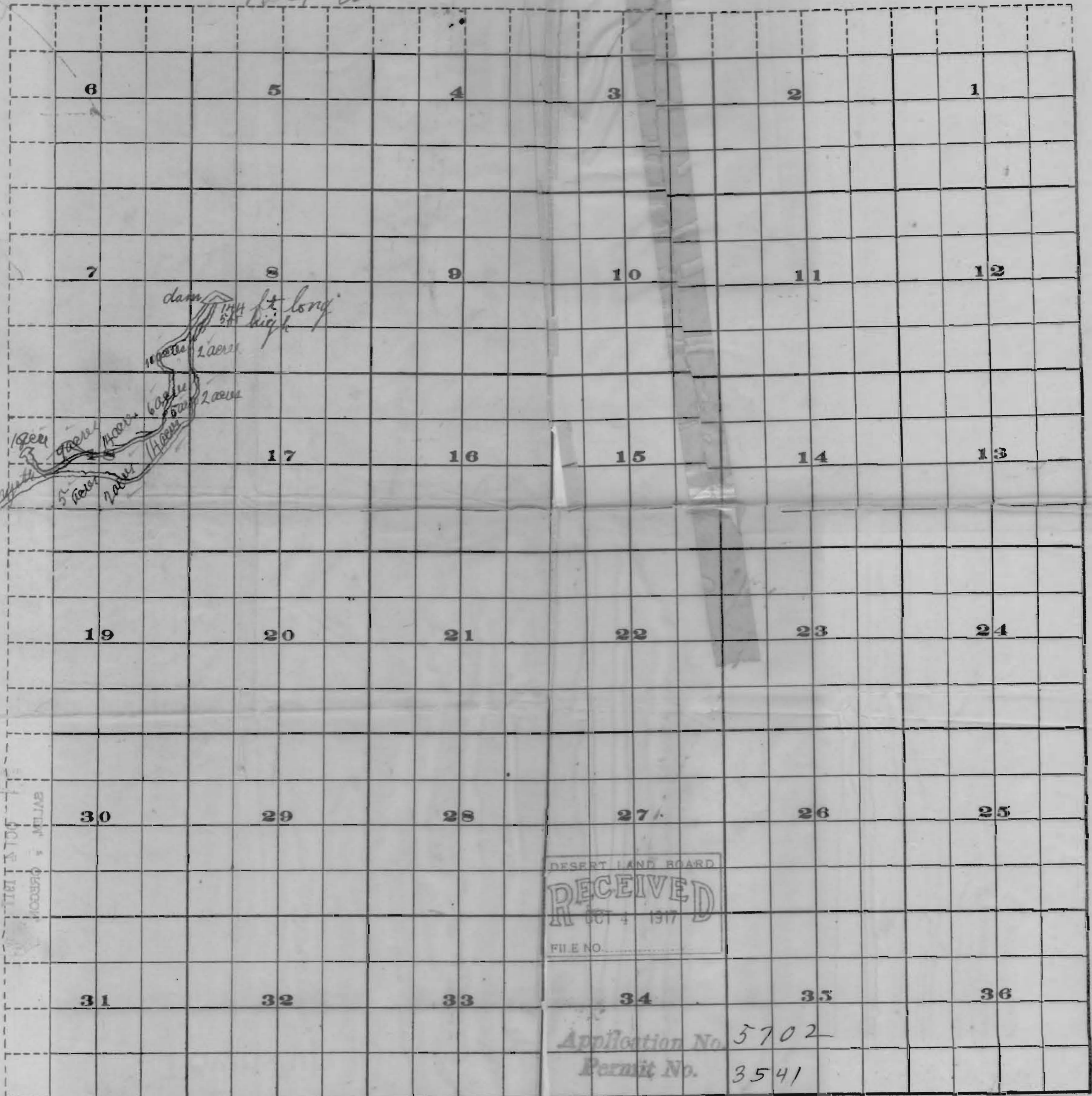

RECEIVED  
OCT 4 1917  
OFFICE OF STATE ENGINEER  
MILWAUKEE OREGON

DESERT LAND BOARD  
RECEIVED  
OCT 4 1917  
FILE NO.

Application No. 5702  
Permit No. 3541

FROM OFFICE OF THE STATE ENGINEER, MALEM, OREGON

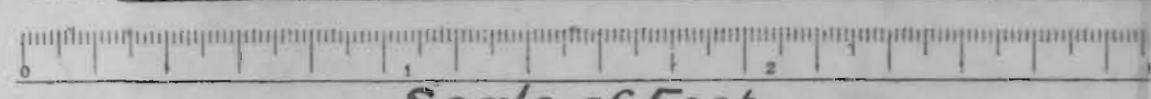

Scale of Feet

2505

2505