

RECEIVED
STATE ENGINEER
SALT LAKE COUNTY

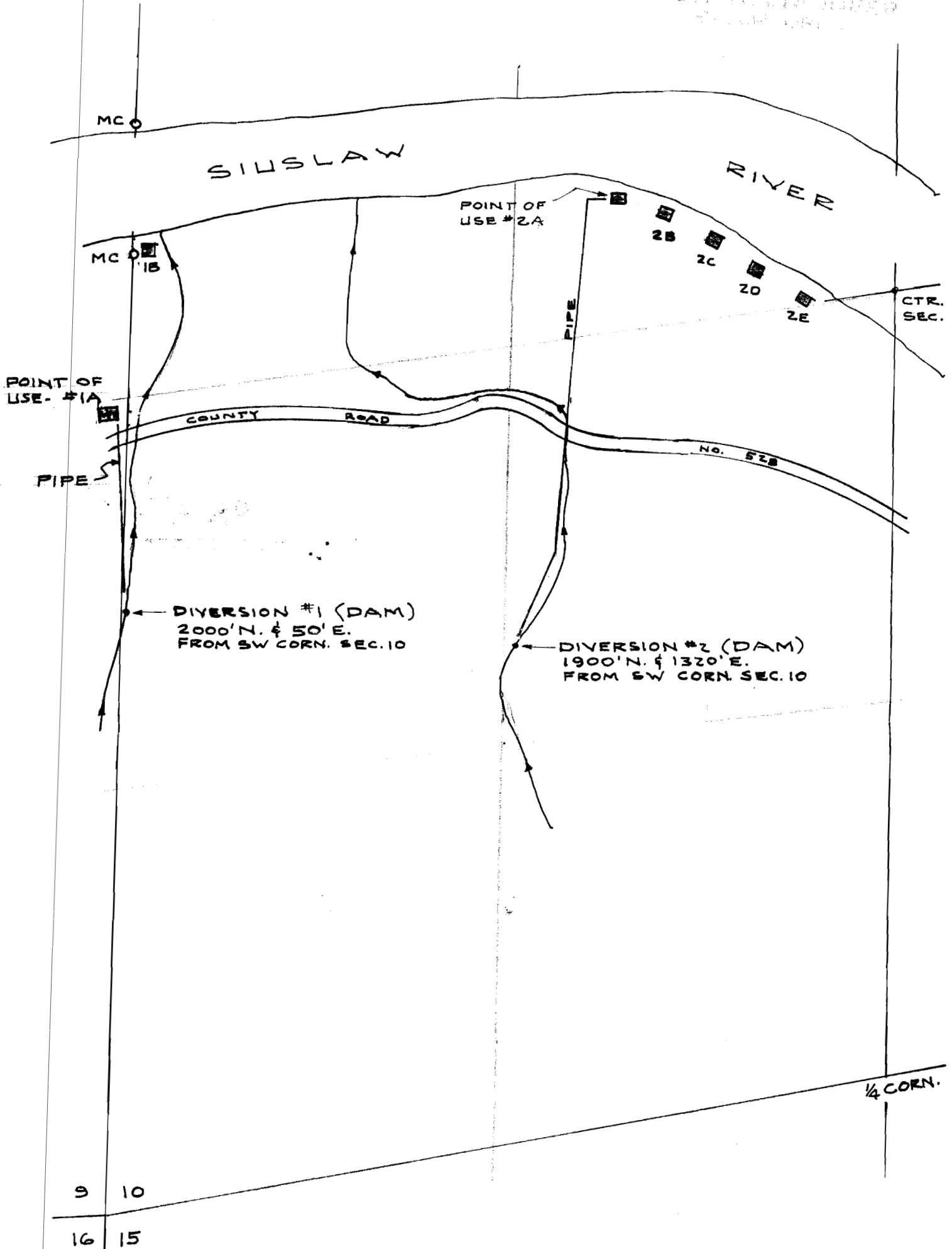

RECEIVED
STATE ENGINEER
SALT LAKE COUNTY

WATER RIGHTS MAP
HAROLD T. WASHBURN
SCALE 1" = 400' SEPT. 1971
SEC. 10 & 9 T18S R10W W.M.
LANE CO., OREGON.

Application No. 48239, 48240
Permit No. 35714, 35715