

RECEIVED  
FEB 1 1971  
STATE ENGINEER  
SALEM, OREGON

1/4 COR.

RECEIVED  
JUN 21 1971  
STATE ENGINEER  
SALEM, OREGON

RECEIVED  
MAY 3 1971  
STATE ENGINEER  
SALEM, OREGON

1/4 COR.

CENTER SECTION II  
T19S R12W WM

WATER RIGHTS MAP  
FOR FORREST & LENTELL  
SCALE 1"=200'  
NOV. 1970

W O A  
W H O H I N K  
L A K E

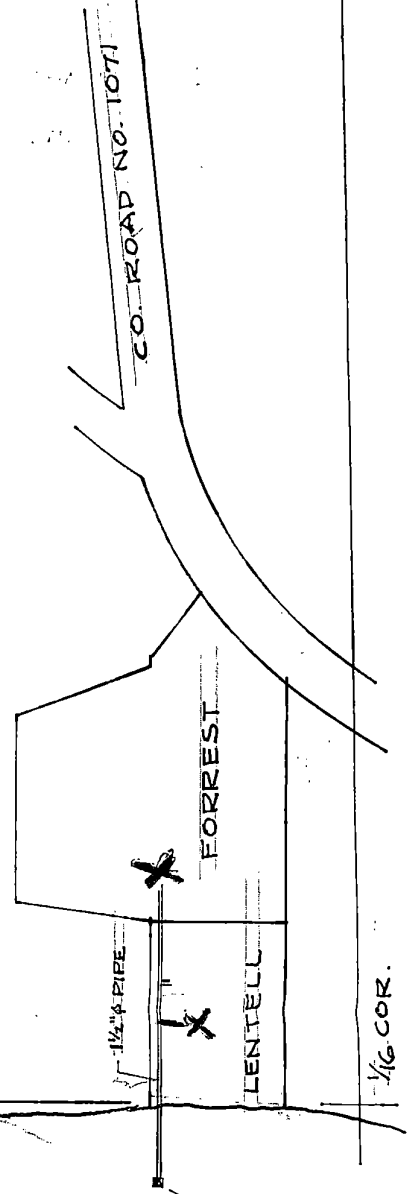

SUBMERGED INTAKE  
& PUMP  
(1020'S ± 90' W.  
OF CTR. OF SEC. 11)

1/4 COR.