

T1S, R45E.W.M.

**RECEIVED**  
 FEB 24 1972  
 STATE ENGINEER  
 SALEM, OREGON

Application No. 49012  
 Permit No. 36072

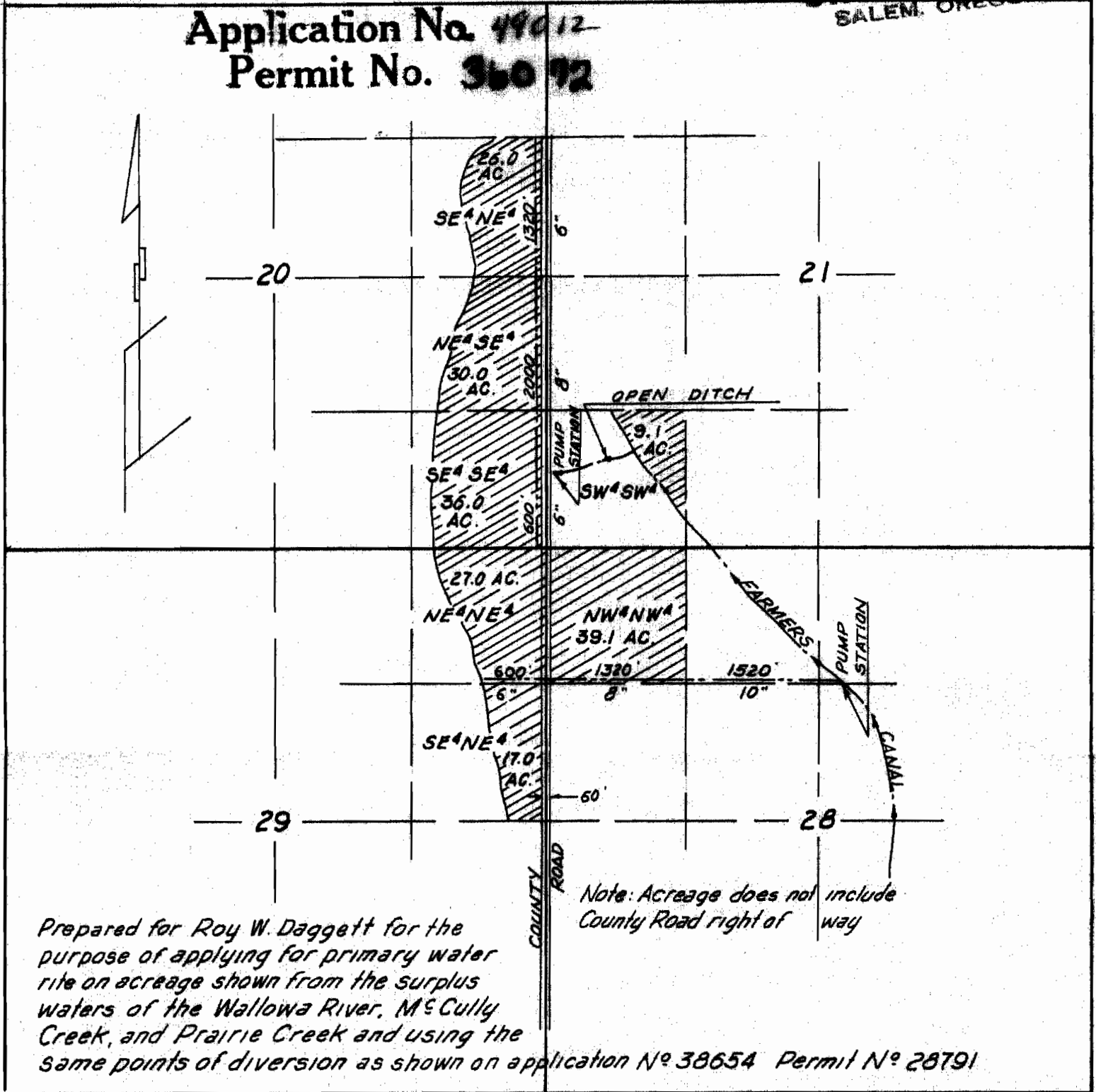

Prepared for Roy W. Daggett for the purpose of applying for primary water rite on acreage shown from the surplus waters of the Wallowa River, Mc Cully Creek, and Prairie Creek and using the same points of diversion as shown on application No 38654 Permit No 28791

Note: Acreage does not include County Road right of way

SCALE: 4" = 1 MILE

**Summary of acreage:**

Sec. 20	Sec. 21	Sec. 29
SE <sup>1</sup> / <sub>4</sub> NE <sup>1</sup> / <sub>4</sub> 26.0 ac.	SW <sup>1</sup> / <sub>4</sub> SW <sup>1</sup> / <sub>4</sub> 9.1 ac.	NE <sup>1</sup> / <sub>4</sub> NE <sup>1</sup> / <sub>4</sub> 27.0 ac.
NE <sup>1</sup> / <sub>4</sub> SE <sup>1</sup> / <sub>4</sub> 30.0 "	Sec. 28	SE <sup>1</sup> / <sub>4</sub> NE <sup>1</sup> / <sub>4</sub> 17.0 ac.
SE <sup>1</sup> / <sub>4</sub> SE <sup>1</sup> / <sub>4</sub> 36.0 "	NW <sup>1</sup> / <sub>4</sub> NW <sup>1</sup> / <sub>4</sub> 39.1 ac.	<b>TOTAL = 124.2 acres</b>

**POINTS OF DIVERSION**

Wallowa River bears S68°58'E, 1968.7 feet from NW Cor. Sec. 5, T3S, R45E.W.M.  
 Mc Cully Creek bears N76°00'W, 1462 feet from SE Cor. Sec. 2, T2S, R45E.W.M.  
 Prairie Creek bears N63°39'W, 2337 feet from South 1/4 Cor. Sec. 26, T2S, R45E.W.M.

Prepared by Verne H. Russell - Reg. Surveyor - Oregon 427  
 Date: January 19, 1972