

— MAP —

Accompanying application of N. S. JOHNSTON of Rogue River, Jackson County, Oregon. for permit to appropriate the flood and surplus waters of Pleasant Creek, and Frys Gulch tributary to Rogue River, Jackson County Oregon.

— November 1917. —

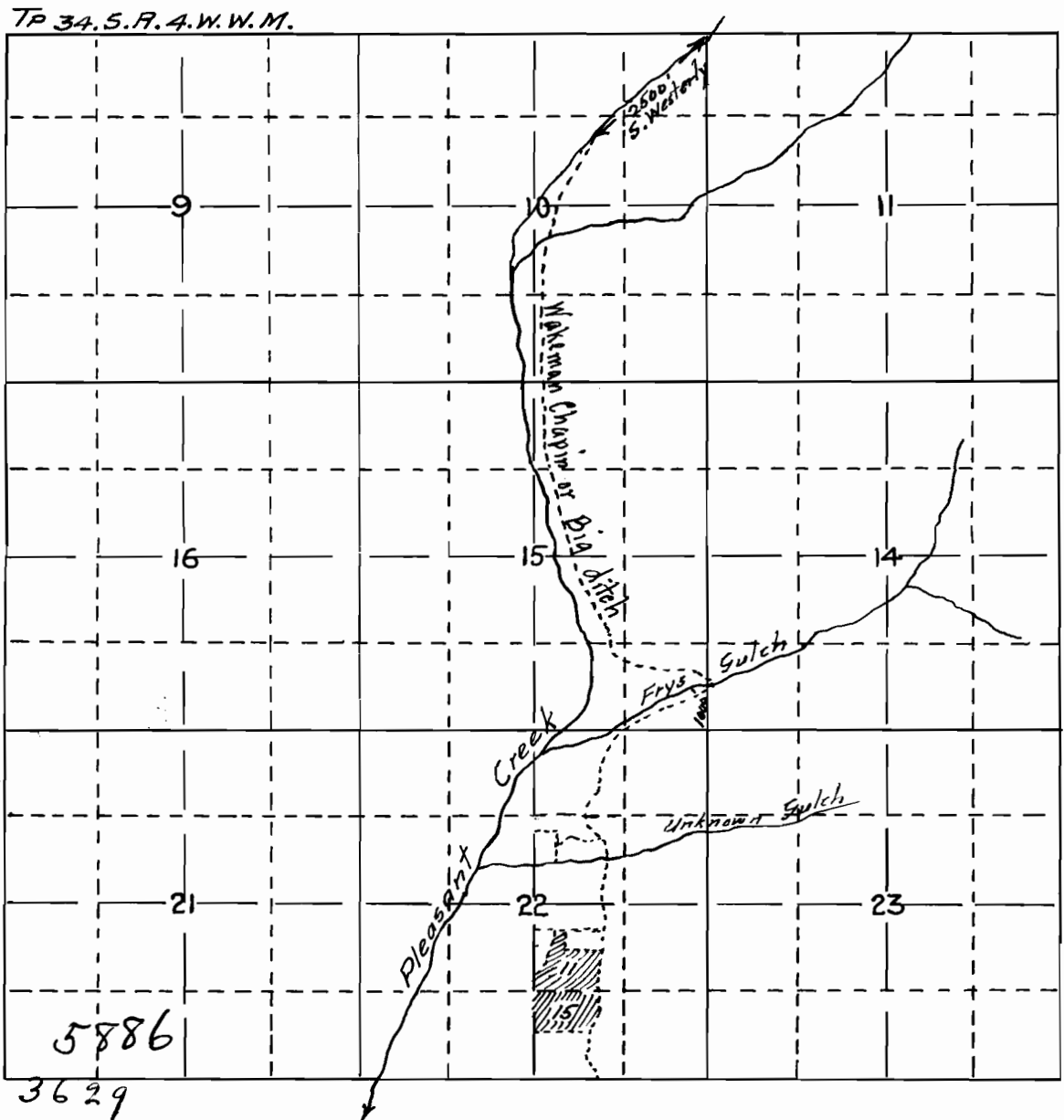

Map made from notes of an actual survey in the field by V. T. McCray, C.E. correctly showing lands to be irrigated, streams, and ditches in immediate vicinity.
Compiled by.

— Fred. N. Cummings, C.E. —