

Division 2
Division 1

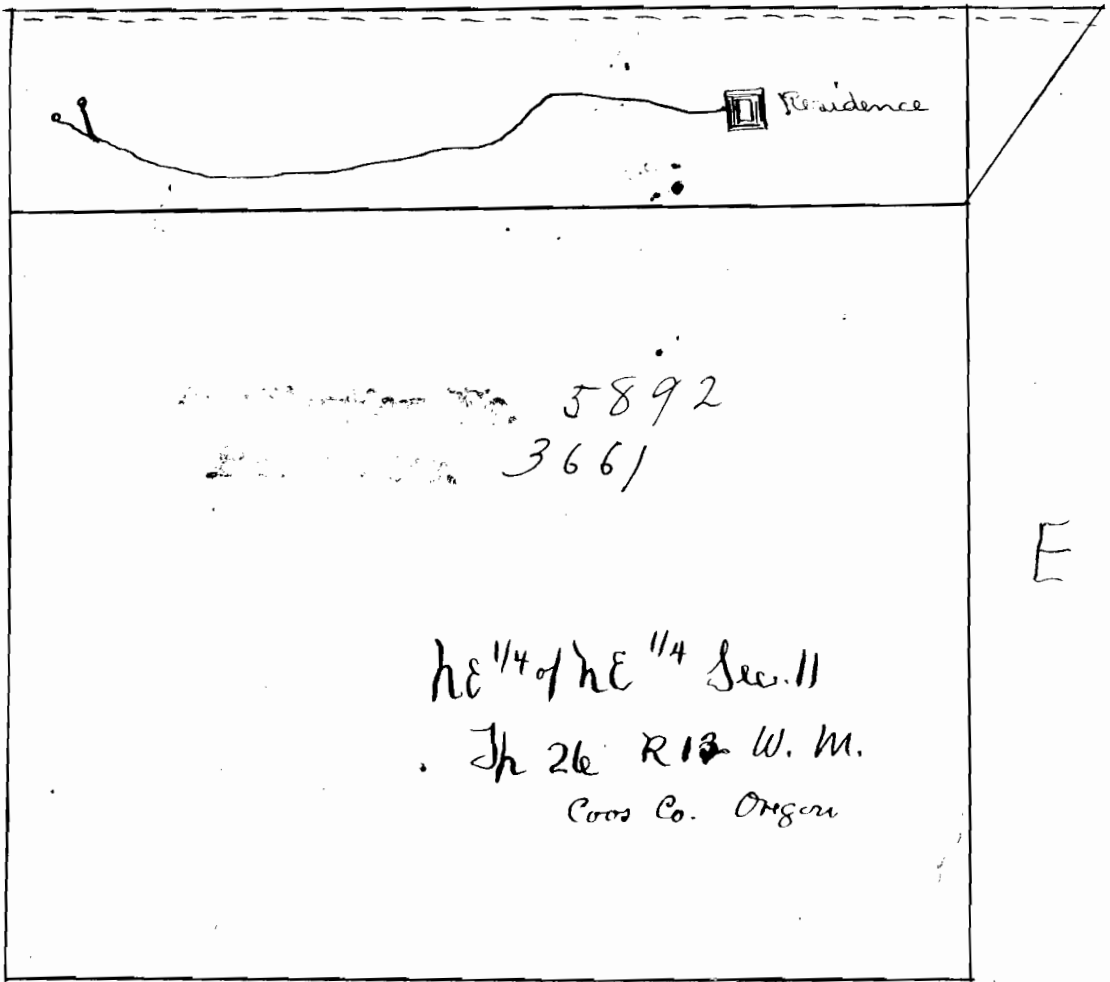

W.

5892
3661

NE 1/4 of NE 1/4 Sec. 11
T. 26 S. R. 13 W. M.
Coos Co. Oregon

E

S

Dotted line represents North line of E.H. Smith parcel.

Pipe line indicated in red ink.

Map submitted by E.H. Smith of Marshfield, Oregon, with his Application for permit to appropriate waters in ^{NE 1/4 of NE 1/4} Section 11 and 12, Township 26 S. R. 13 W., Coos County, Oregon. The date of the application is 10/10/1913.