

ES

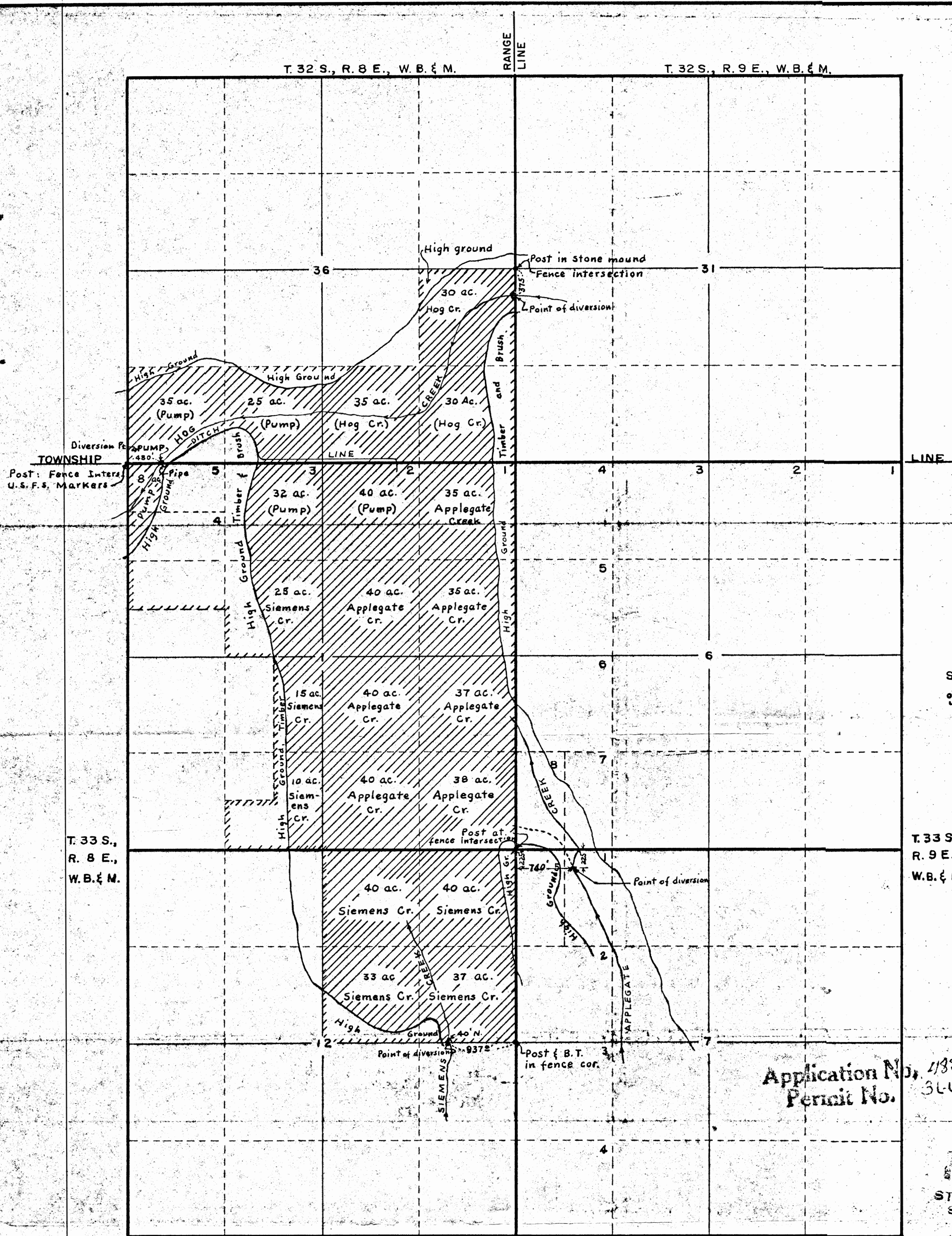

T. 33 S.,
R. 8 E.,
W.B. & M.

T. 33 S.,
R. 9 E.,
W.B. & M.

SCALE: 1" = 1000'

Application No. 118890
Permit No. 36629

RECEIVED
OCT 26 1971
STATE ENGINEER
SALEM, OREGON

LEGEND

Cross hatched areas indicate marsh, or meadow, lands of UPPER KLAMATH MARSH. Sod, or turf, overlay on volcanic ash, or Pumice, base.

REGISTERED
OREGON
LAND SURVEYOR
Julian M. Ager
October 15, 1953
JULIAN M. AGER
383

MAP OF SURVEY

WATER RIGHT APPLICATION

SIEMENS, APPLIGATE, & HOG CREEKS

NE 1/4 SECTION 12, E 1/2, SW 1/4 SE 1/4 SW 1/4, E 1/2 E 1/2 SW 1/4, SE 1/4 NW 1/4, N 1/2 SW 1/4 NW 1/4,
AND LOTS 3, 4, & 5, IN SECTION 1, ALL IN TOWNSHIP 33 SOUTH, RANGE
8 EAST, WILLAMETTE BASE & MERIDIAN; S 1/2 S 1/2 AND NE 1/4 SE 1/4 SECTION
36, T. 32 S., R. 8 E., W.B. & M.; LOT 8, SECTION 6, LOT 1 AND SE 1/4 NW 1/4
SECTION 7, T. 33 S., R. 9 E., W.B. & M., KLAMATH COUNTY, OREGON.

SURVEYED FOR	BERTLAND N. STANLEY
SURVEYED BY	JULIAN M. AGER
DRAWN BY	J. M. A.
SCALE	1" = 1000'
DATE	OCTOBER 26, 1971

T. 33 S., R. 9 E., W.B. & M.

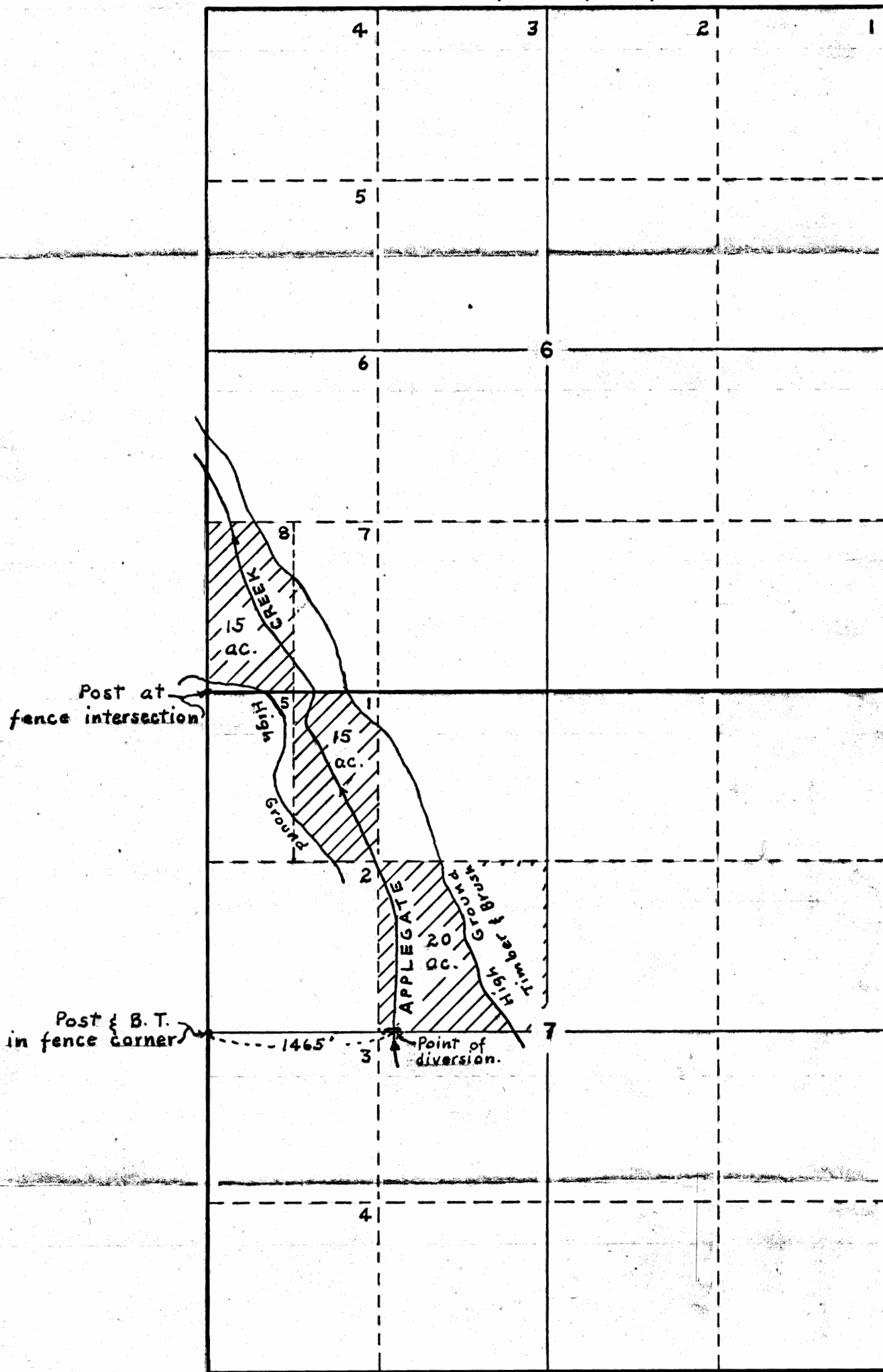

SCALE: 1" = 1000'

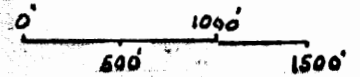

RECEIVED
FEB 17 1972
STATE ENGINEER
SALEM OREGON

RECEIVED
DEC 10 1971
STATE ENGINEER
SALEM OREGON

Application No. 48890
Permit No. 36629

LEGEND

Cross hatched areas indicate marsh, or meadow, lands of UPPER KLAMATH MARSH. - Sod, or turf, overlay on volcanic ash, or Pumice, base.

REGISTERED
OREGON
LAND SURVEYOR
Julian M. Ager
October 15, 1956
JULIAN M. AGER
383

MAP OF SURVEY
WATER RIGHT APPLICATION

APPLEGATE CREEK

LOT 8, SECTION 6; LOT 1 & SE 1/4 NW 1/4 SECTION 7,
ALL IN TOWNSHIP 33 SOUTH, RANGE 9 EAST, OF
THE WILLAMETTE BASE & MERIDIAN, KLAMATH
COUNTY, OREGON.

SURVEYED FOR	BERTLAND N. STANLEY
SURVEYED BY	JULIAN M. AGER
DRAWN BY	J. M. A.
SCALE	1" = 1000'
DATE	OCTOBER 26, 1971