

N. 15° E. - 1952

R. 31 E.

1918

5926
3663

T. 16 S.

SCALE - 4" = 1 MI.
LEGEND

applied for.   adjudicated land

PLAT
of
POWELL DITCH No. 1
H. W. Powell, Canyon City, Ore.
Appropriator.

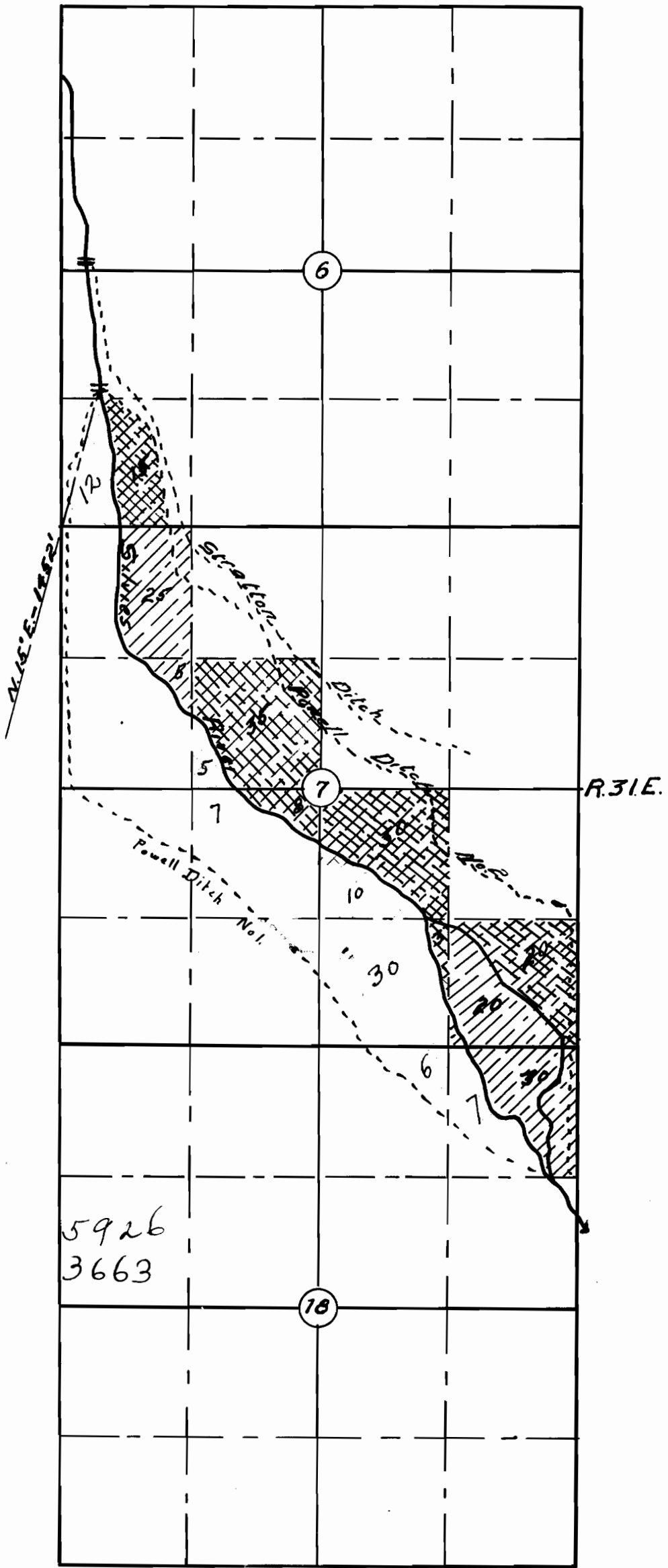

1918

5926
3663

T. 16 S.

SCALE 4" = 1 MI.
LEGEND

applied for  adjudicated land 

PLAT of
POWELL DITCH. No. 2
H. W. Powell, Canyon City Ore
Appropriator.