

MAP OF PROPOSED WATER SYSTEM FOR THE TOWN OF SUMNER GOOS COUNTY OREGON.

Sections No 29 & 32
T. 26. S. R. 12. W. Will. Mer.

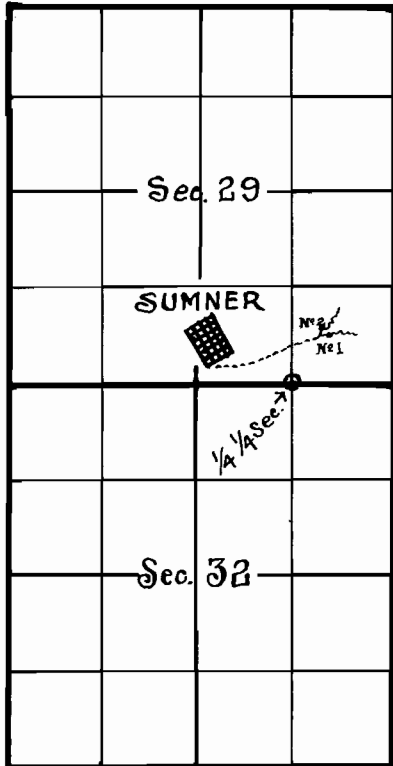

State of Oregon }
County of Coos } S.S. I S.B. Cathcart of Marshfield Oregon hereby certify that this map was made from notes taken during an actual survey made by me December 15th 1917, and that it correctly represents the position of the diverting point of the water from the two small unnamed streams, both of which points are in the S.E. 1/4 of the S.E. 1/4 of Section 29. T. 26. S. R. 12. W. of the Willamette Meridian. From diverting point No 1 the 1/4 1/4 sec. cor. on the ^{South} line of the S.E. 1/4 of said section 29 which said corner has been officially established, bears S 19° 4' West 8.15 chains. and from point No 2 it bears S 17° 20' West 8.45 chains. The dotted line shows approximately where the pipe line is located, but was not actually surveyed.

S B Cathcart

Surveyor.

5935
3682

Scale 2 inches = One mile.