

— MAP —

Accompanying application of HENRY A. MEYER of Lake Creek for permit to appropriate the waters of North Fork of Little Butte Creek tributary to Rogue River. Jackson County, Oregon.

— January, 1918. —

— Medford, Oregon. —

TP. 36. S. R. 2. E. W. M.

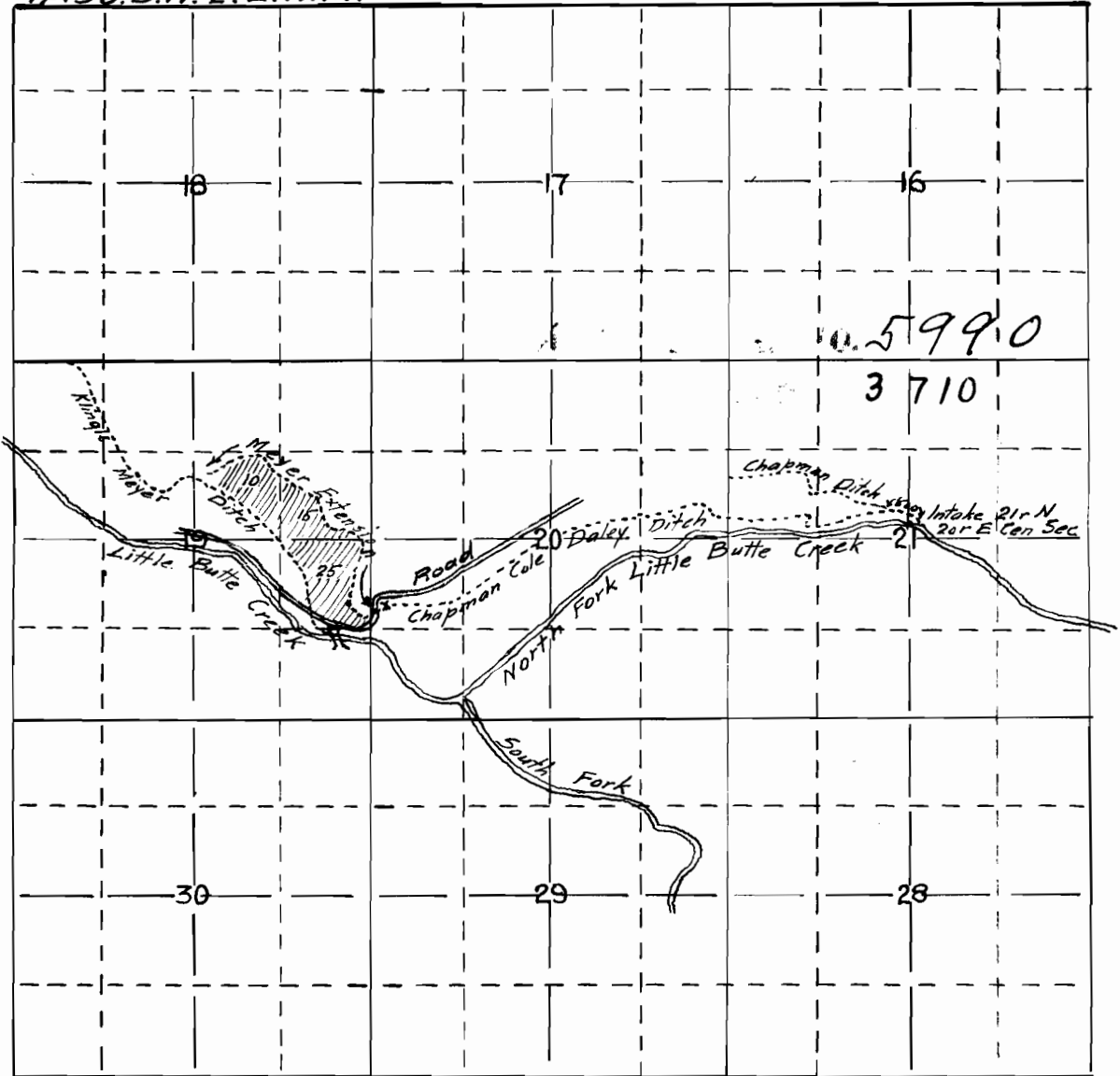

Map made from notes and measurements taken in the field by Henry A. Meyer and compiled from his plat & is a correct representation of lands to be irrigated streams and ditches in immediate vicinity

— Fred. N. Cummings, C.E. —