

T.37 S., R.5 W., W.M.

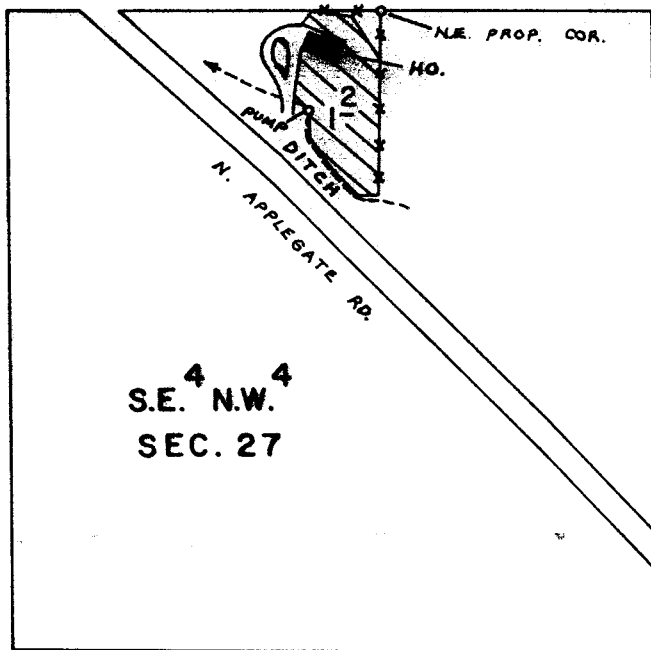

RECEIVED

MAR 27 1986

WM. DIST. 14
GRANTS PASS, OR.

SCALE: 1" = 400 FT.

T.38 S., R.4 & 5 W., W.M.

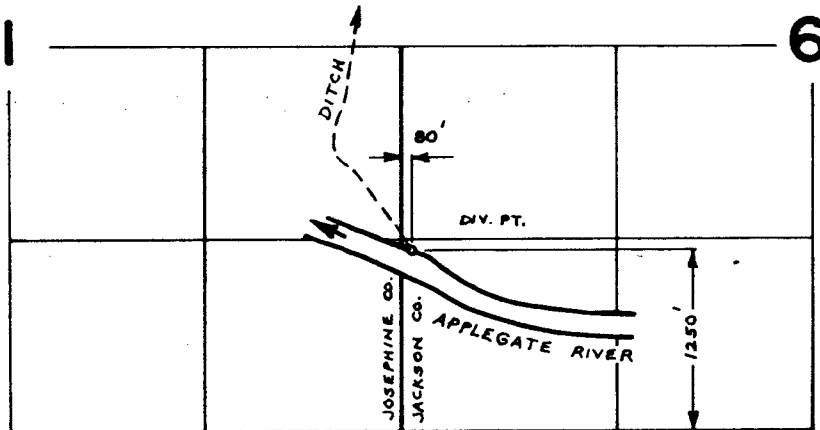

FINAL PROOF SURVEY
UNDER

Application No. 50766 Permit No. 37289
IN NAME OF

GERALD P. SORENSEN

Surveyed MAR. 29 1979, by B. SUND

D.H.M.
P.T.S.-1979-14-A
& P.T.S.-1967-V