

T-5457
37-7-9

T. 37 S., R. 7 W., W. M.

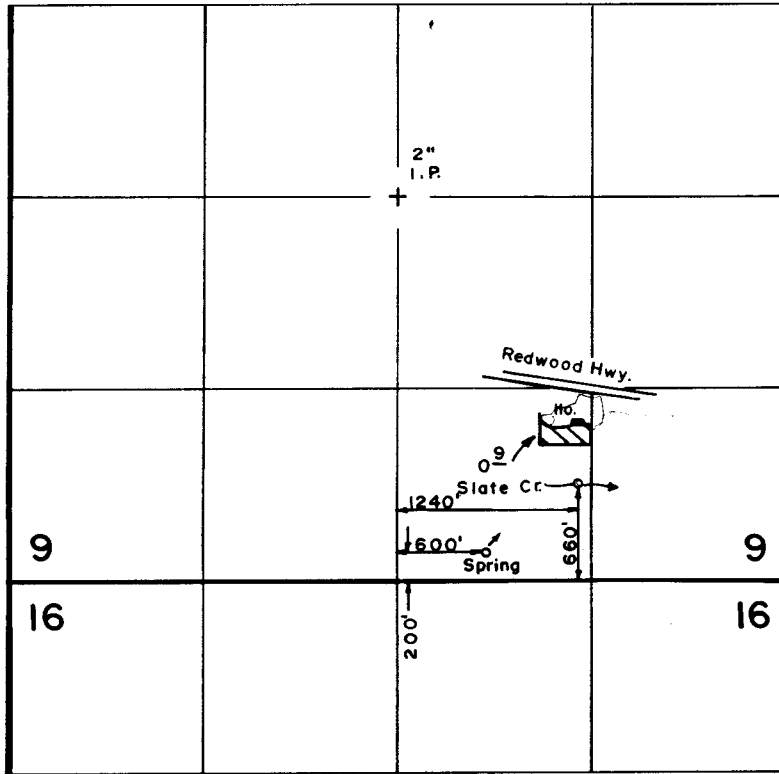

Scale: 1" = 1320'

FINAL PROOF SURVEY

UNDER

TRANSFERS NO. 5441 & 5457

Application No. Permit No.

IN NAME OF

.....RUSSELL.....J.....HUDSON.....

Surveyed JUL. 28, 1986, by B. S. JAMES.....

T. 37 S., R. 7 W., W.M.

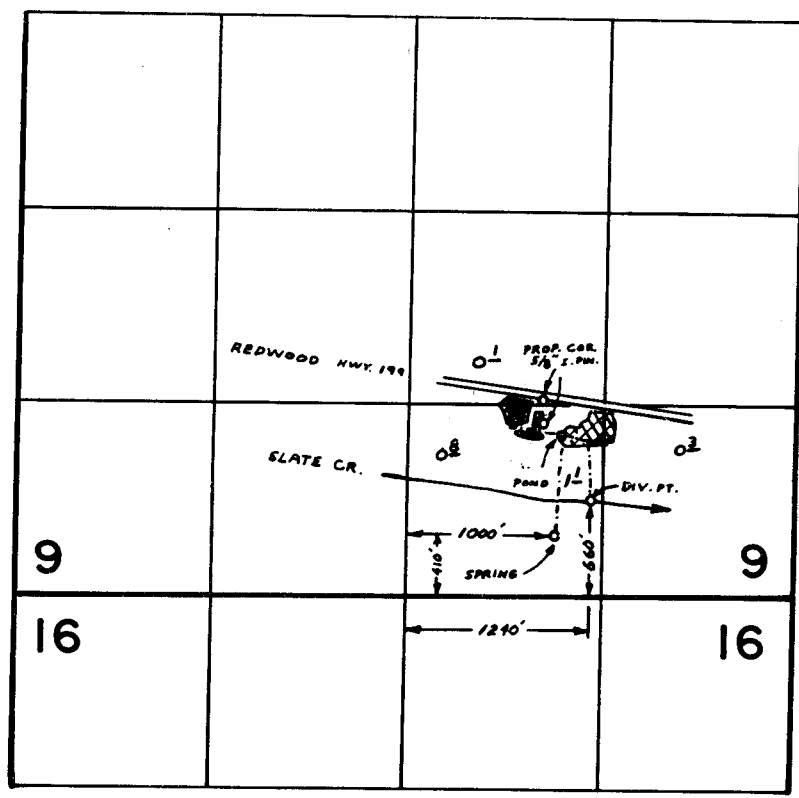

SLATE CREEK

SPRING

RECEIVED

JAN 19 1983

WM. DIST. 14
GRANTS PASS, ORE

FINAL PROOF SURVEY UNDER

C-51395

Application No. 50057 Permit No. 37624
IN NAME OF

RUSSEL J. HUDSON

Surveyed JUL. 27 1978, by B. SUND

P.T.S. -1978-14-C