

7 8
18 17

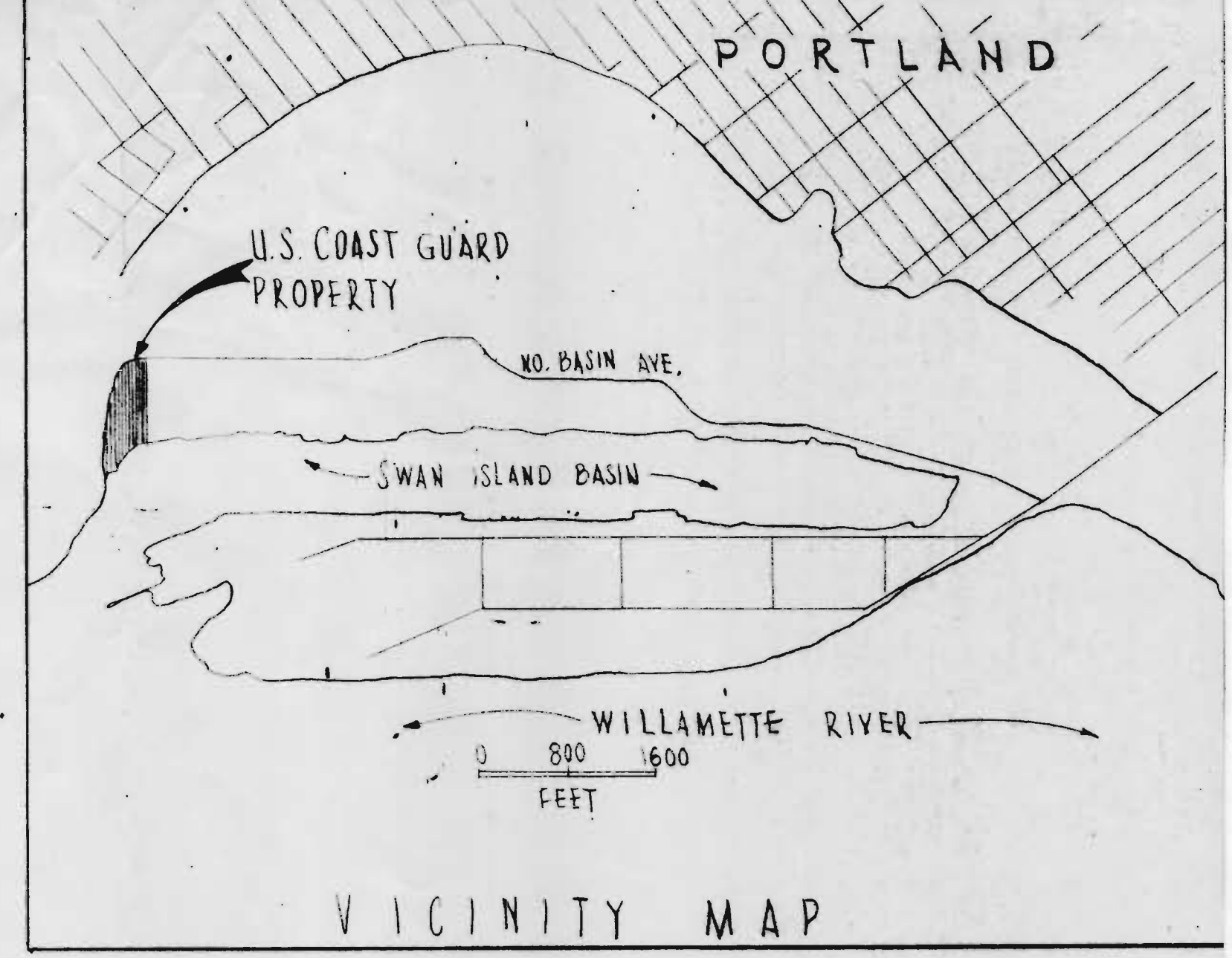

18 17

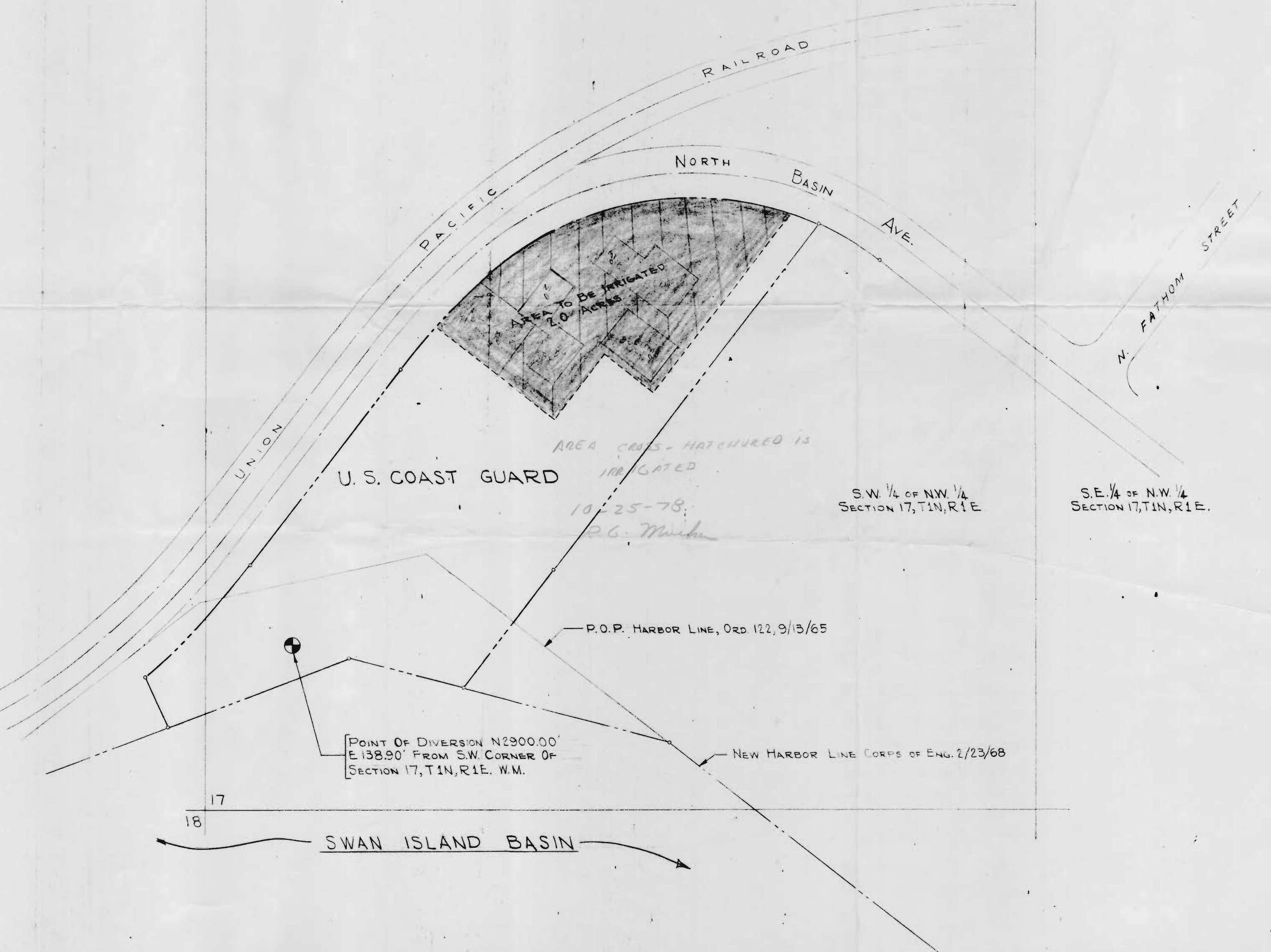

AREA TO BE IRRIGATED
2.0 ACRES

U. S. COAST GUARD

AREA CROSS-HATCHURED IS
IRRIGATED

10-25-78
P.G. M... ..

S.W. 1/4 OF N.W. 1/4
SECTION 17, T1N, R1E.

S.E. 1/4 OF N.W. 1/4
SECTION 17, T1N, R1E.

P.O.P. HARBOR LINE, ORD 122,9/13/65

NEW HARBOR LINE CORPS OF ENG. 2/23/68

POINT OF DIVERSION N2900.00'
E 138.90' FROM S.W. CORNER OF
SECTION 17, T1N, R1E. W.M.

SWAN ISLAND BASIN

Application No. 5262/
Error No. 37728

REV.	DATE	APPR.	DESCRIPTION	BY
DESIGNED:			U. S. COAST GUARD 13TH DISTRICT SEATTLE, WASHINGTON	
DRAWN:			CIVIL ENGINEERING	
TRACED:			PORTLAND STATION PORTLAND, OREGON	
CHECKED: G.H.			WATER PERMIT DRAWING	
REVIEWED BY:			APPROVED	
REVIEWED BY:			DATE	
REVIEWED BY:			10 JAN 1975	
REVIEWED BY:			U.S.C. CHIEF OF DIVISION	
CHIEF OF BRANCH			DRAWING NUMBER	
			107.7501	
			SCALE: 1" = 100'	
			SHEET 1 OF 1	