

Permit: S 37812
 Volume: 4A
 Strm: A SFR
 Trib: LIMPY CR
 Priority: 3/08/71

T.36 S., R.7 W., W.M.

RECEIVED
 APR 28 1982
 WM. DIST. 14
 GRANTS PASS, ORE

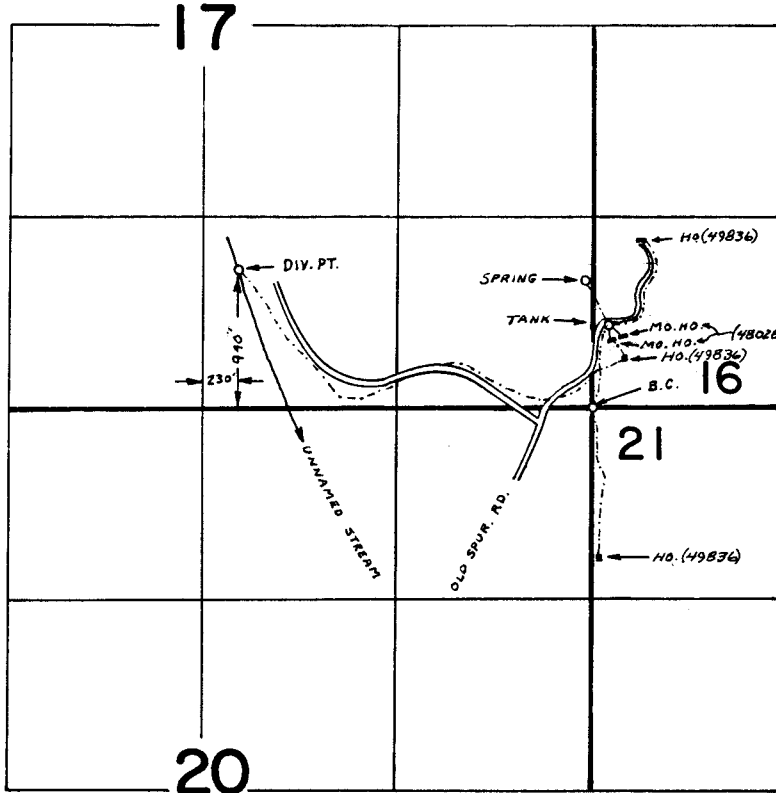

SPRING LOC.: 880' N. & 40' W. FROM SE COR. SEC. 17

FINAL PROOF SURVEY

UNDER

48028

37812

49836

37813

Application No. Permit No.
 IN NAME OF

WILLARD W. GRAHAM

Surveyed DEC. 7 77 by B. SUND
 19....., by

P.T.S. - 1977 - 14 - B