

T.36 S., R.7 W., W.M.

RECEIVED

OCT 8 1980

WM. DIST. 14
GRANTS PASS, ORE

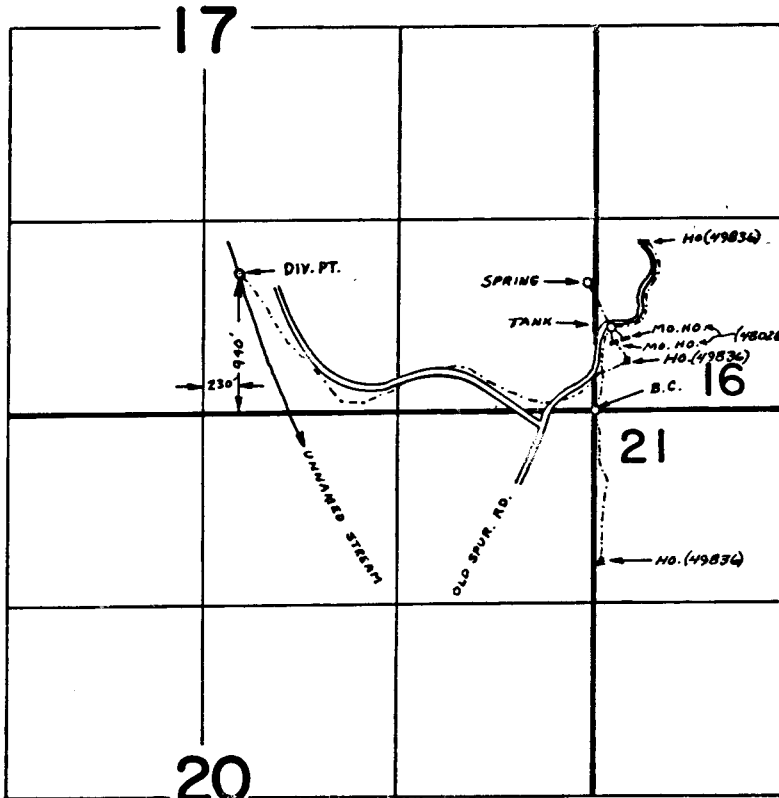

SPRING LOC.: 880' N. & 40' W. FROM SE COR. SEC. 17

FINAL PROOF SURVEY
UNDER

48028

37812

49836

37813 - Cont - 49541

Application No. Permit No.
IN NAME OF

WILLARD W. GRAHAM

Surveyed DEC. 7 77 by B. SUND
19.....

P.T.S. - 1977 - 14 - B